



3 P7 01

Sammanfattning av kommentarer till 3P70_01_00 Top Cucine Gas 70 2010.FH10

Sida: 1

 Nummer: 1 Författare: nina Ämne: Anteckning Datum: 2011-09-22 15:42:16
Ø75

10337198

 Nummer: 2 Författare: nina Ämne: Överstruket Datum: 2011-09-22 15:42:58

 Nummer: 3 Författare: nina Ämne: Överstruket Datum: 2011-09-22 15:47:28

 Nummer: 4 Författare: nina Ämne: Anteckning Datum: 2011-09-22 15:47:11
G120 = 320

525411

 Nummer: 5 Författare: nina Ämne: Överstruket Datum: 2011-09-22 15:43:38

 Nummer: 6 Författare: nina Ämne: Överstruket Datum: 2011-09-22 15:43:30

 Nummer: 7 Författare: nina Ämne: Anteckning Datum: 2011-09-22 15:41:51
G110 = 350

525711

NP70-10

TUTTAPIASTRA A GAS

GAS SOLID TOP

PLAQUES COUP-DE-FEU A GAZ

GASBEHEIZTE GLEHPLATTENHERDE

MOD.

NT78G

CR0598290

NT7FG8G

CR0598300

NT7FG12G

CR0598310

CM052300
(Ø 300 mm)

208111

CR0730330

(★)
NT7FG-8G

CR0587310

CR0587300

CR0585670



CR0580380

CM002900

□ 1421700 Ø 130

■ 2715300 Ø 150

○ CR0737210 Ø 235

● 795800 Ø 220

▲ 1631100 Ø 250

✦ 5152800 Ø 440

✦ 796000 Ø 480

1316400
(175 mm)

CR0736910

CM029100
(l = 850 mm)

CM040400

CM020409

CR0730290 (NT78)

CR0732430 (NT912)

CR0736900

1326500

86720

CM021700

1033700200

CR0584410
(NT78G)CR0587340
(NT7FG8G)CR0587350
(NT7FG12G)

CR0585540

9003088700

CR0580430 (Ø 10)

CR0731190
(NT78G)CR0587320
(NT7FG8G)CR0587330
(NT7FG12G)

CR0580460

CR0583980

15860399

1936400
L = 800 mm

1936100

CM136000
(+ CM136100)

CR0688810 ▶

◀ CR0688820
(NT7...)

CR0689030 ▶

◀ CR0689040
(NT7FG...)

CM029000

CM029100
(l = 850 mm)

1949900

1891700

673600

673500

1888400

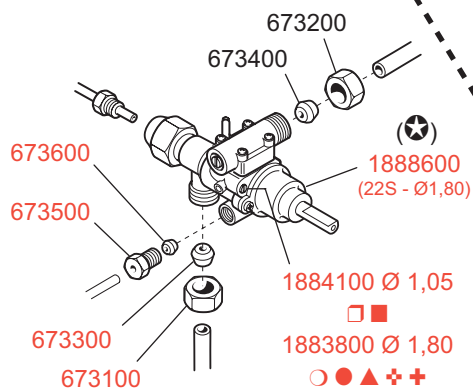

673200

673400

673600

673500

673300

673100

1888600
(22S - Ø1,80)

1884100 Ø 1,05

□ ■

1883800 Ø 1,80

○ ● ▲ ✦ ✦

1888000 Ø 14 □ ■

1887800 Ø 27 ○ ● ▲

1887900 Ø 50 ✦ ✦

ID GAS:

□ G30/50

■ G30/29

○ G20/20

● G25/25

▲ G25/20

✦ G120/8

✦ G110/8

MARENO INDUSTRIE ALI spa
Mareno di Piave (TV)

ELABORATO:

LZ

APPROVATO:

GRUPPO:

Serie Np70

DENOMINAZIONE:

Impianto gas e mobile

DATA:

01 Gen 2010

DATA:

01 Gen 2010

PARTICOLARE:

Disegno esploso
per ricambi

REV. N.

Z00

DEL

0110

DISEGNO N.

3.P7.05

SOST. DIS.



NP70-10

Mod.
NS78GS CR0599680
NS7FG8GS CR0599750

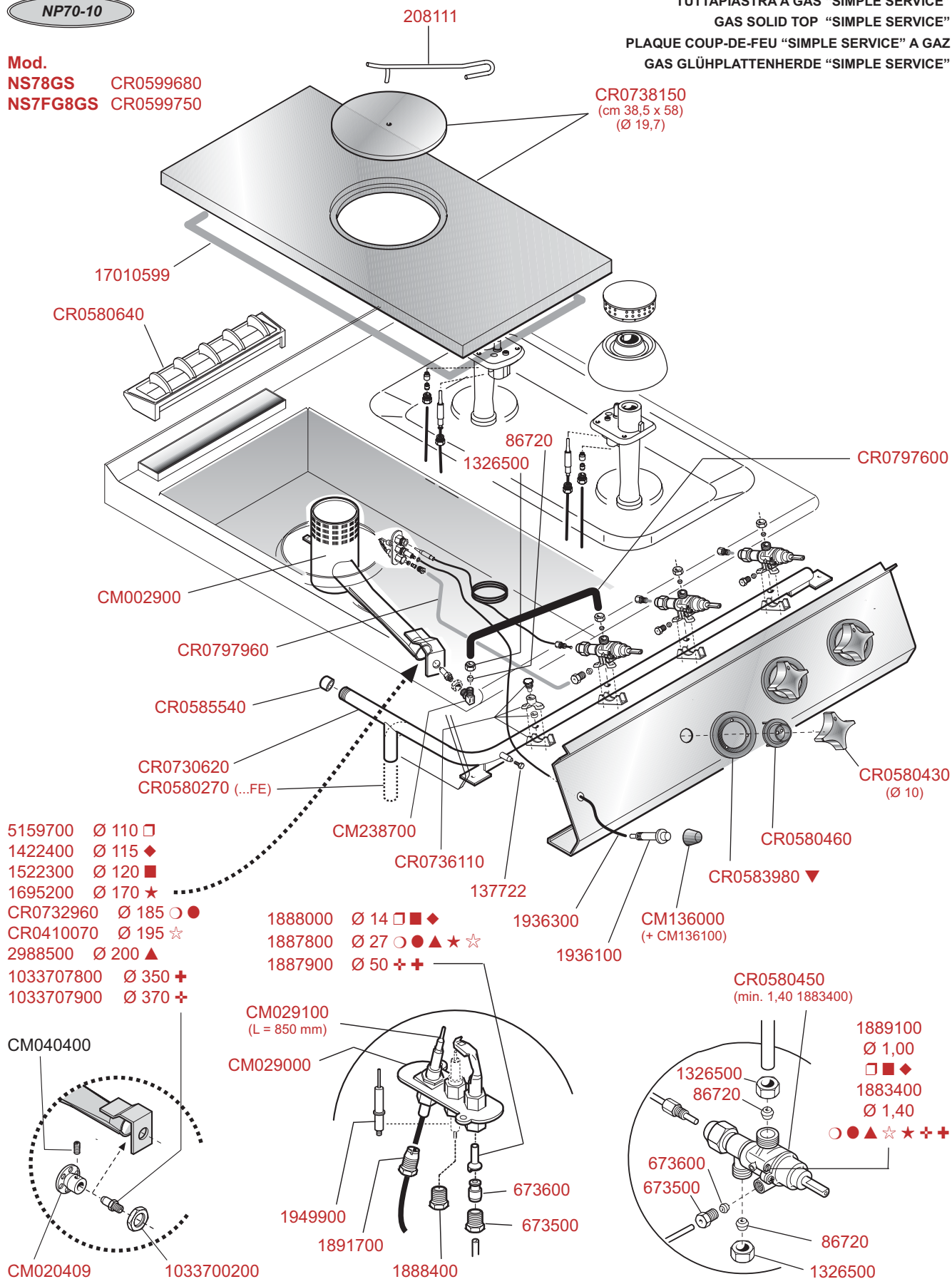
TUTTAPIASTRA A GAS "SIMPLE SERVICE"
GAS SOLID TOP "SIMPLE SERVICE"
PLAQUE COUP-DE-FEU "SIMPLE SERVICE" A GAZ
GAS GLÜHPLATTENHERDE "SIMPLE SERVICE"



ID GAS: □ G30/50 ■ G30/28+37 ◆ G30+31/37 ○ G20/20 ★ G20/25 ● G25/25 ☆ G25.1/25 ▲ G25/20 + G110/8 ++ G120/8

 MARENO INDUSTRIE ALI spa Mareno di Piave (TV)	ELABORATO:	APPROVATO:	GRUPPO:	DENOMINAZIONE:		
			Cucine Serie NP70	Impianto gas e mobile		
	DATA:	DATA:	PARTICOLARE:	REV. N.	DEL	DISEGNO N.
	11 Nov 2010	11 Nov 2010	Disegno esploso per ricambi	▼ Z00	▼ 1110	▼ 3.P.56
SOST. DIS.						

NP70-10



**FORNI A GAS
GAS OVENS
FOURS A GAZ
GAS BACKOFEN**

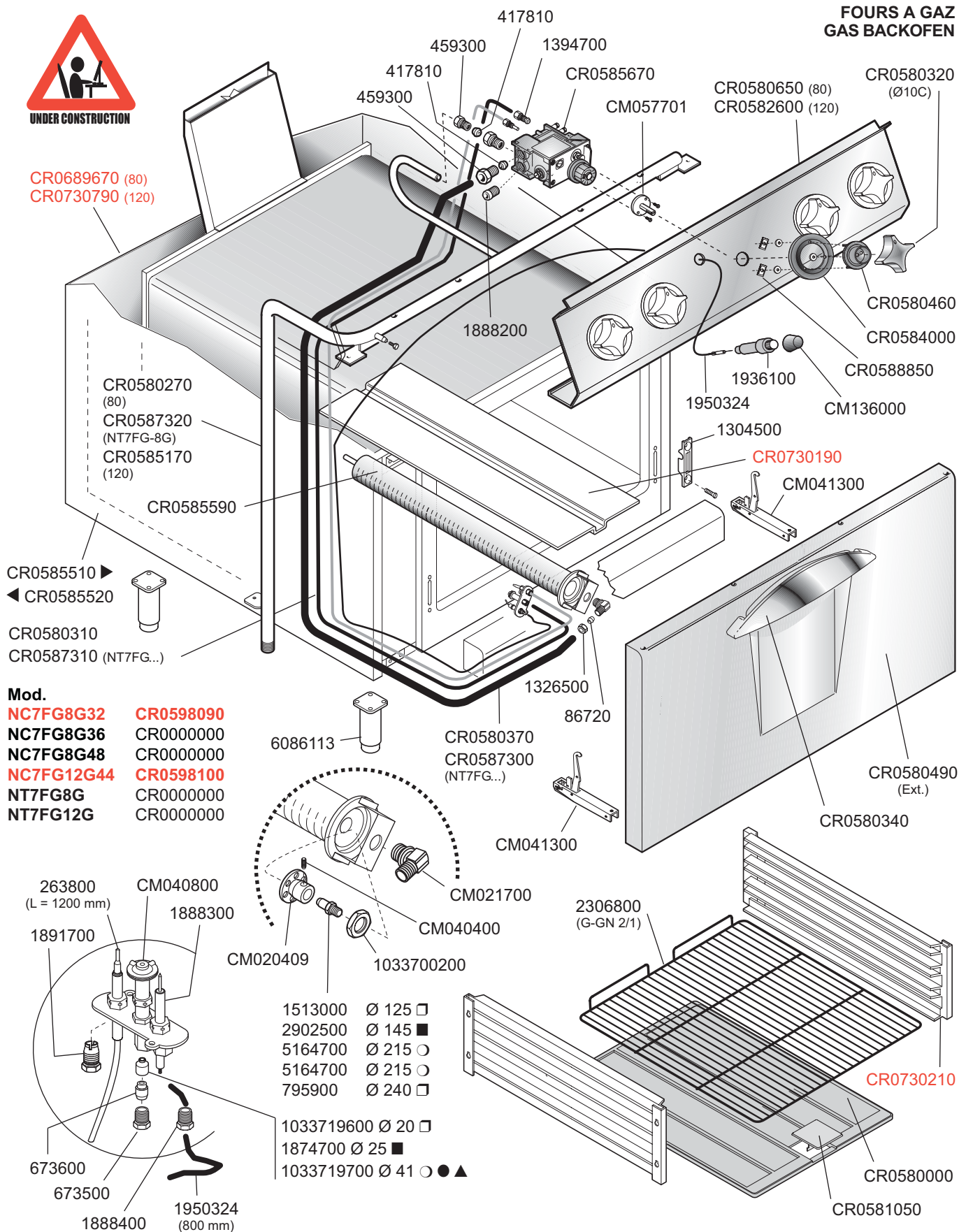

ID GAS: □ G30/50

■ G30/29

○ G20/20

● G25/25

▲ G25/20

✱ G120/8

✱ G110/8

 MARENO INDUSTRIE ALI spa Mareno di Piave - TV	ELABORATO:	APPROVATO:	GRUPPO:	DENOMINAZIONE:		
	BZ		Forno Serie NP70	Impianto gas e mobile		
	DATA:	DATA:	PARTICOLARE:	REV. N.	DEL	DISEGNO N.
	28 Gen 2010	28 Gen 2010	Disegno esploso per ricambi	▼ Z00	▼ 0110	▼ 3.P7.02
SOST. DIS.						



NP70-10

**FORNO A GAS MAXI
GAS MAXI OVEN
MAXI FOUR A GAZ
"MAXI" GAS BACKOFEN**

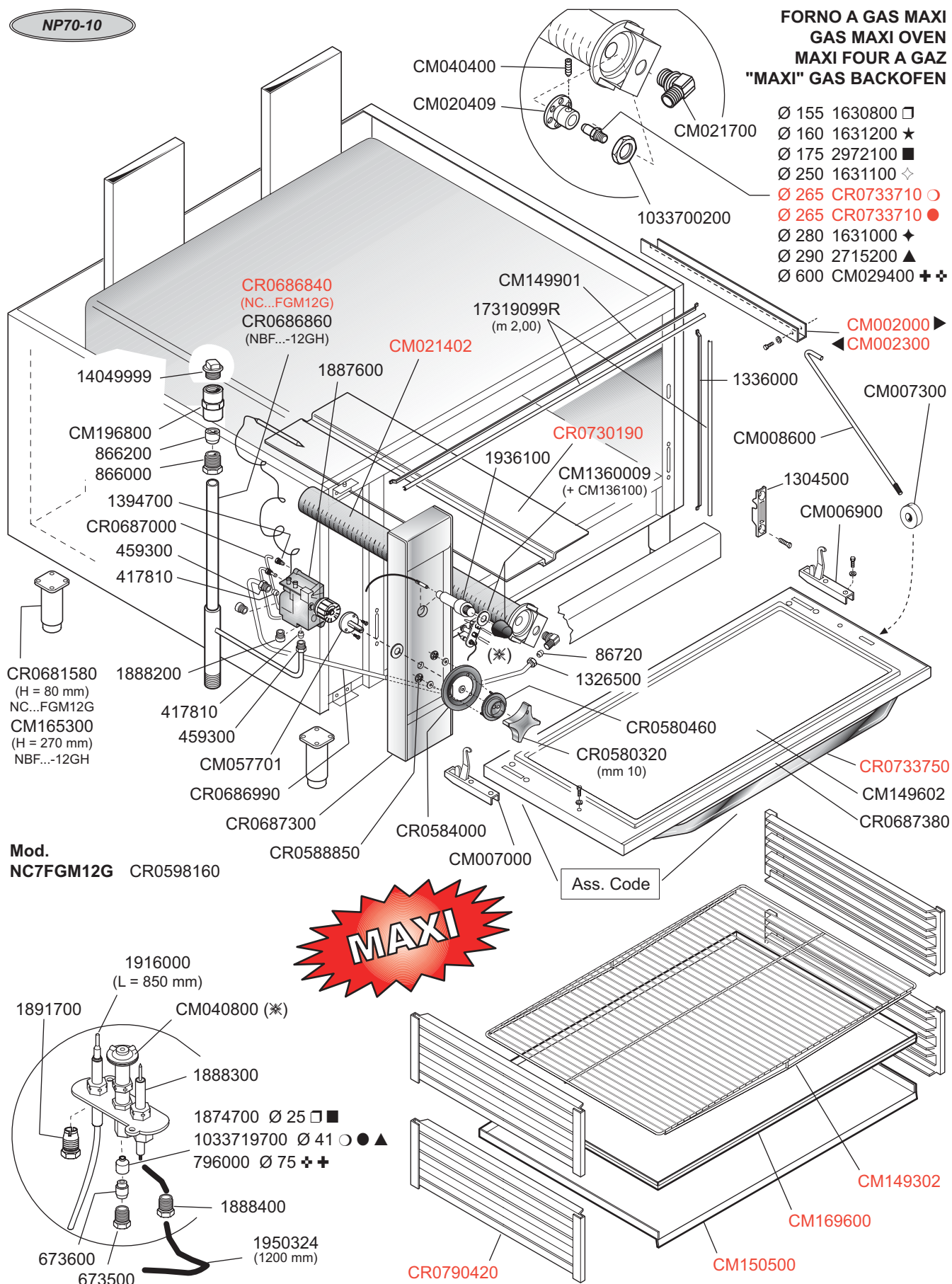
Ø 155 1630800 □
 Ø 160 1631200 ★
 Ø 175 2972100 ■
 Ø 250 1631100 ◇
 Ø 265 CR0733710 ○
 Ø 265 CR0733710 ●
 Ø 280 1631000 ✦
 Ø 290 2715200 ▲
 Ø 600 CM029400 ✚ ✛



ID GAS: □ G30/50 ★ G30.31/37 ■ G30/29 ○ G20/20 ◇ G20/25 ● G25/25 ✦ G25.1/25 ▲ G25/20 ✚ G120/8 ✛ G110/8

 MARENO INDUSTRIE ALI spa Mareno di Piave (TV)	ELABORATO:	APPROVATO:	GRUPPO:	DENOMINAZIONE:		
			Serie forno MAXI NP70	Impianto gas e mobile		
	DATA:	DATA:	PARTICOLARE:	REV. N.	DEL	DISEGNO N.
	15 Feb 2010	15 Feb 2010	Disegno esploso per ricambi	▼ Z00	▼ 0210	▼ 3.P7.47
	SOST. DIS.					

NP70-10

DIRECT

NFT74GL
NFT74GR
NFT76GL
NFT76GM
NFT76GR

CR0689750
CR0733400
CR0738170
CR0738180
CR0738210

NFT78GL
NFT78GR
NFT78GM

CR0689770
CR0733960
CR0734210

FRY TOPS A GAS
GAS-HEATED FRY-TOPS
GRILLADES A GAZ
GASBEHEIZTE BRAT- UND GRILLPLATTEN

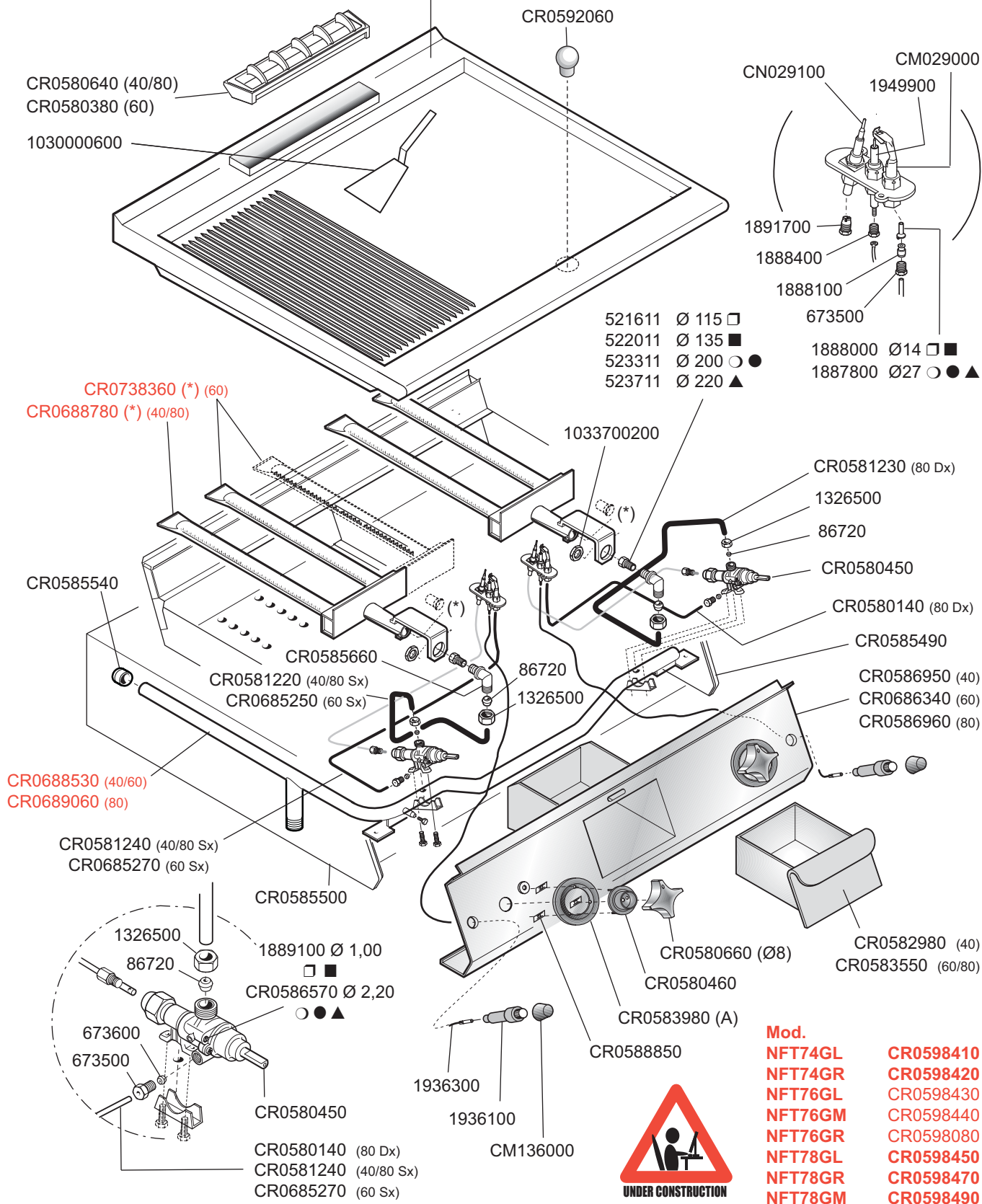

ID GAS:



□ G30/50

■ G30/29

○ G20/20

● G25/25

▲ G25/20

 MARENO INDUSTRIE ALI spa Mareno di Piave (TV)	ELABORATO:	APPROVATO:	GRUPPO:	DENOMINAZIONE:		
			Serie NP70	Impianto gas risc. diretto e mobile		
	DATA:	DATA:	PARTICOLARE:	REV. N.	DEL	DISEGNO N.
	28 Gen 2010	28 Gen 2010	Disegno esploso per ricambi	▼ Z00	▼ 0110	▼ 3.P7.11.DIR
SOST. DIS.						

NP70-10
THERMOSTAT

NFT76GLC CR0738190
NFT76GMC CR0738200
NFT76GRC CR0738240

NFT78GTL CR0689770
NFT78GTM CR0734210
NFT78GTR CR0733960
NFT78GTLC CR0689780
NFT78GTLO CR0734230
NFT78GTLCO CR0734680
NFT78GTMC CR0734220
NFT78GTRC CR0689970

FRY TOPS A GAS
GAS-HEATED FRY-TOPS
GRILLADES A GAZ
GASBEHEIZTE BRAT- UND GRILLPLATTEN

NFT74GTLC CR0689760
NFT74GTLO CR0734240
NFT74GTLCO CR0734690
NFT74GTRC CR0689650

CR0580640 (40/80)
CR0580380 (60)
1030000600

CR0592060

CR0687180 (40/80)
CR0791990 (60)

1950100
CM029000
1949900

1891700
1888400
1888100
673500

1888000 Ø14 □
1887800 Ø27 ○ ● ▲

CR0738360 (*) (60)
CR0688780 (*) (40/80)

1033700200

CR0583840 (80 Dx)

522111 Ø 140 □
522511 Ø 160 ■
524111 Ø 240 ○ ●
524711 Ø 270 ▲

1878500

CR0585490

CR0583830 (40/80 Sx)
CR0685230 (60 Sx)

CR0585660
86720
1326500

CR0586950 (40)
CR0686340 (60)
CR0586960 (80)

CR0585540

CR0688540 (40/60)
CR0689070 (80)

CR0587280 (40/80 Sx)
CR0587290 (80 Dx)
CR0685260 (60 Sx)

1394700
CR0585500

CR0582980 (40)
CR0583550 (60/80)

1888200
417810
459300

417810
459300
CR0585670
CM057701

1936300

CM136000

CR0588850

CR0580460

CR0585150

Mod.



NFT74GTLC CR0598510
NFT74GTRC CR0598560
NFT74GTLO CR0599010
NFT78GTL CR0598460
NFT78GTR CR0598480
NFT78GTM CR0598500
NFT78GTLO CR0599020
NFT78GTLC CR0598540
NFT78GTMC CR0598550

Mod.

NFT76GTLC CR0598520
NFT76GTMC CR0598530



ID GAS: □ G30/50 ■ G30/29 ○ G20/20 ● G25/25 ▲ G25/20

 MARENO INDUSTRIE ALI spa Mareno di Piave (TV)	ELABORATO:	APPROVATO:	GRUPPO:	DENOMINAZIONE:		
			Serie NP70	Impianto gas termostatico e mobile		
	DATA:	DATA:	PARTICOLARE:	REV. N.	DEL	DISEGNO N.
	28 Gen 2010	28 Gen 2010	Disegno esploso per ricambi	▼ Z00	▼ 0110	▼ 3.P7.11.TER





NP70-10

BRASIERE A GAS ROVESCIBILI
GAS HEATED TILTING BRATT PANS
SAUTEUSES BASCULANTES A GAZ
GASBEHEIZT KIPPBRATPFANNEN

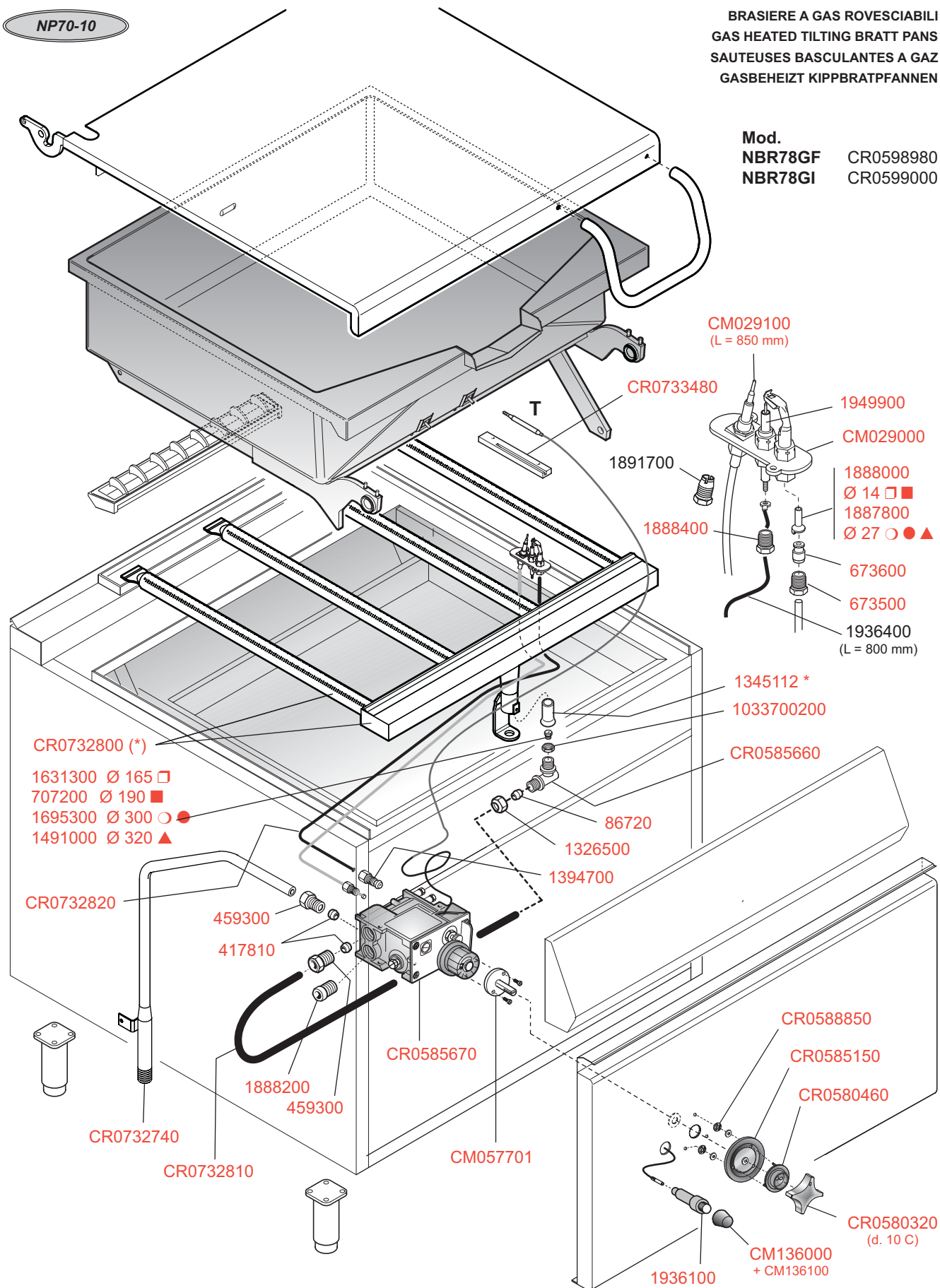
Mod.
NBR78GF CR0598980
NBR78GI CR0599000



□ G30/50 ■ G30/29 ○ G20/20 ● G25/25 △ G25/20 ▲ G110/8 ◎ G120/8 ● G140/8

 MARENO INDUSTRIE ALI spa Mareno di Piave (TV)	ELABORATO:	APPROVATO:	GRUPPO:	DENOMINAZIONE:		
			Serie NP70	Impianto gas		
	DATA:	DATA:	PARTICOLARE:	REV. N.	DEL	DISEGNO N.
	26 Mar 2010	26 Mar 2010	Disegno esploso per ricambi	▼ Z00	▼ 0310	▼ 3.P70.28
	SOST. DIS.					

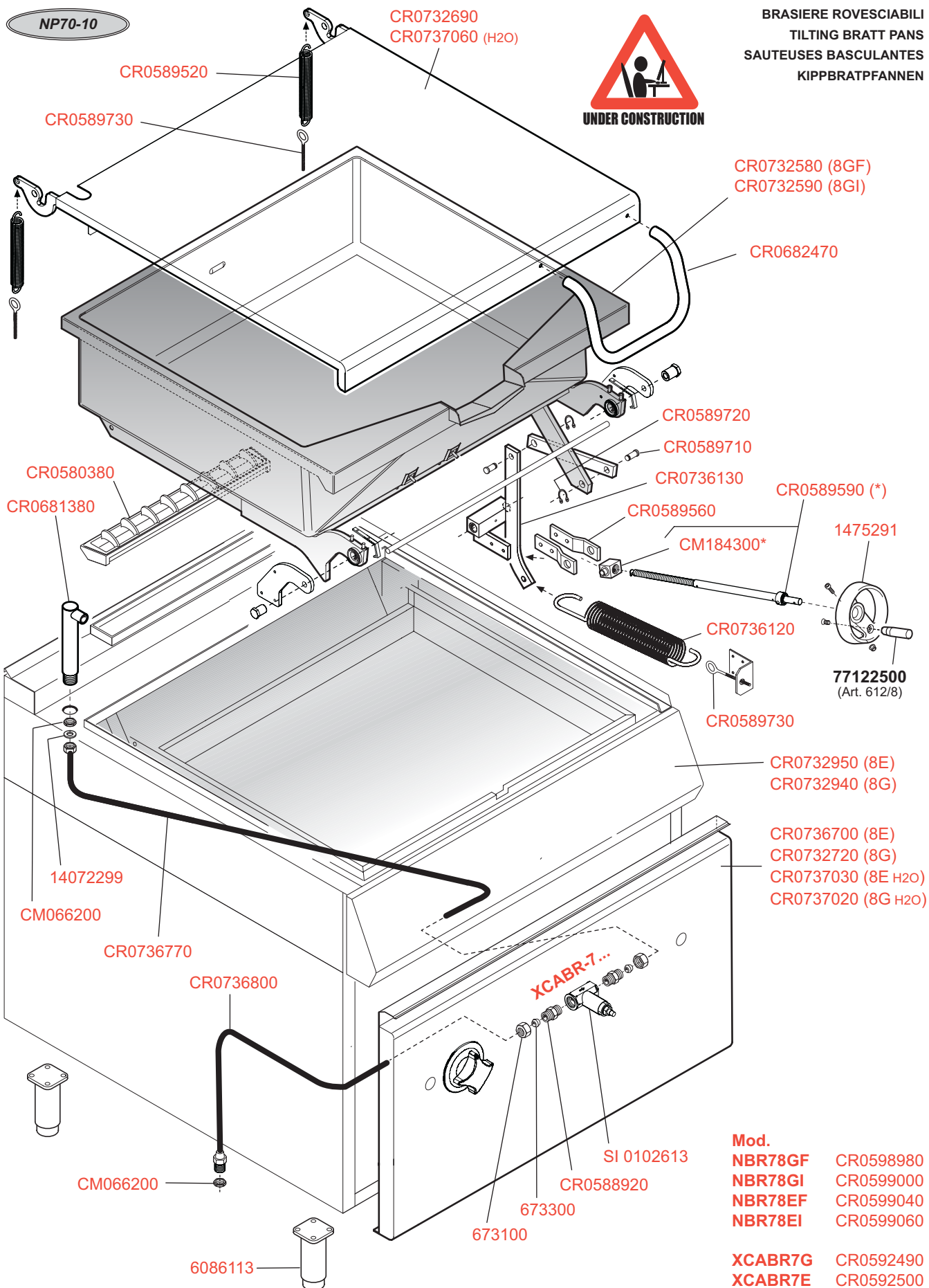

 MARENO INDUSTRIE ALI spa Mareno di Piave (TV)	ELABORATO:	APPROVATO:	GRUPPO:	DENOMINAZIONE:		
	LZ		Serie NP70	Mobile, Sistema idraulico e Movimento vasca		
	DATA:	DATA:	PARTICOLARE:	REV. N.	DEL	DISEGNO N.
	26 Mar 2010	26 Mar 2010	Disegno esploso per ricambi	Z00	0310	3.P70.18

NP70-10



MOD.

NG74G

NG78G

CR0598690

CR0598700

GRIGLIA A GAS
GAS HEATED GRILLS
GRILLADES A GAZ
GASBEHEIZTE GRILL

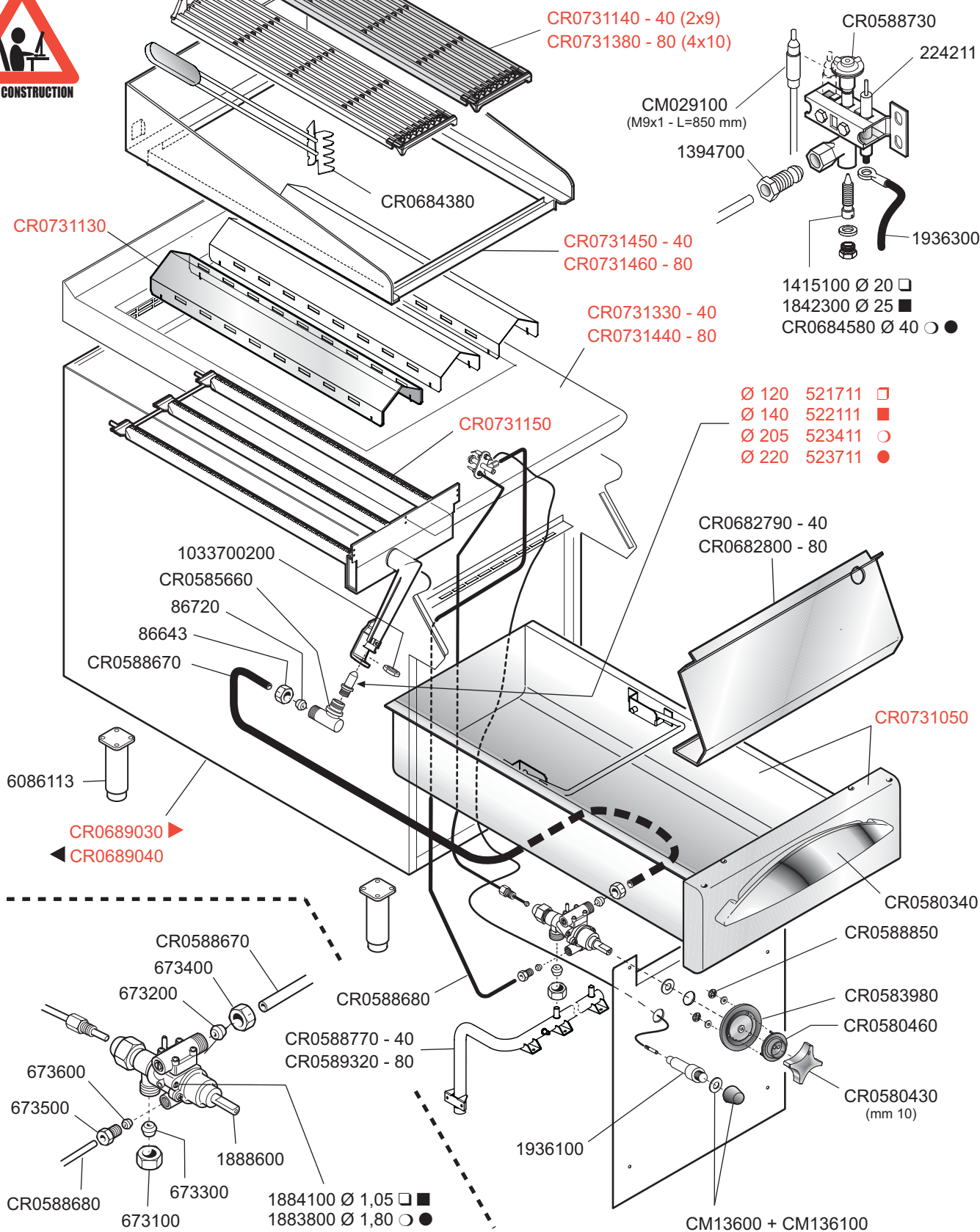

ID GAS:

□ G30/50

■ G30/29

○ G20/20

● G25/25

▲ G25/20

✚ G120/8

✚ G110/8

 MARENO INDUSTRIE ALI spa Mareno di Piave (TV)	ELABORATO:	APPROVATO:	GRUPPO:	DENOMINAZIONE:		
			Serie NP70	Impianto gas e mobile		
	DATA:	DATA:	PARTICOLARE:	REV. N.	DEL	DISEGNO N.
	11 Feb 2010	11 Feb 2010	Disegno esploso per ricambi	Z00	0210	3.P7.37
SOST. DIS.						

NP70-10

Mod.

NGPL74G CR0599480

NGPL78G CR0599490

GRIGLIA BISTECCHIERA (A PIETRA LAVICA) A GAS
GAS HEATED CHAR GRILLS
GRILLADE CHARCOAL A GAZ
GASBEHEIZT GLÜHSTEINGERAT

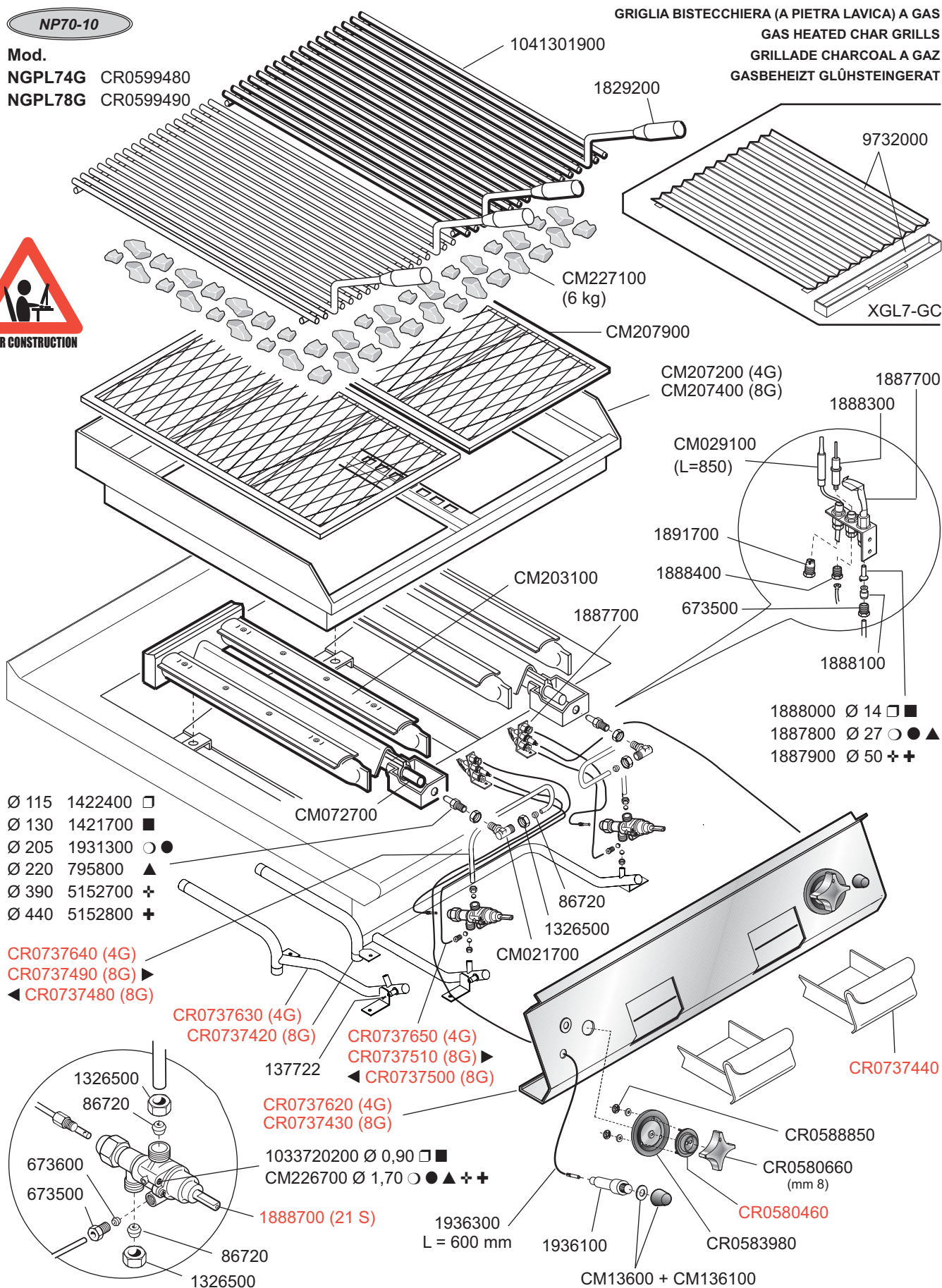

ID GAS: □ G30/50 ■ G30/29 ○ G20/20 ● G25/25 ▲ G25/20 + G120/8 + G110/8				
 MARENO INDUSTRIE ALI spa Mareno di Piave (TV)	ELABORATO:	APPROVATO:	GRUPPO:	DENOMINAZIONE:
			Serie NP70	Impianto gas e mobile
	DATA:	DATA:	PARTICOLARE:	REV. N. DEL DISEGNO N.
	11 Feb 2010	11 Feb 2010	Disegno esploso per ricambi	Z00 0210 3.P7.38
SOST. DIS.				

NP70-10



CUOCIPASTA A GAS
GAS-HEATED PASTA COOKERS
CUISEUR A PATES A GAZ
GASBEHEIZTE TEIGWARENKOCHER

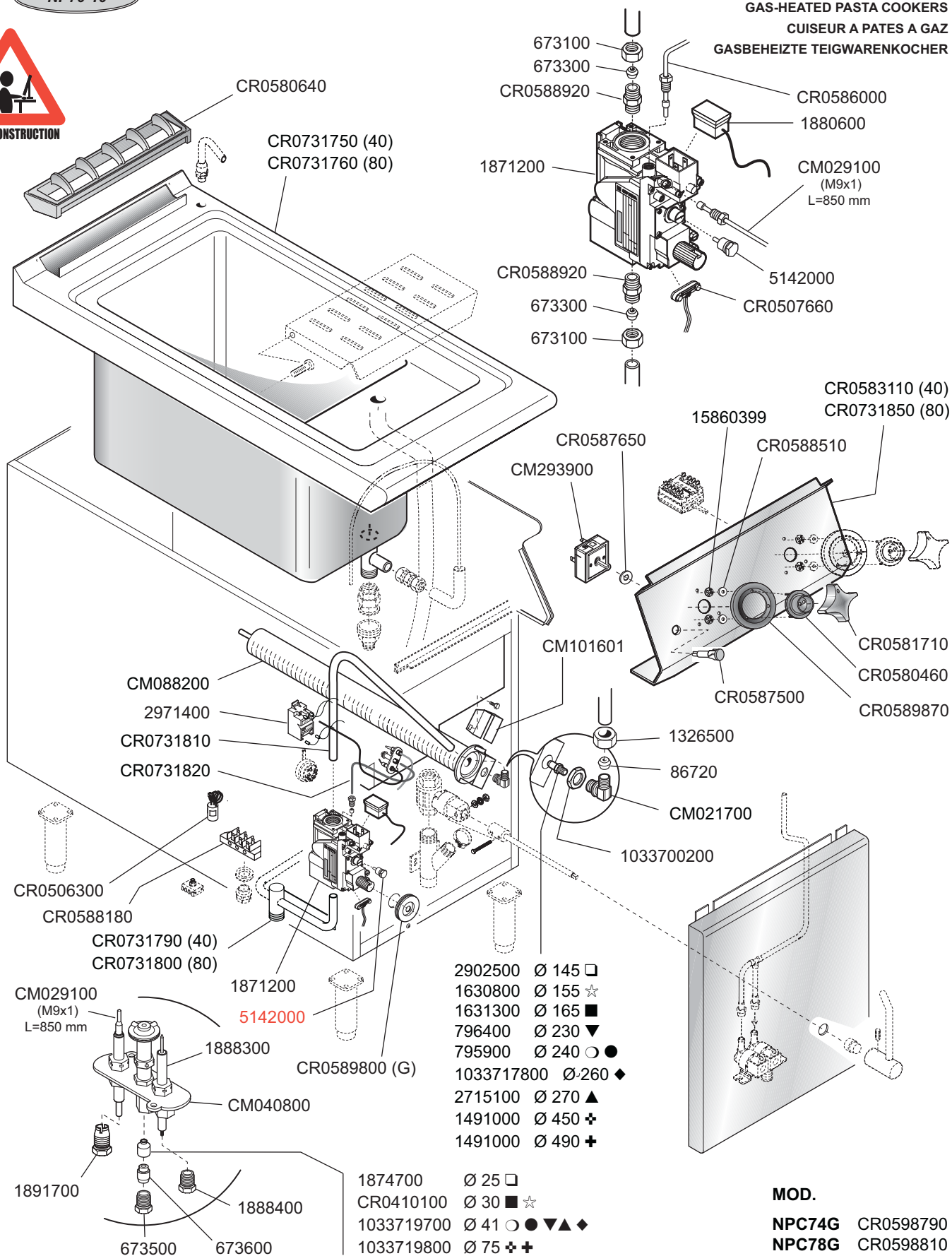

MOD.

NPC74G CR0598790
NPC78G CR0598810

ID GAS: □ G30/50 ☆ G30/37 ■ G30/29 ○ G20/20 ▼ G20/25 ● G25/25 ◆ G25.1/25 ▲ G25/20 ✚ G120/8 ✚ G110/8

 MARENO INDUSTRIE ALI spa Mareno di Piave (TV)	ELABORATO:	APPROVATO:	GRUPPO:	DENOMINAZIONE:		
	LZ		Serie NP70	Impianto gas		
	DATA:	DATA:	PARTICOLARE:	REV. N.	DEL	DISEGNO N.
	05 Feb 2010	05 Feb 2010	Disegno esploso per ricambi	▼	▼	▼
SOST. DIS.				Z00	0110	3.P7.09

NP70-10

CUOCIPASTA A GAS
GAS-HEATED PASTA COOKERS
CUISEUR A PATES A GAZ
GASBEHEIZTE TEIGWARENKOCHER

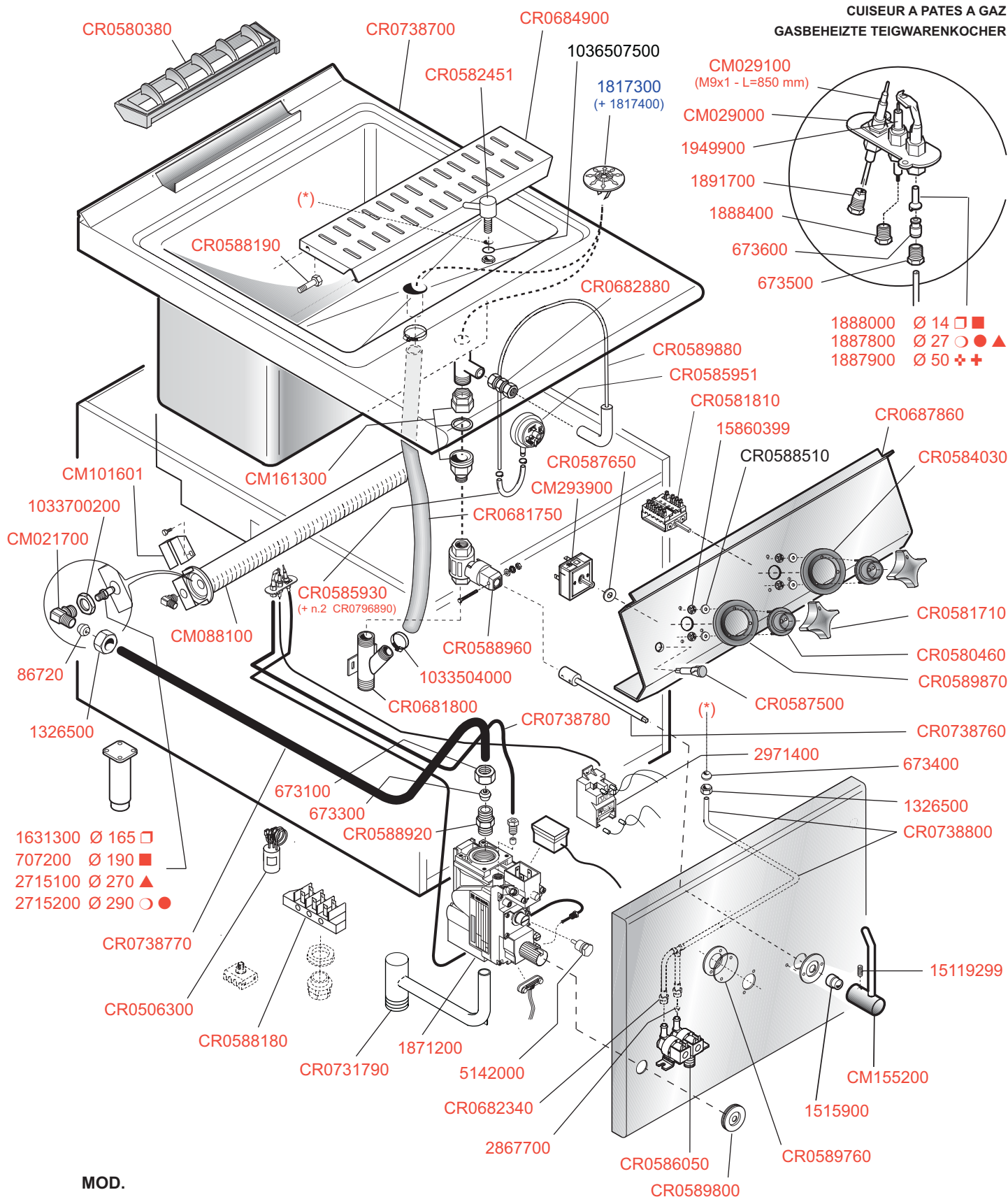

MOD.

NPC76G CR0598800

ID GAS:		□ G30/50	■ G30/29	○ G20/20	● G25/25	▲ G25/20	+ G120/8	+ G110/8
 MARENO INDUSTRIE ALI spa Mareno di Piave (TV)	ELABORATO:	APPROVATO:		GRUPPO:		DENOMINAZIONE:		
	DATA:	DATA:		PARTICOLARE:		REV. N.	DEL	DISEGNO N.
	27 Lug 2010	27 Lug 2010		Disegno esploso per ricambi		▼	▼	▼
	SOST. DIS.					Z00	0710	3.P7.43

NP70-10

CR0580380

PENTOLE DA LITRI 50 - RISCALDAMENTO DIRETTO A GAS

GAS DIRECT HEATED BOILING PANS

MARMITES A GAZ CHAUFFE DIRECTE

DIREKTBEHEIZT GAS KOCHKESSEL



Mod.

NPD76G5 CR0598850

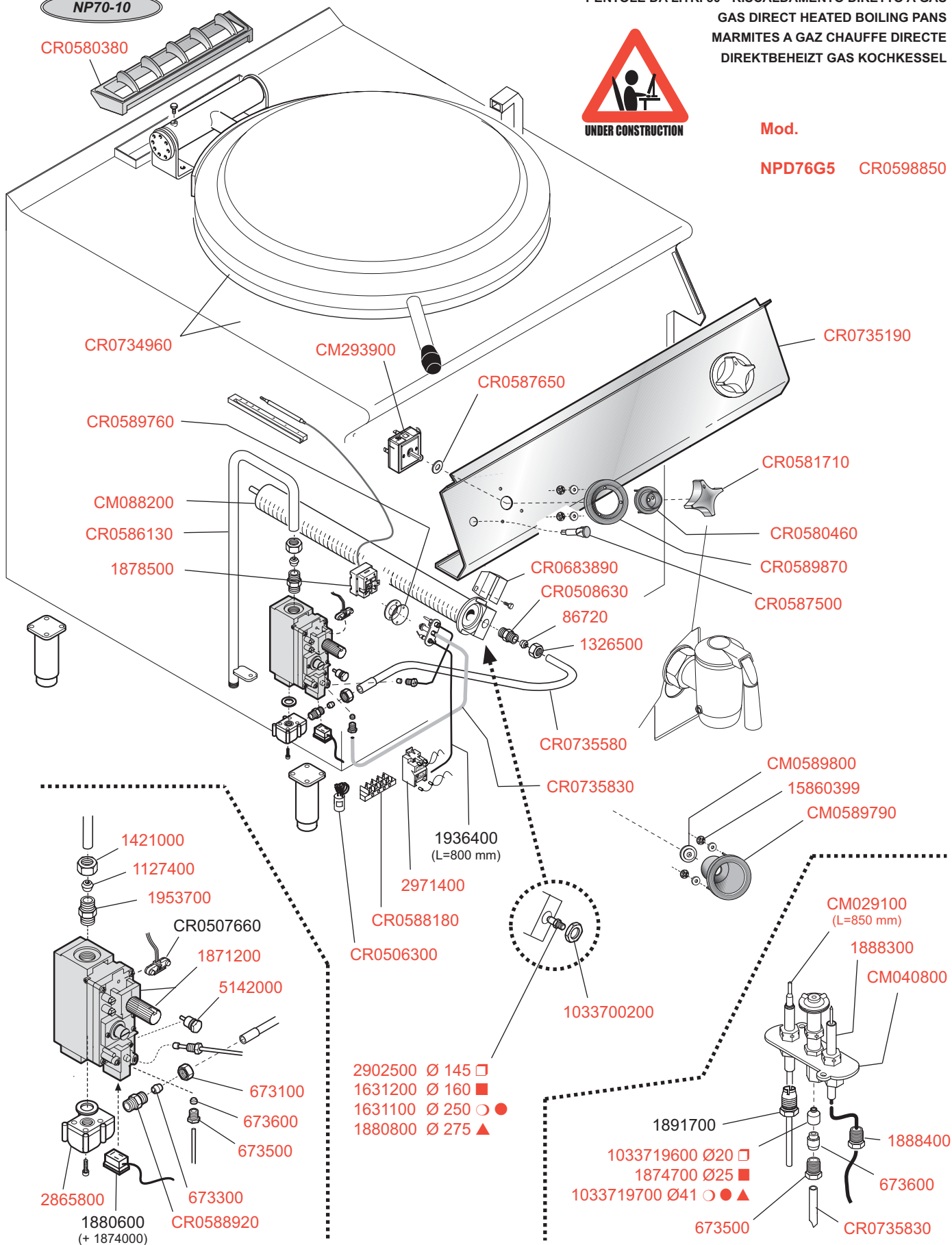

ID GAS:

□ G30/50

■ G30/29

○ G20/20

● G25/25

▲ G25/20

✚ G120/8

✚ G110/8

 MARENO INDUSTRIE ALI spa Mareno di Piave (TV)	ELABORATO:	APPROVATO:	GRUPPO:	DENOMINAZIONE:		
			Serie NP70	Impianto gas		
	DATA:	DATA:	PARTICOLARE:	REV. N.	DEL	DISEGNO N.
	23 Mar 2010	23 Mar 2010	Disegno esploso per ricambi	▼ Z00	▼ 0310	▼ 3.P70.23



Np70-10



PENTOLE DA LITRI 50 - RISCALDAMENTO INDIRETTO A GAS
GAS HEATED (JACKETED) BOILING PANS
MARMITES A GAZ CHAUFFE INDIRECTE
DOPPELWANDIGE AUSF. - GASBEHEIZT KOCHKESSEL

Mod.

NPI76G5 CR0598890

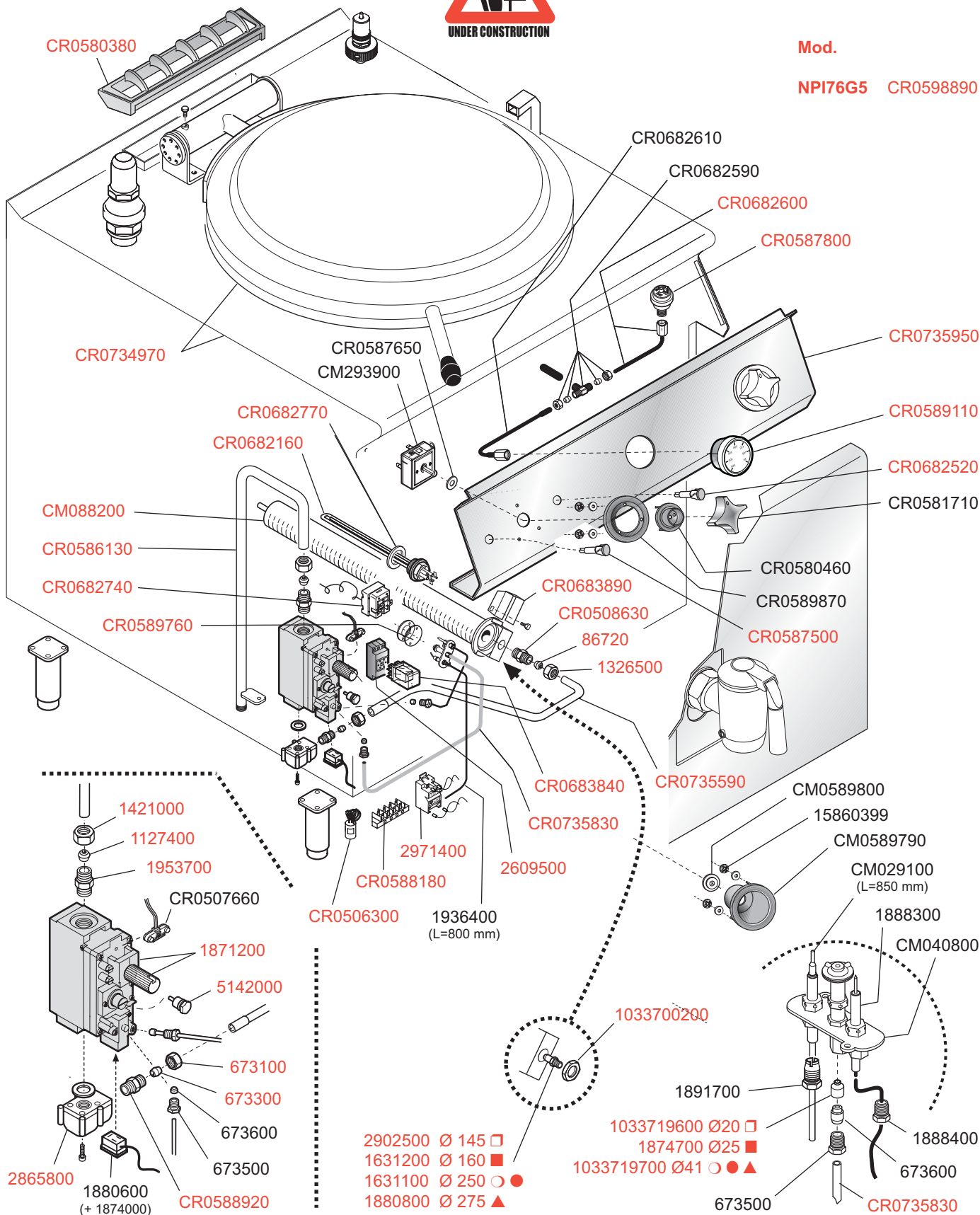

□ G30/50 ■ G30/29 ○ G20/20 ● G25/25 △ G25/20 ▲ G110/8 ◎ G120/8 ● G140/8

 MARENO INDUSTRIE ALI spa Mareno di Piave (TV)	ELABORATO:	APPROVATO:	GRUPPO:	DENOMINAZIONE:		
			Serie NP70	Impianto gas		
	DATA:	DATA:	PARTICOLARE:	REV. N.	DEL	DISEGNO N.
	23 Mar 2010	23 Mar 2010	Disegno esploso per ricambi	▼ Z00	▼ 0310	▼ 3.P70.24
	SOST. DIS.					

NP70-10

PENTOLE A GAS ED ELETTRICHE 50 LITRI
 GAS AND ELECTRIC HEATED BOILING PANS 50 LITERS
 MARMITES A GAZ ET ELECTRIQUES 50 LITRES
 GAS UND ELEKTROBEHEIZT KOCHKESSEL 50 LITERS

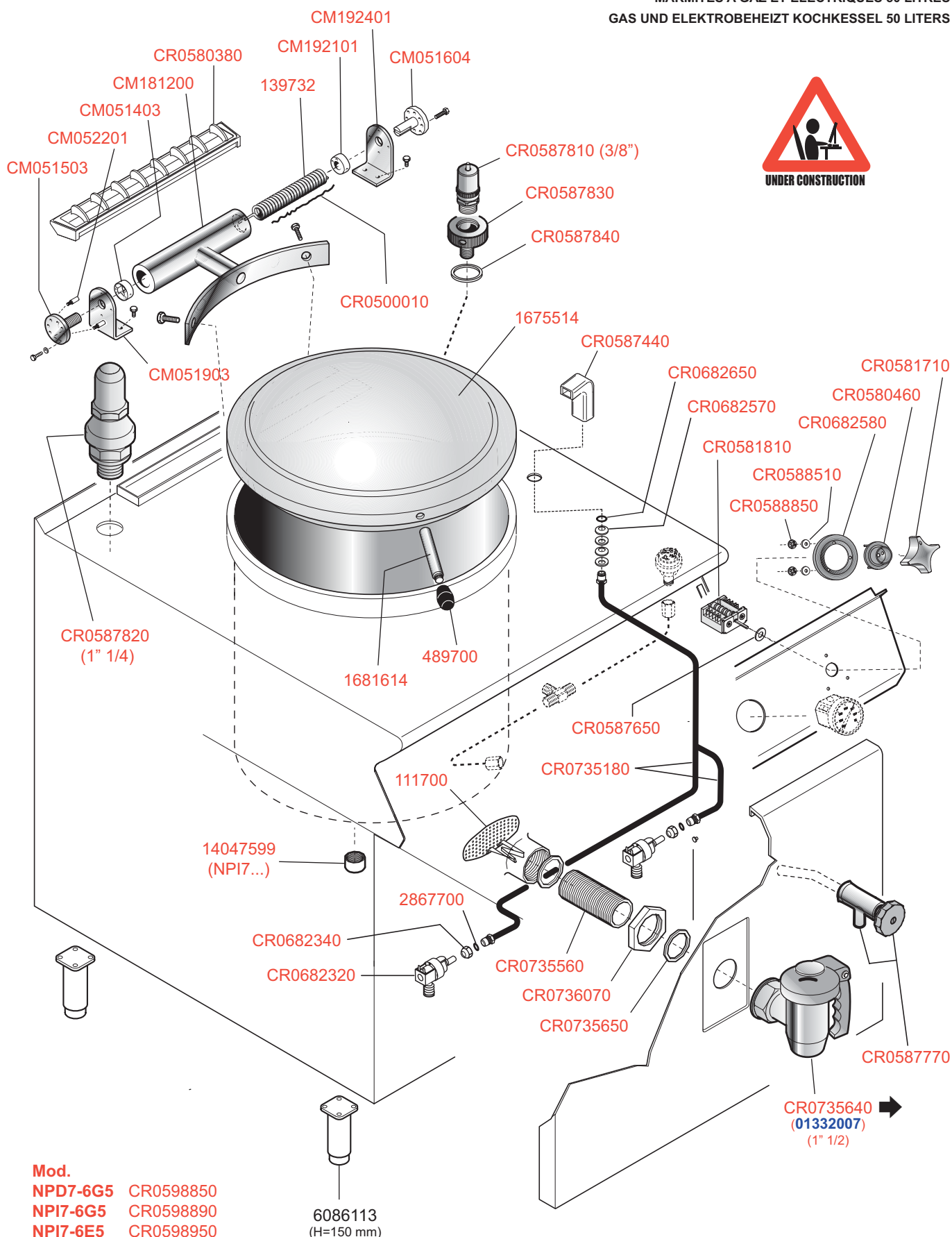

Mod.
 NPD7-6G5 CR0598850
 NPI7-6G5 CR0598890
 NPI7-6E5 CR0598950

6086113
 (H=150 mm)

 MARENO INDUSTRIE ALI spa Mareno di Piave (TV)	ELABORATO:	APPROVATO:	GRUPPO:	DENOMINAZIONE:		
			Serie NP70	Impianto idraulico e mobile - Particolari comuni		
	DATA:	DATA:	PARTICOLARE:	REV. N.	DEL	DISEGNO N.
	21 Mar 2010	21 Mar 2010	Disegno esploso per ricambi	Z00	0310	3.P70.20/1
	SOST. DIS.					

NP70-10



PENTOLE DA LITRI 80 - RISCALDAMENTO DIRETTO A GAS
 GAS DIRECT HEATED BOILING PANS
 MARMITES A GAZ CHAUFFE DIRECTE
 GAS DIREKTBEHEIZT KOCHKESSEL

Mod.
 NPD78G8 CR0598960

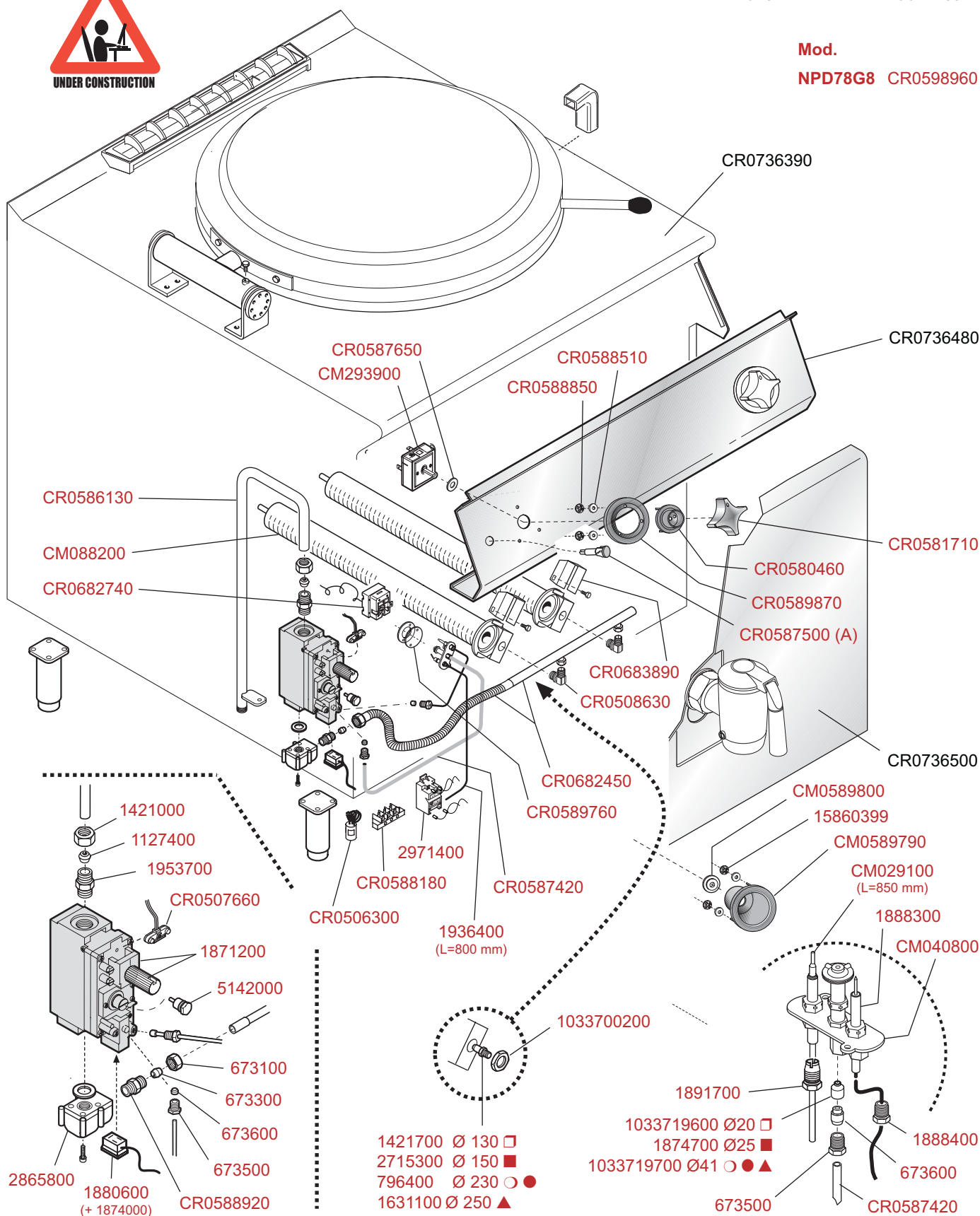

□ G30/50

■ G30/29

○ G20/20

● G25/25

△ G25/20

▲ G110/8

◎ G120/8

● G140/8

 MARENO INDUSTRIE ALI spa Mareno di Piave (TV)	ELABORATO:	APPROVATO:	GRUPPO:	DENOMINAZIONE:		
			Serie NP70	Impianto gas		
	DATA:	DATA:	PARTICOLARE:	REV. N.	DEL	DISEGNO N.
	23 Nov 2010	23 Nov 2010	Disegno esploso per ricambi	▼ Z00	▼ 1110	▼ 3.P70.71
	SOST. DIS.					

NP70-10



PENTOLE DA LITRI 80 - RISCALDAMENTO INDIRETTO A GAS
GAS HEATED (JACKETED) BOILING PANS
MARMITES A GAZ CHAUFFE INDIRECTE
DOPPELWANDIGE AUSF. - GASBEHEIZT KOCHKESSEL

Mod.
NPI78G8 CR0598970

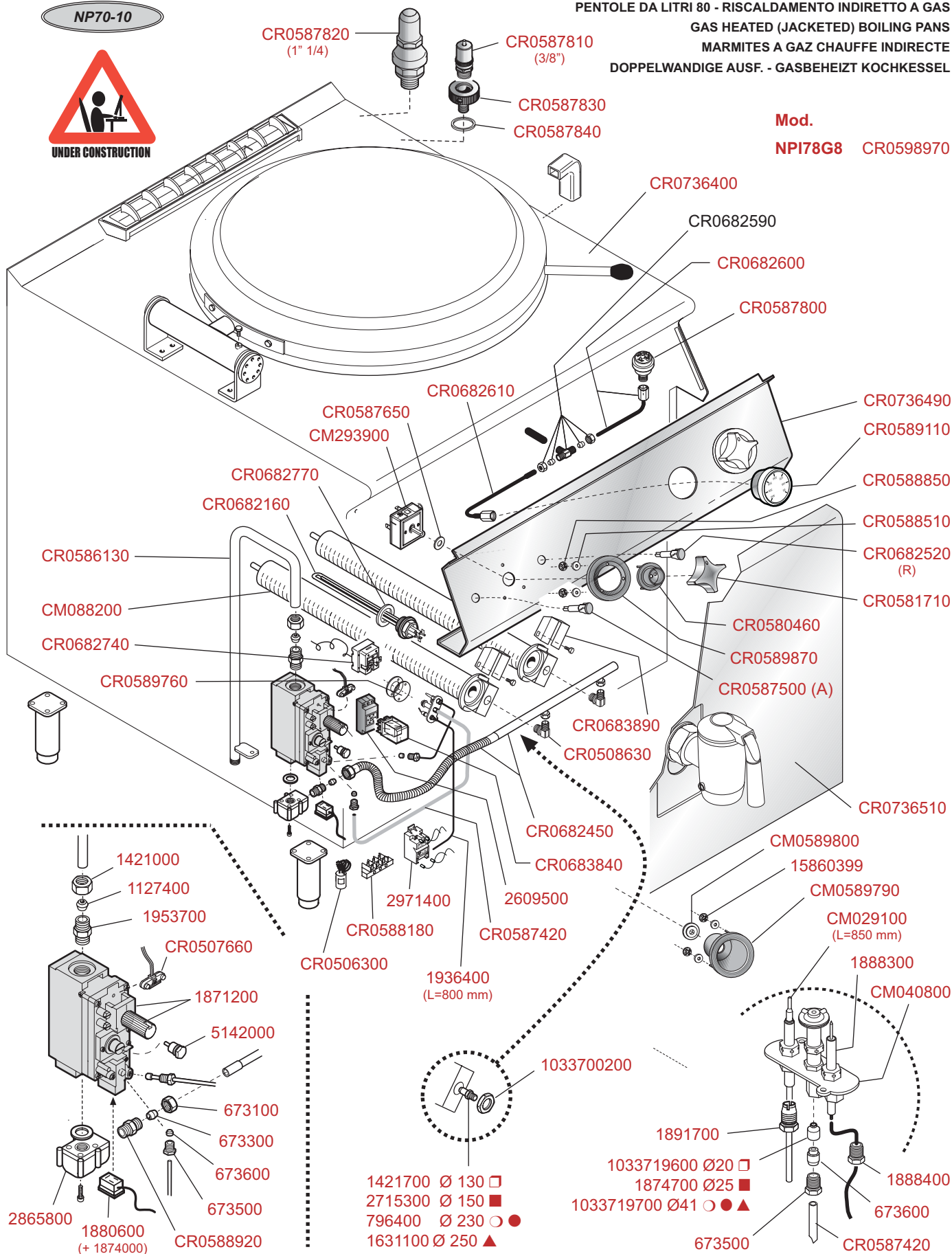

□ G30/50 ■ G30/29 ○ G20/20 ● G25/25 △ G25/20 ▲ G110/8 ◎ G120/8 ● G140/8

 MARENO INDUSTRIE ALI spa Mareno di Piave (TV)	ELABORATO:	APPROVATO:	GRUPPO:	DENOMINAZIONE:		
			Serie NP70	Impianto gas		
	DATA:	DATA:	PARTICOLARE:	REV. N.	DEL	DISEGNO N.
	23 Nov 2010	23 Nov 2010	Disegno esploso per ricambi	▼ Z00	▼ 1110	▼ 3.P70.72
	SOST. DIS.					

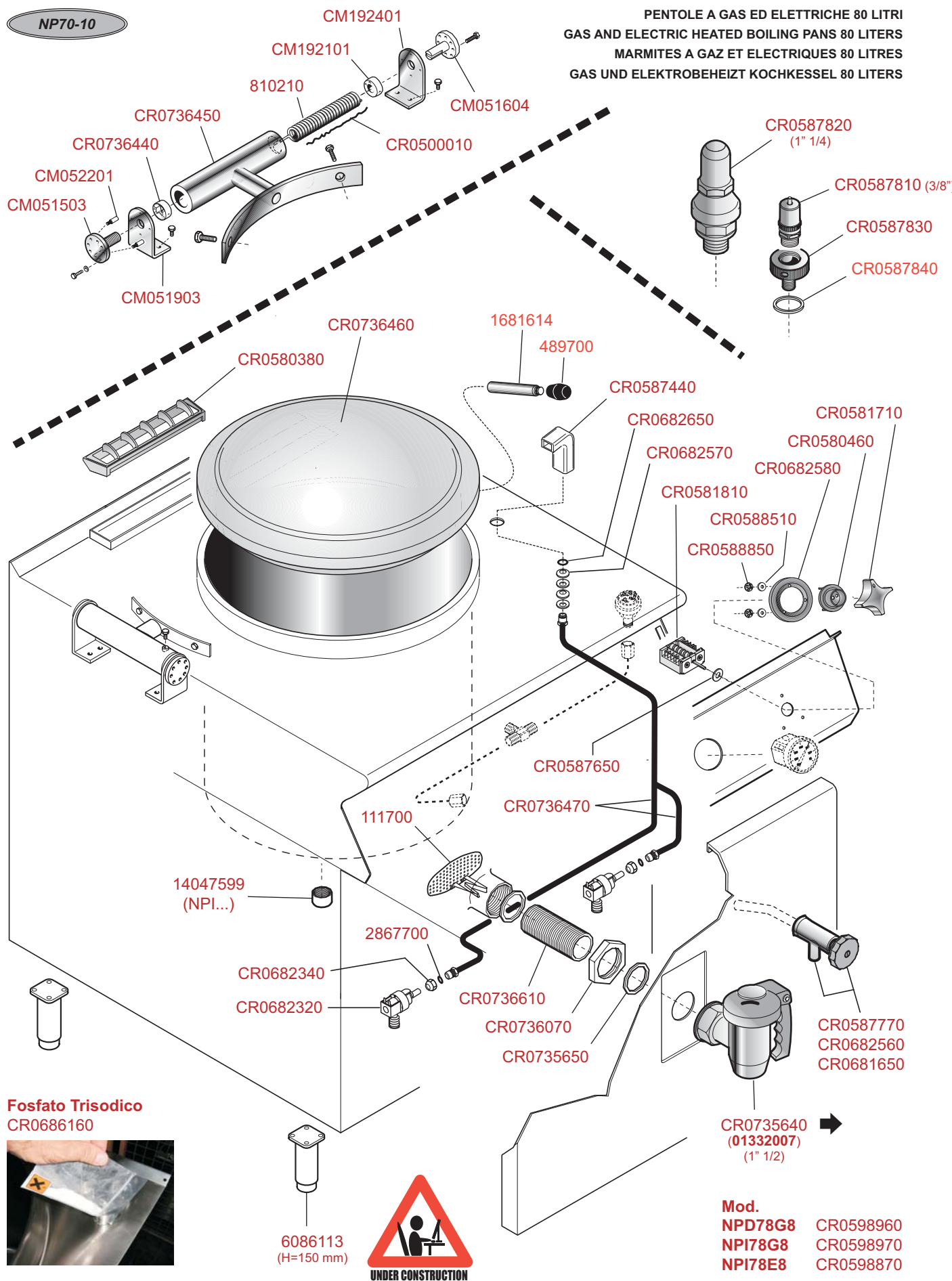

NP70-10

PENTOLE A GAS ED ELETTRICHE 80 LITRI
GAS AND ELECTRIC HEATED BOILING PANS 80 LITERS
MARMITES A GAZ ET ELECTRIQUES 80 LITRES
GAS UND ELEKTROBEHEIZT KOCHKESSEL 80 LITERS



Fosfato Trisodico
CR0686160



 MARENO INDUSTRIE ALI spa Mareno di Piave (TV)	ELABORATO:	APPROVATO:	GRUPPO:	DENOMINAZIONE:		
			Serie NP70	Impianto idraulico e mobile - Particolari comuni		
	DATA:	DATA:	PARTICOLARE:	REV. N.	DEL	DISEGNO N.
	21 Nov 2010	21 Nov 2010	Disegno esploso per ricambi	200	1110	3.P7.74
	SOST. DIS.					

1" 1/2 CON - 50 Lit.
Cod. CR0735640 (01332007)
 (Serie N-Protagonista 70 e 90 - 2008)

- 1 Corpo cod. 22901077
- 2 Cilindro cod. 22100959
- 3 Calotta cod. 22900804
- 4 Vite fissaggio cilindro cod. 51007375
- 5 Vite di fermo rotazione cod. 31007370
- 6 Impugnatura atermica cod. 34003011
- 7 Perno fissaggio impugnatura cod. 31004854
- 8 Anello tipo RA cod. 51000209
- 9 Dado cod. 22801231
- 10 Guarnizione cod. 34012778

A

Serial No.
 < MA020.....



Cod. 77122400
 Grasso/Grease
 art. 36206760
 KLUBER Non Trop
 PLB DR
 (Cod. art. 572411)
 tubo da 100 g)

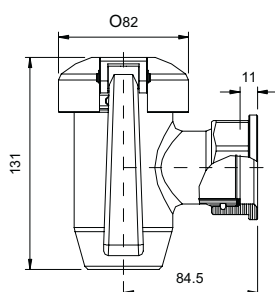

Dimens.
mm

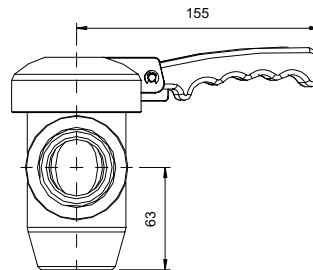

 MARENO INDUSTRIE ALI spa Mareno di Piave (TV)	ELABORATO:	APPROVATO:	GRUPPO:	DENOMINAZIONE:		
	LZ		Serie NP70 - 90	Rubinetti di scarico da 1" 1/2		
	DATA:	DATA:	PARTICOLARE:	REV. N.	DEL	DISEGNO N.
	16 Nov 2010	16 Nov 2010	Disegno esploso per ricambi	Z00	1110	3.P70.20/2
	SOST. DIS.					

NB74G (A - CM142200 cm 4,5x53)
NB78G (A - CM142200 cm 4,5x53) +
(B - CM142300 cm 7,5x53)

CR0732340 NB74G
CR0732350 NB78G

MOD. 40

1900900 Ø 75 □
1927400 Ø 85 ■
1421700 Ø 130 ○ ●
2715300 Ø 150 ▲
1631100 Ø 250 ✚ ✚

MOD. 80

5159700 Ø 110 □
1513000 Ø 125 ■
707200 Ø 190 ○ ●
707300 Ø 210 ▲
796500 Ø 420 ✚ ✚

CR0580640 NB74G
CR0580380 NB78G

CM142100
CM142000

CR0732200 (40)
CR0732220 (80)

CM021700

1326500

86720

CR0585010 (40)
CR0585020 (80)

1033700200

CR0688810

CR0688820

CR0585540

CM140600 (40)
CM140700 (80)

CR0732330

MOD. 40

CM147600 Ø 0,50 □ ■
CM147700 Ø 0,75 ○ ● ▲ ✚ ✚

MOD. 80

CM147700 Ø 0,75 □ ■
1884100 Ø 1,05 ○ ● ▲ ✚ ✚

673600

673500

1326500
86720

86720

1326500

CM140500 (0,75)

MOD.

NB74G CR0598360
NB78G CR0598370



CR0582470 (40)
CR0582480 (80)

1891700

1888400

CR0584990 (40)
CR0585000 (80)

CM029100
(M9x1 L=850 mm)

1949900

CM029000

673600

673500

1888000 Ø 14 □ ■
1887800 Ø 27 ○ ● ▲
1887900 Ø 50 ✚ ✚

ID GAS: □ G30/50 ◆ G30+31/37 ■ G30/28+37 ○ G20/20 ★ G20/25 ● G25/25 ☆ G25.1/25 ▲ G25/20

 MARENO INDUSTRIE ALI spa Mareno di Piave (TV)	ELABORATO:	APPROVATO:	GRUPPO:	DENOMINAZIONE:		
			Serie NP70	Impianto gas e mobile		
	DATA:	DATA:	PARTICOLARE:	REV. N.	DEL	DISEGNO N.
	11 Feb 2010	11 Feb 2010	Disegno esploso per ricambi	▼ Z00	▼ 0210	▼ 3.P7.19
	SOST. DIS.					



NP70-10

FRIGGITRICI A GAS 8+8 LITRI
GAS HEATED FRYERS 8+8 LITERS
FRITEUSES A GAZ 8+8 LITRES
GASBEHEIZTE FRITEUSEN 8+8 LITERS

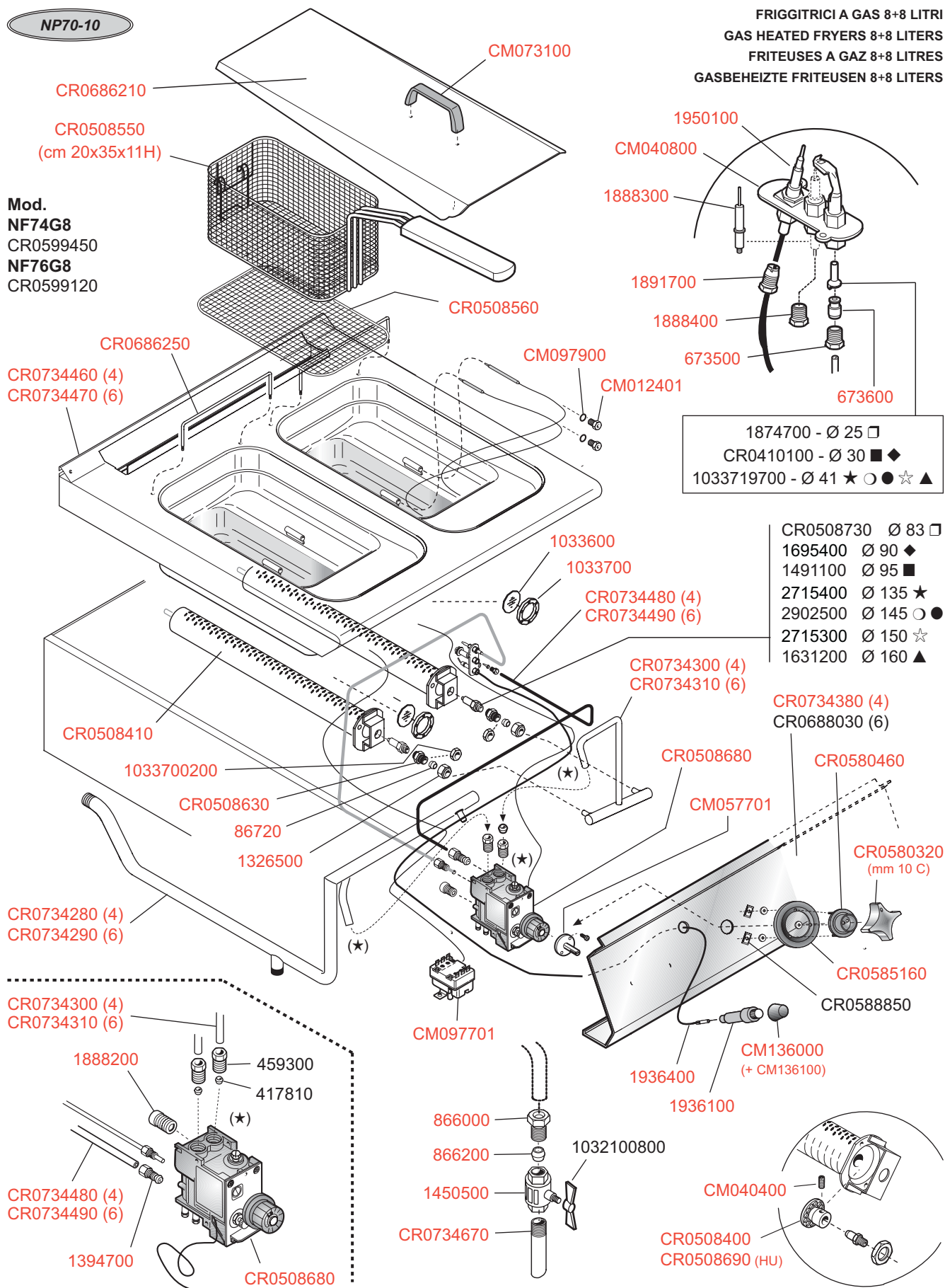
Mod.
NF74G8
CR0599450
NF76G8
CR0599120



ID GAS: □ G30/50 ■ G30/29 ○ G20/20 ● G25/25 ▲ G25/20 + G20/25 + G25.1/25

 MARENO INDUSTRIES ALI spa Mareno di Piave (TV)	ELABORATO:	APPROVATO:	GRUPPO:	DENOMINAZIONE:		
			Serie NP70	Impianto gas e mobile		
	DATA:	DATA:	PARTICOLARE:	REV. N.	DEL	DISEGNO N.
	11 Mar 2010	11 Mar 2010	Disegno esploso per ricambi	Z00	0110	3.P7.68

NP70-10

FRIGGITRICI A GAS 10+10 LITRI
GAS HEATED FRYERS 10+10 LITERS
FRITEUSES A GAZ 10+10 LITRES
GASBEHEIZTE FRITEUSEN 10+10 LITERS

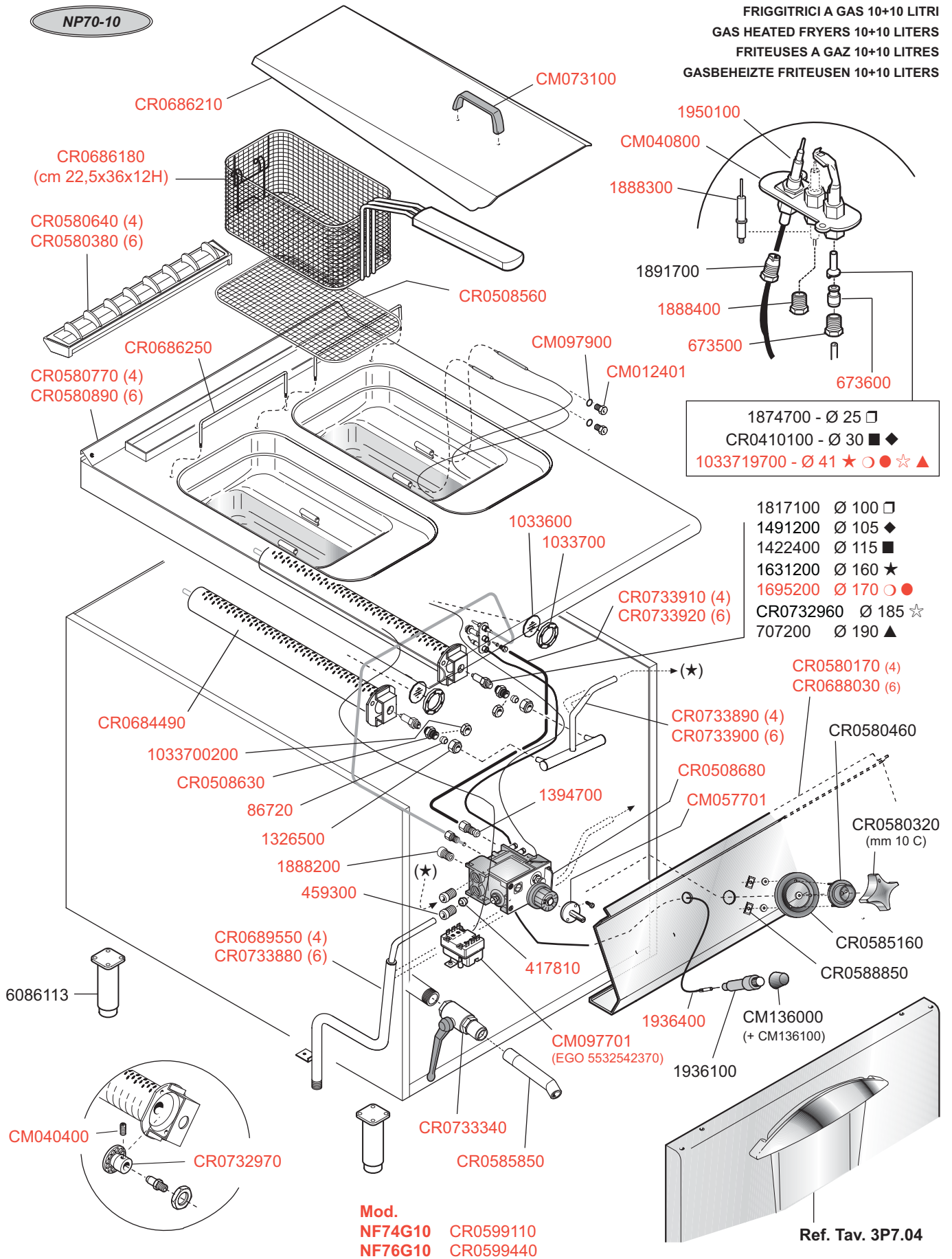

ID GAS: □ G30/50 ■ G30/29 ○ G20/20 ● G25/25 ▲ G25/20 + G20/25 + G25.1/25

 MARENO INDUSTRIE ALI spa Mareno di Piave (TV)	ELABORATO:	APPROVATO:	GRUPPO:	DENOMINAZIONE:		
			Serie NP70	Impianto gas e mobile		
	DATA:	DATA:	PARTICOLARE:	REV. N.	DEL	DISEGNO N.
	01 Gen 2010	01 Gen 2010	Disegno esploso per ricambi	▼	▼	▼
SOST. DIS.				Z00	0110	3.P7.52

NP70-10



FRIGGITRICI A GAS - 15 LITRI
GAS HEATED FRYERS - 15 LITERS
FRITEUSES A GAZ - 15 LITRES
GASBEHEIZTE FRITEUSEN - 15 LITERS

MOD.

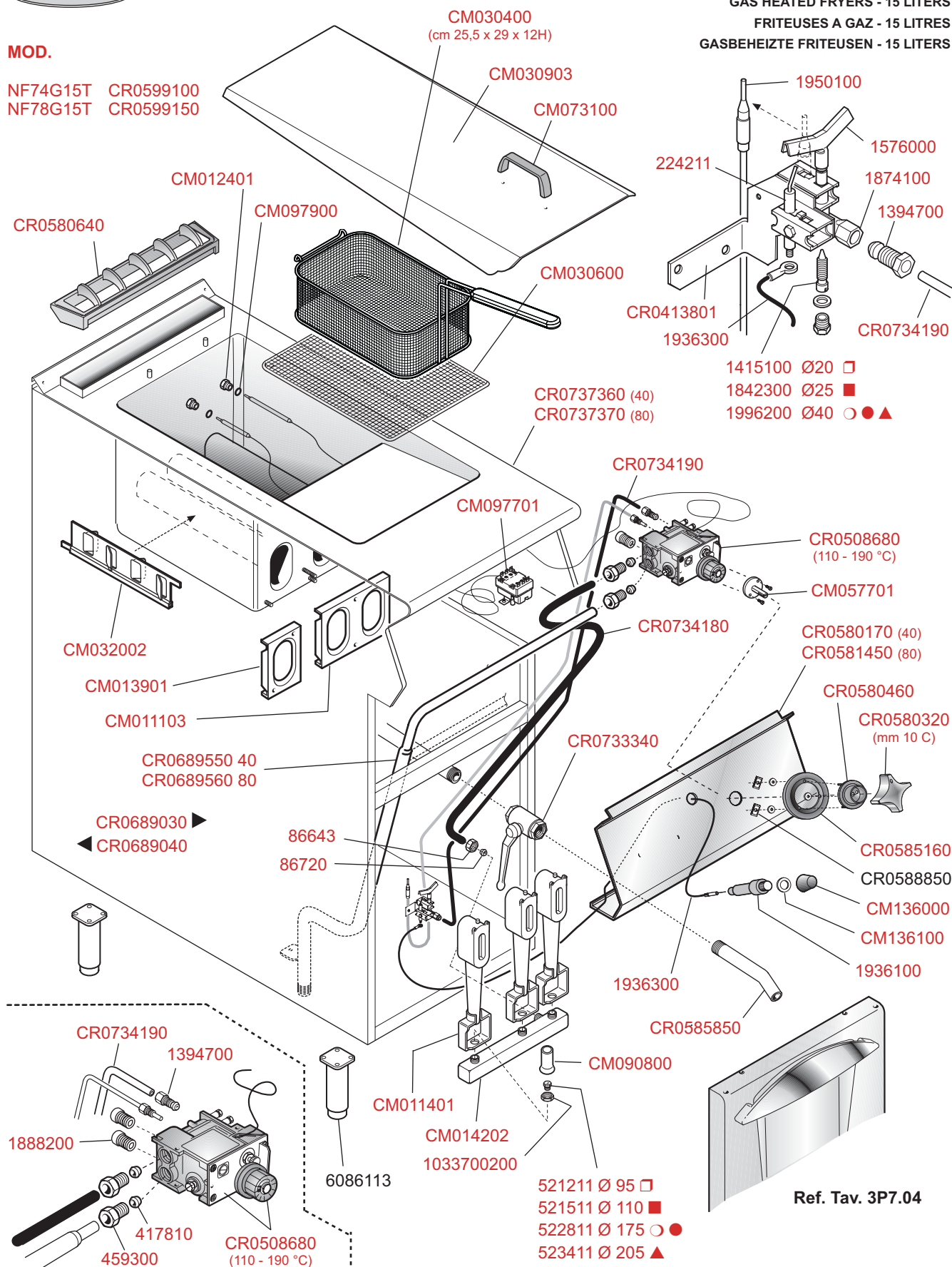
NF74G15T CR0599100
NF78G15T CR0599150



ID GAS: □ G30/50 ◆ G30+31/37 ■ G30/28+37 ○ G20/20 ★ G20/25 ● G25/25 ☆ G25.1/25 ▲ G25/20

 MARENO INDUSTRIE ALI spa Mareno di Piave (TV)	ELABORATO:	APPROVATO:	GRUPPO:	DENOMINAZIONE:		
			Serie NP70	Impianto gas e mobile		
	DATA:	DATA:	PARTICOLARE:	REV. N.	DEL	DISEGNO N.
	03 Feb 2010	03 Feb 2010	Disegno esploso per ricambi	200	0110	3.P7.31
SOST. DIS.						