

NP90-07

PIANI DI COTTURA GAS - FUOCHI APERTI
GAS COOKING TOPS
PLANS DE CUISSON A GAZ
GAS KOCHSTELLEN

> 18.11.2010

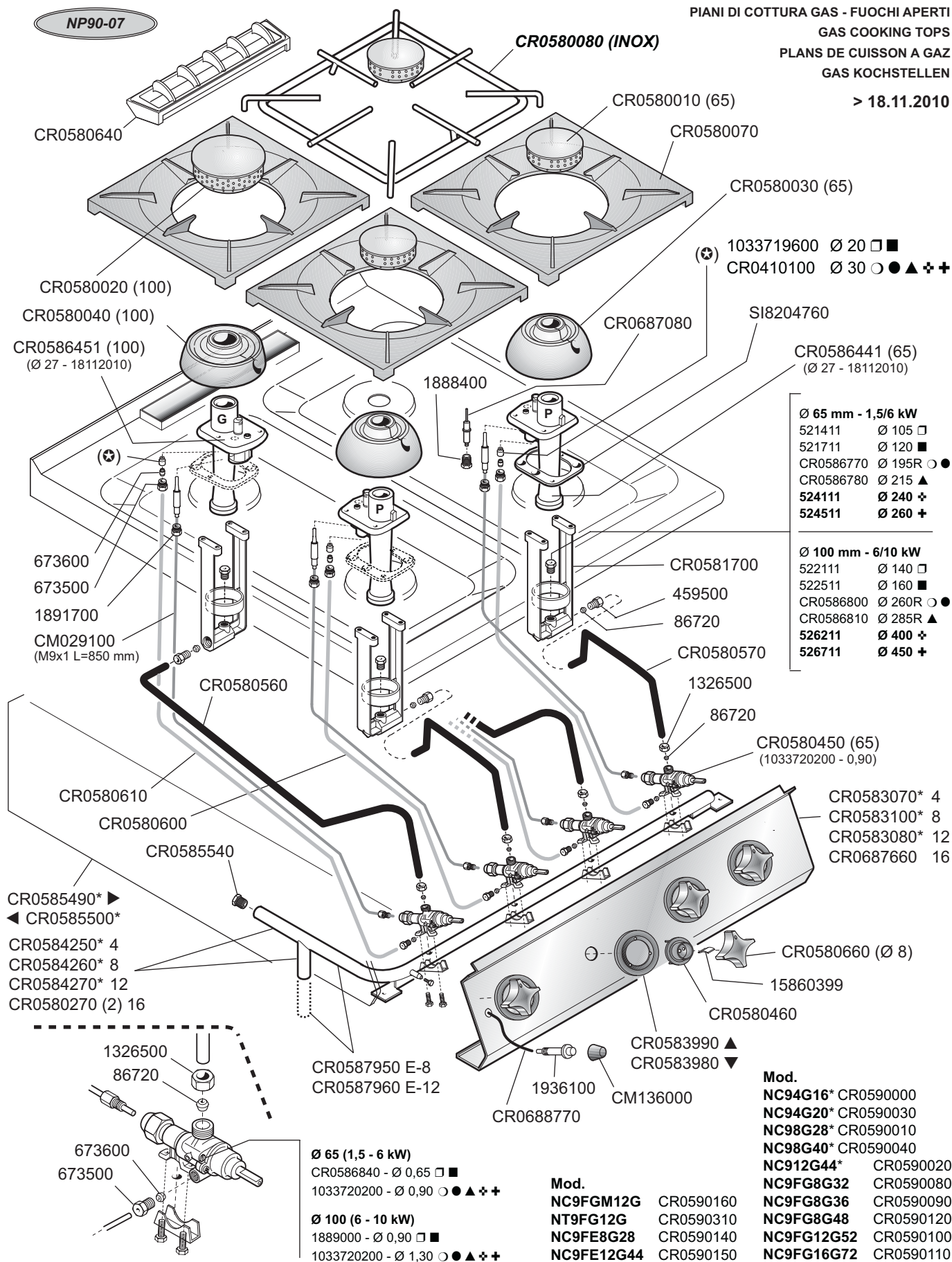

ID GAS: □ G30/50

■ G30/29



○ G20/20

● G25/25

▲ G25/20

✚ G120/8

✛ G110/8

 MARENO INDUSTRIE ALI spa Mareno di Piave (TV)	ELABORATO:	APPROVATO:	GRUPPO:	DENOMINAZIONE:		
			Cucine Serie NP90	Impianto gas e mobile		
	DATA:	DATA:	PARTICOLARE:	REV. N.	DEL	DISEGNO N.
	18 Nov. 2010	18 Nov. 2010	Disegno esploso per ricambi	▼ Z03	▼ 0312	▼ 3.P90.01/90
SOST. DIS.						

NP90-07

TUTTAPIASTRA A GAS
GAS SOLID TOP
PLAQUES COUP-DE-FEU A GAZ
GASBEHEIZTE GLEHPLATTENHERDE

MOD.
NT98G CR0590290
NT9FG8G CR0590300
NT9FG12G CR0590310

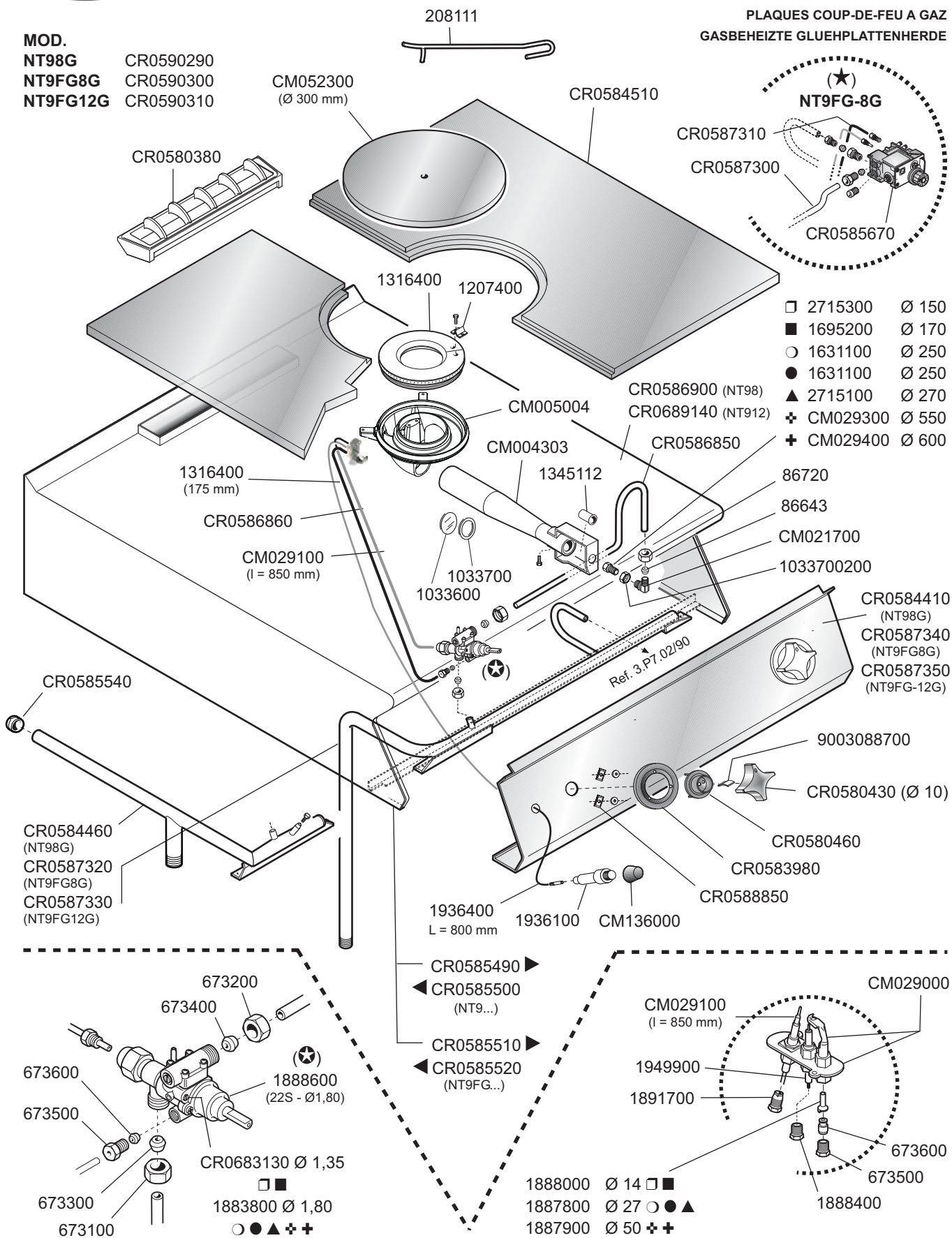

ID GAS:

□ G30/50

■ G30/29



○ G20/20

● G25/25

▲ G25/20

✚ G120/8

✚ G110/8

 MARENO INDUSTRIE ALI spa Mareno di Piave (TV)	ELABORATO:	APPROVATO:	GRUPPO:	DENOMINAZIONE:		
			Serie NP90	Impianto gas e mobile		
	DATA:	DATA:	PARTICOLARE:	REV. N.	DEL	DISEGNO N.
	12 Set 2007	12 Set 2007	Disegno esploso per ricambi	200	0907	3.P90.05

SOST. DIS.



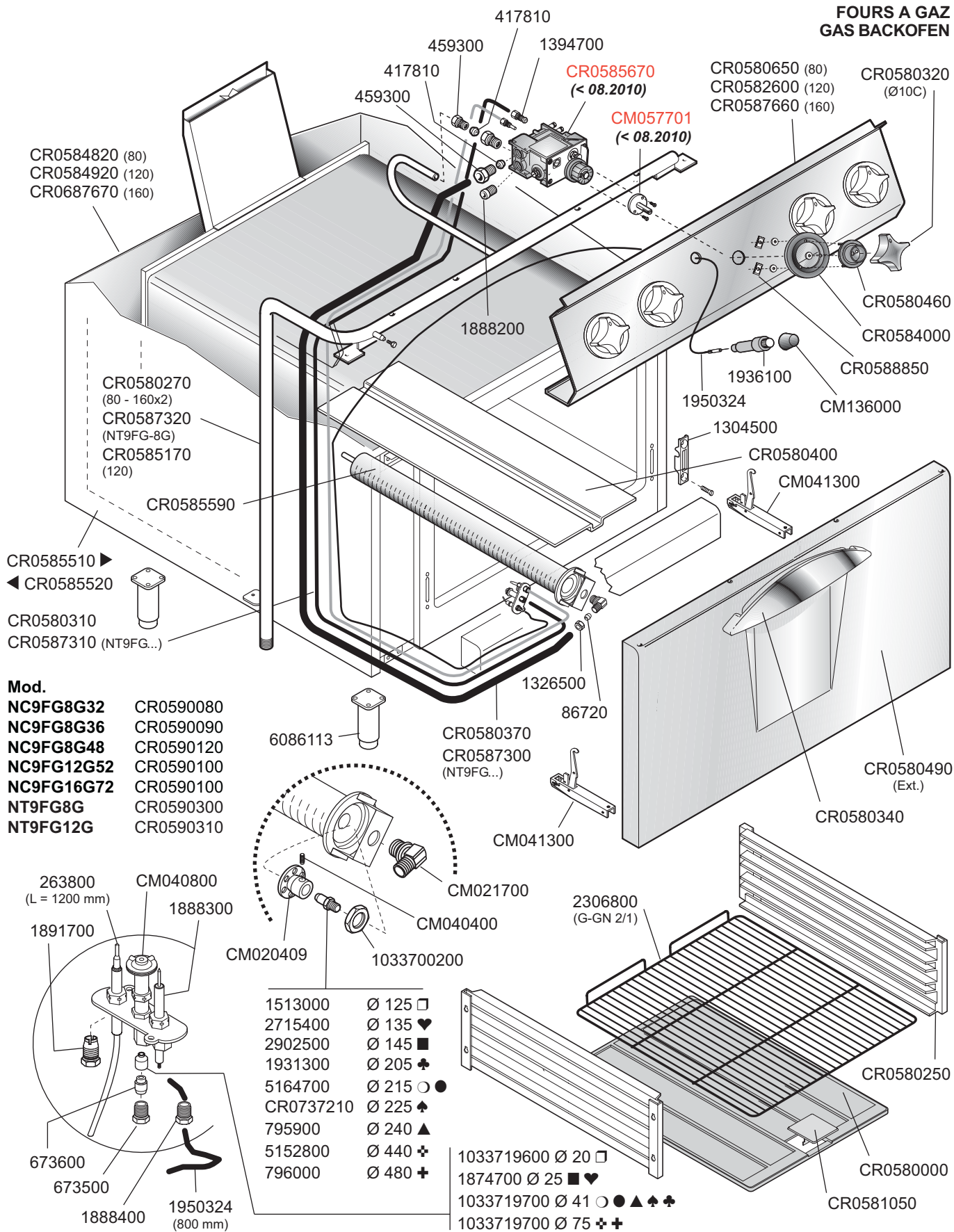

ID GAS: □ G30/50 ♥ G30/37 ■ G30/30 ○ G20/20 ♠ G25.1/25 ● G25/25 ▲ G25/20 ♣ G20/25 + G120/8 + G110/8

 MARENO INDUSTRIE ALI spa Mareno di Piave - TV	ELABORATO:	APPROVATO:	GRUPPO:	DENOMINAZIONE:		
	bz		Serie NP90	Impianto gas e mobile		
	DATA:	DATA:	PARTICOLARE:	REV. N.	DEL	DISEGNO N.
	28 Giu. 2007	28 Giu. 2007	Disegno esploso per ricambi	▼ Z00	▼ 1109	▼ 3.P90.02 1/2
SOST. DIS.						

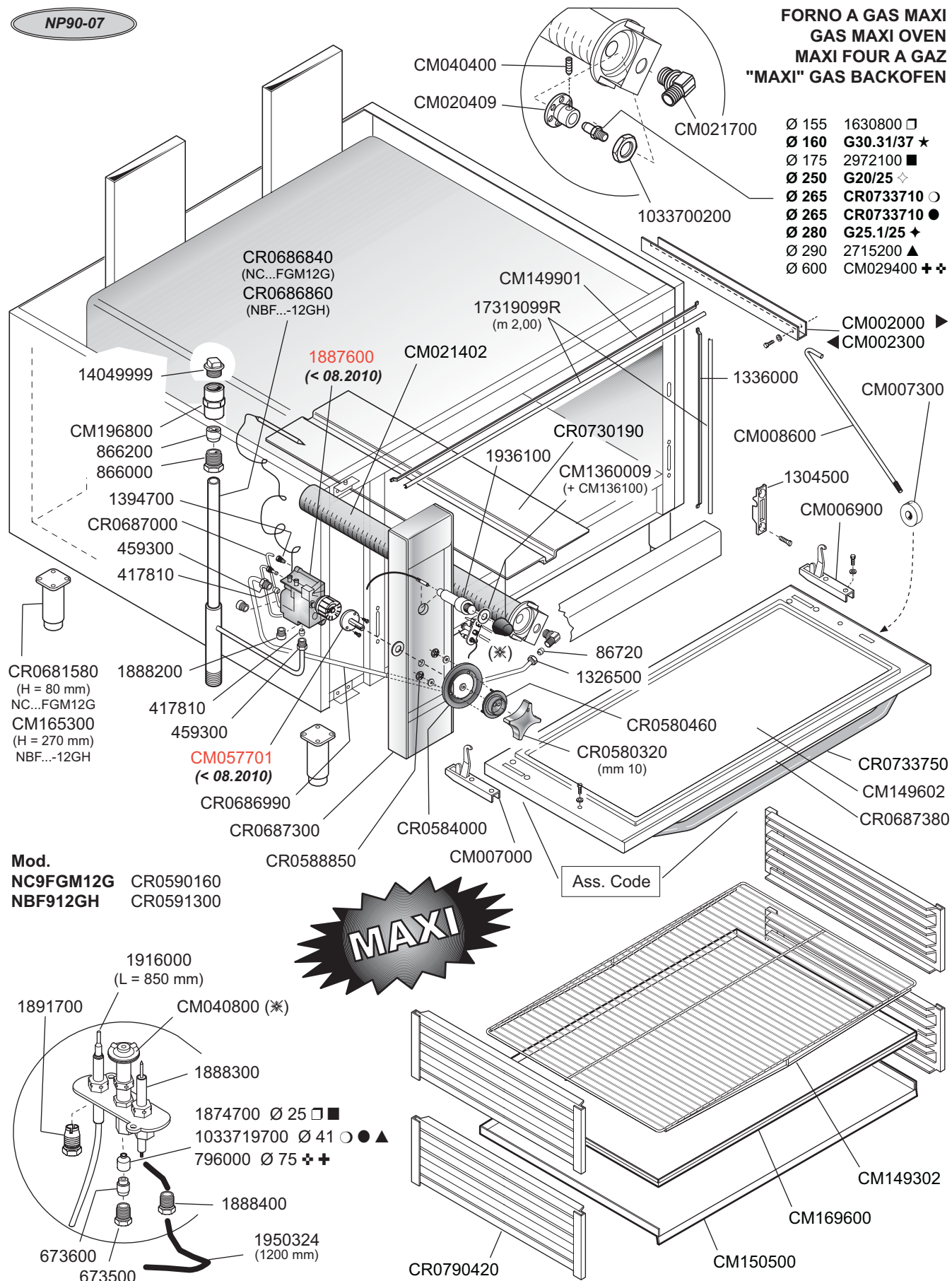

NP90-07

FORNO A GAS MAXI
GAS MAXI OVEN
MAXI FOUR A GAZ
"MAXI" GAS BACKOFEN



Mod.

NC9FGM12G CR0590160
NBF912GH CR0591300

ID GAS:		□ G30/50	■ G30/29	○ G20/20	● G25/25	▲ G25/20	+ G120/8	+ G110/8
 MARENO INDUSTRIE ALI spa Mareno di Piave (TV)	ELABORATO:	APPROVATO:	GRUPPO:		DENOMINAZIONE:			
			Serie forno MAXI NP70		Impianto gas e mobile			
	DATA:	DATA:	PARTICOLARE:		REV. N.	DEL	DISEGNO N.	
	15 Feb 2010	15 Feb 2010	Disegno esploso per ricambi		▼	▼	▼	
SOST. DIS.					Z00	0210	3.P90.47 1/2	

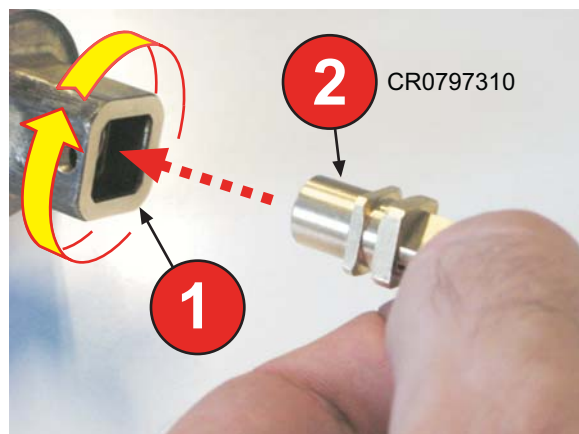

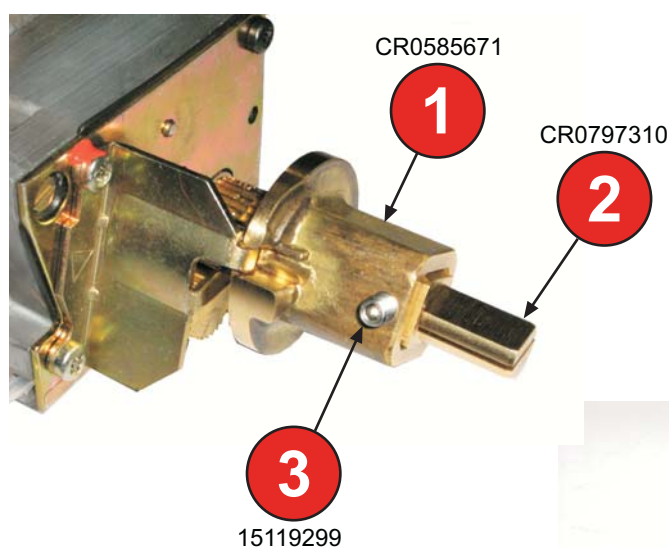
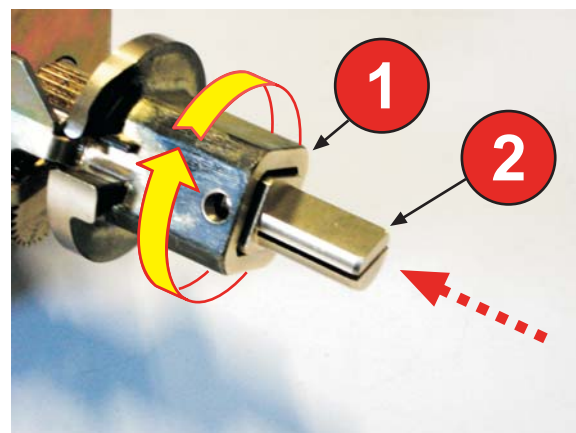

Per posizionare la manopola in posizione (O):

Ruotare la manopola (1) completamente in senso orario (Fig. 1 e 2). Inserire il perno (2) con la parte fresata verso l'alto, in posizione orizzontale (Fig. 2). Bloccare il perno (2) alla manopola (1) stringendo la vite (grano) (3)



La regola si applica
alle valvole montate:
"in verticale"
(es. forno gas)
e "in orizzontale"
(es. fry top gas)



ID GAS: <input type="checkbox"/> G30/50 <input checked="" type="checkbox"/> G30/29 <input type="checkbox"/> G20/20 <input checked="" type="checkbox"/> G25/25 <input type="checkbox"/> G25/20				
 MARENO INDUSTRIE ALI spa Mareno di Piave (TV)	ELABORATO:	APPROVATO:	GRUPPO:	DENOMINAZIONE:
			Serie 90	Impianto gas termostatico
	DATA:	DATA:	PARTICOLARE:	REV. N. DEL DISEGNO N.
	22 Gen 2011	22 Gen 2011	Disegno esploso per ricambi	▼ ▼ ▼ Z00 0111 3.P90.47 2/2
SOST. DIS. 				

NP90-07

DIRECT



NFT94GL CR0587100
 NFT94GR CR0587120
 NFT96GL CR0686010
 NFT96GM CR0686020

NFT98GL CR0581150
 NFT98GR CR0587160
 NFT98GM CR0587140

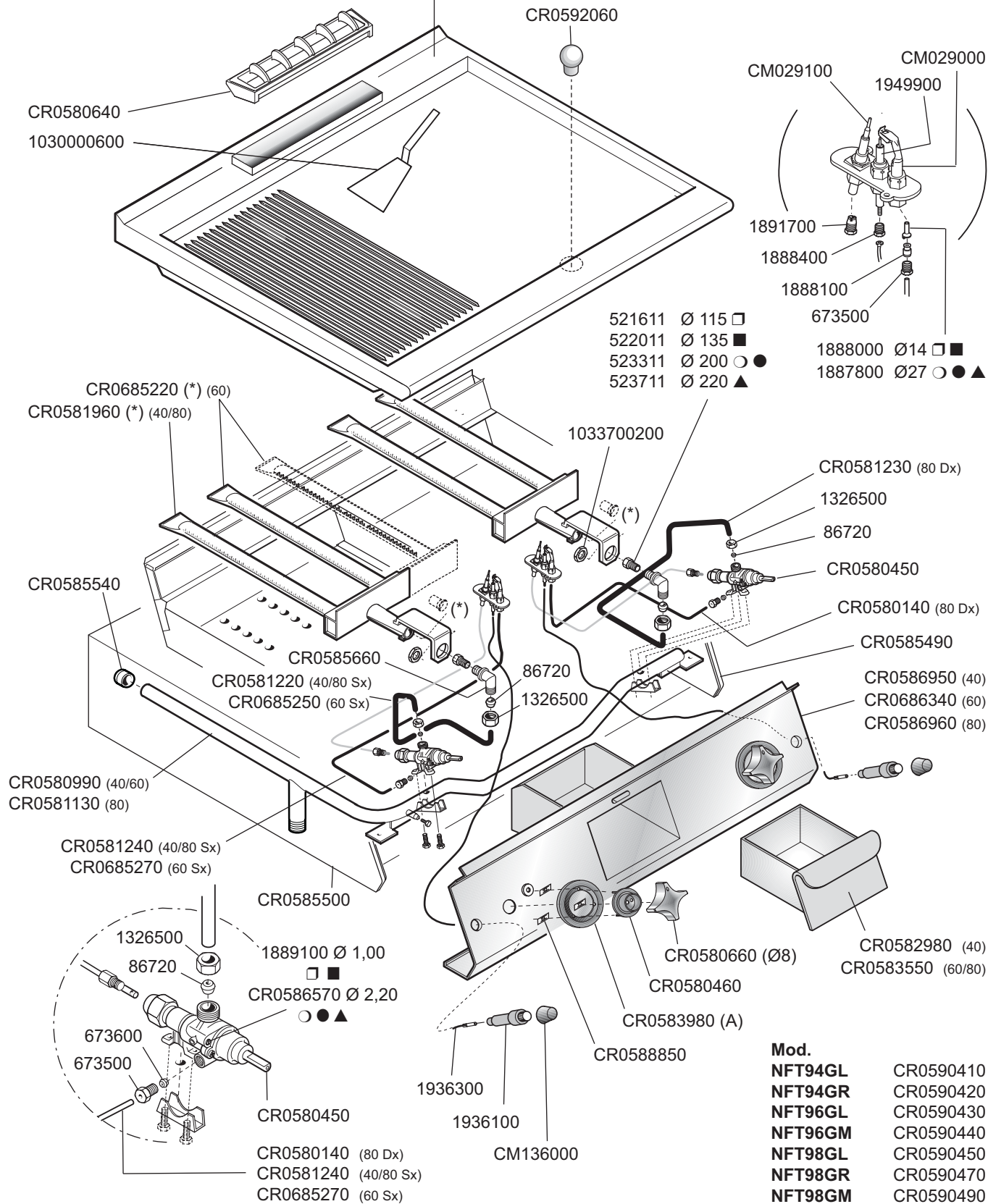
FRY TOPS A GAS
 GAS-HEATED FRY-TOPS
 GRILLADES A GAZ
 GASBEHEIZTE BRAT- UND GRILLPLATTEN



ID GAS: □ G30/50 ■ G30/29 ○ G20/20 ● G25/25 ▲ G25/20

 MARENO INDUSTRIE ALI spa Mareno di Piave (TV)	ELABORATO:	APPROVATO:	GRUPPO:	DENOMINAZIONE:		
			Serie NP90	Impianto gas risc. diretto e mobile		
	DATA:	DATA:	PARTICOLARE:	REV. N.	DEL	DISEGNO N.
	05 Giu 2007	05 Giu 2007	Disegno esploso per ricambi	▼ Z00	▼ 1108	▼ 3.P90.11.DIR
SOST. DIS.						

NC90-07

THERMOSTAT

NFT94GTLC CR0587110
NFT94GTRC CR0587670
NFT98GTLC CR0587130
NFT9-8GTMC CR0587150



NFT94GTLO CR0587680
NFT98GTL CR0581150
NFT98GTR CR0587160
NFT98GTM CR0587140
NFT98GTLO CR0587690

FRY TOPS A GAS
GAS-HEATED FRY-TOPS
GRILLADES A GAZ
GASBEHEIZTE BRAT- UND GRILLPLATTEN

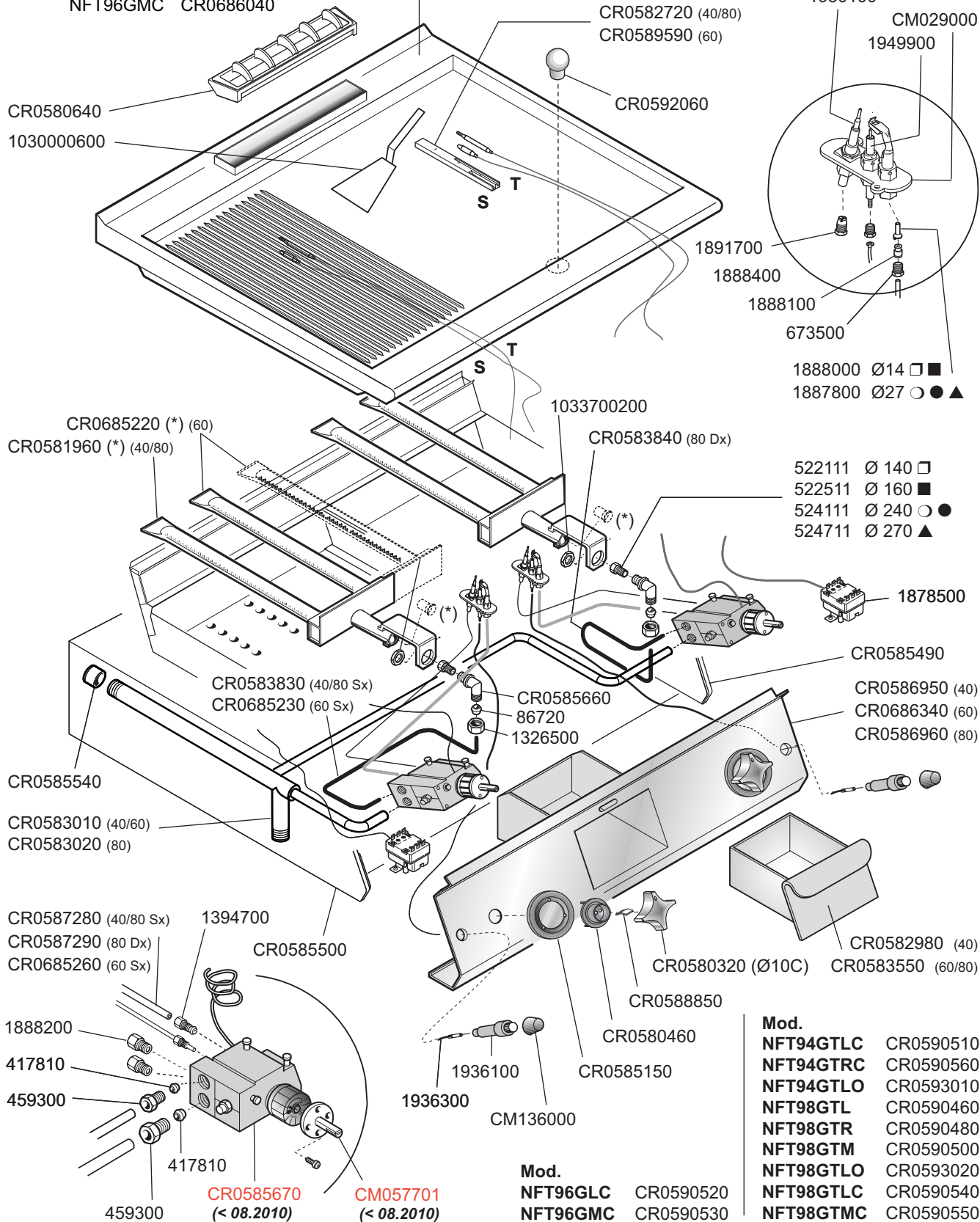
NFT96GLC CR0686030
NFT96GMC CR0686040



ID GAS: □ G30/50 ■ G30/29 ○ G20/20 ● G25/25 ▲ G25/20

 MARENO INDUSTRIE ALI spa Mareno di Piave (TV)	ELABORATO:	APPROVATO:	GRUPPO:	DENOMINAZIONE:		
			Serie 90	Impianto gas termostatico e mobile		
	DATA:	DATA:	PARTICOLARE:	REV. N.	DEL	DISEGNO N.
	05 Giu 2007	05 Giu 2007	Disegno esploso per ricambi	▼ Z00	▼ 1108	▼ 3.P90.11.TER.1



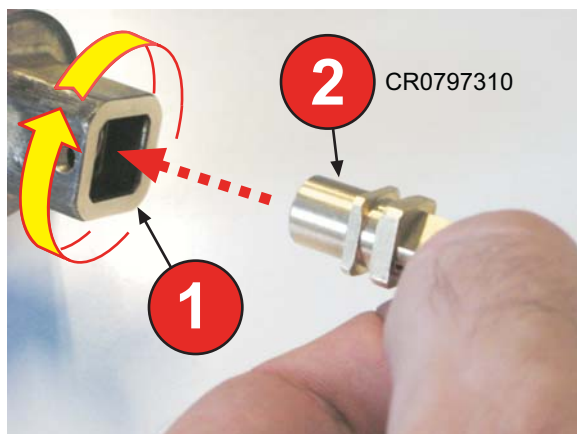

Per posizionare la manopola in posizione (O):

Ruotare la manopola (1) completamente in senso orario (Fig. 1 e 2). Inserire il perno (2) con la parte fresata verso l'alto, in posizione orizzontale (Fig. 2). Bloccare il perno (2) alla manopola (1) stringendo la vite (grano) (3)

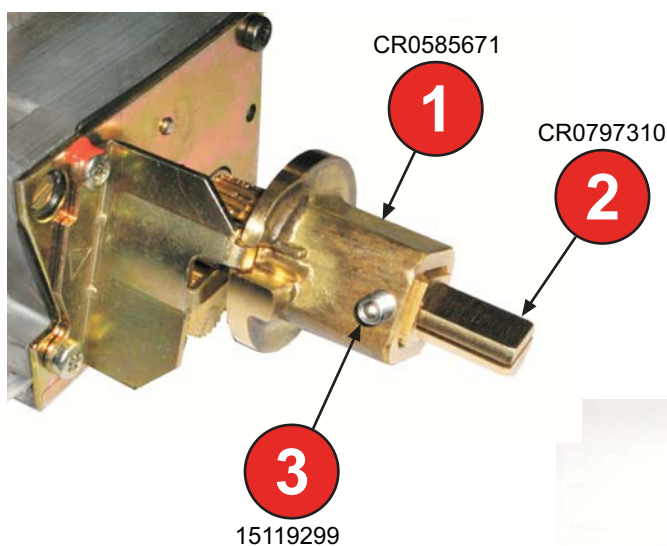
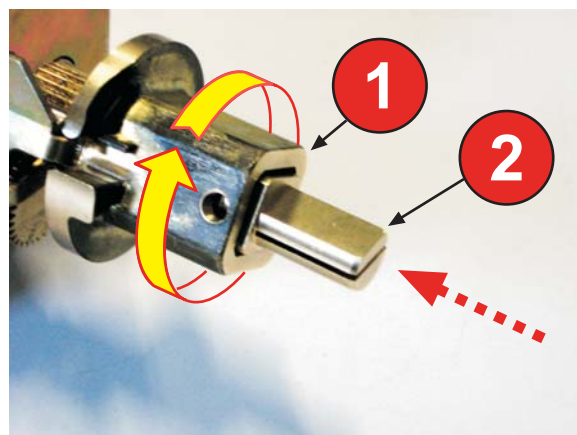



La regola si applica alle valvole montate: "in verticale" (es. forno gas) e "in orizzontale" (es. fry top gas)



Mod.
NFT94GTLC CR0590510
NFT94GTRC CR0590560
NFT94GTLO CR0593010
NFT98GTL CR0590460
NFT98GTR CR0590480
NFT98GTM CR0590500
NFT98GTLO CR0593020
NFT98GTLC CR0590540
NFT98GTMC CR0590550

Mod.
NFT96GLC CR0590520
NFT96GMC CR0590530

ID GAS: <input type="checkbox"/> G30/50 <input checked="" type="checkbox"/> G30/29 <input type="checkbox"/> G20/20 <input checked="" type="checkbox"/> G25/25 <input checked="" type="checkbox"/> G25/20				
 MARENO INDUSTRIE ALI spa Mareno di Piave (TV)	ELABORATO:	APPROVATO:	GRUPPO:	DENOMINAZIONE:
			Serie 90	Impianto gas termostatico
	DATA:	DATA:	PARTICOLARE:	REV. N. DEL DISEGNO N.
	22 Gen 2011	22 Gen 2011	Disegno esploso per ricambi	<div> <div>▼</div> <div>0111</div> </div> <div> <div>▼</div> <div>3.P90.11.TER.2</div> </div>
SOST. DIS.				

NP90-07

BRASIERE A GAS ROVESCIBILI
GAS HEATED TILTING BRATT PANS
SAUTEUSES BASCULANTES A GAZ
GASBEHEIZT KIPPBRATPFANNEN

Mod.
NBR98GF CR0590980
NBR98GI CR0591000
NBR98GFM CR0590990
NBR98GIM CR0591010
NBR912GFM CR0591020
NBR912GIM CR0591030

CR0681402 (BR9-8...) 4T
 CR0684100 (BR9-12...) 6T

Mod. NBR98...

523211 Ø 195 □
 523511 Ø 210 ⊛
 523811 Ø 225 ■
 525411 Ø 320 ▲
 525611 Ø 340 ○
 525611 Ø 340 ●
 525811 Ø 360 ♥
 525911 Ø 370 ▼

Mod. NBR912...

523611 Ø 215 □
 523911 Ø 230 ⊛
 524311 Ø 250 ■
 525711 Ø 350 ▲
 526011 Ø 380 ○
 526011 Ø 380 ●
 526211 Ø 400 ♥
 526411 Ø 420 ▼

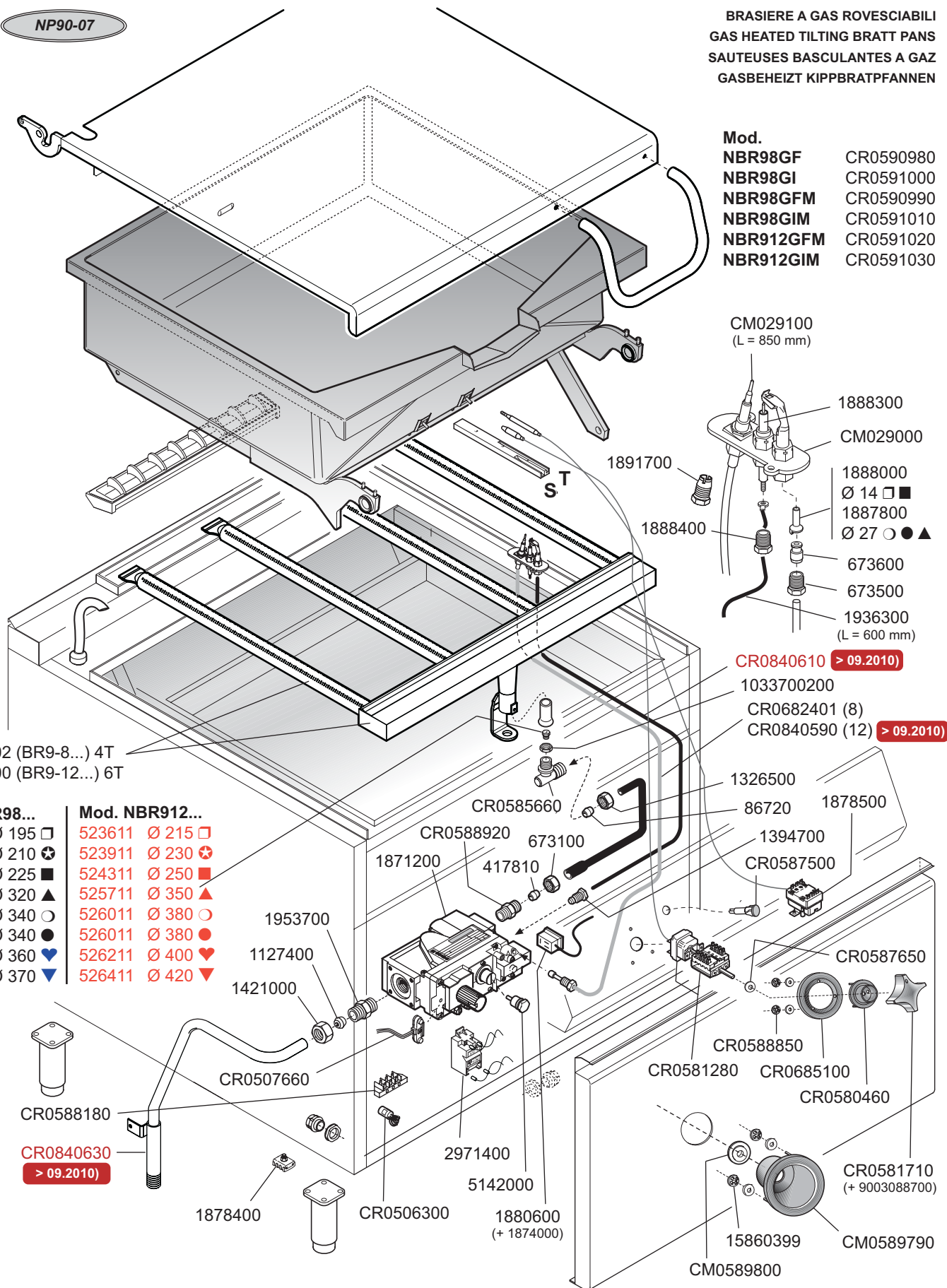

ID: □ G30/50 ■ G30/30 ⊛ G30/37 ○ G20/20 ● G25/25 ▲ G20/25 ▼ G25/20 ♥ G25.1/25 ♣ G110/8 ♦ G120/8

 MARENO INDUSTRIE ALI spa Mareno di Piave (TV)	ELABORATO:	APPROVATO:	GRUPPO:	DENOMINAZIONE:		
			Serie NP90	Impianto gas		
	DATA:	DATA:	PARTICOLARE:	REV. N.	DEL	DISEGNO N.
	20 Gen 2011	20 Gen 2011	Disegno esploso per ricambi	▼ Z00	▼ 0111	▼ 3.P90.17 1/2
SOST. DIS.						

□ G30/50 ■ G30/29 ○ G20/20 ● G25/25 ▲ G25/20 ▲ G110/8 ○ G120/8 ● G140/8

VARIANTI - SEVERAL - DIVERSES - MEHRERE

2009.11

Matricole N. - N. de Série - Serial No. - Serien-Nr.

MA 020143596 - MA 020143597 - MA 020150549

Termostato - Thermostat

MA1037102300 (45° - 295°C) EGO 55.19052.812



Staffa bassa - Bride basse - Low bracket - Klemme schmal

MA921200 EGO

Commutatore - Switch - Commutateur - Umschalter

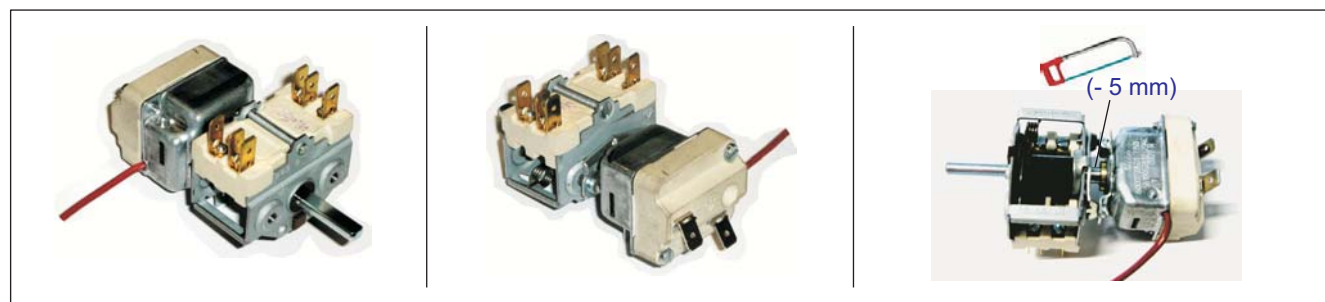
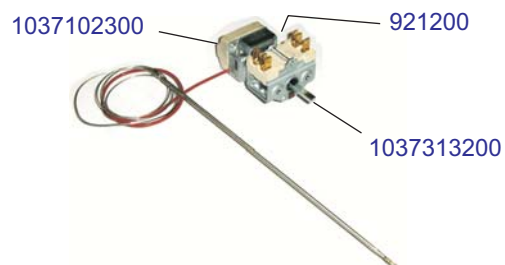
MA1037313200 (250V 6A) EGO 49.21015.600



 MARENO INDUSTRIES ALI spa Mareno di Piave (TV)	ELABORATO:	APPROVATO:	GRUPPO:	DENOMINAZIONE:		
			Serie NP90	Impianto gas		
	DATA:	DATA:	PARTICOLARE:	REV. N.	DEL	DISEGNO N.
	18 Apr 2008	18 Apr 2008	Disegno esploso per ricambi	▼ Z00	▼ 0708	▼ 3.P90.17 2/2
	SOST. DIS.		CE			

NP90-10

BRASIERE ROVESCIBILI 120
TILTING BRATT PANS 120
SAUTEUSES BASCULANTES 120
KIPPBRATPFANNEN 120

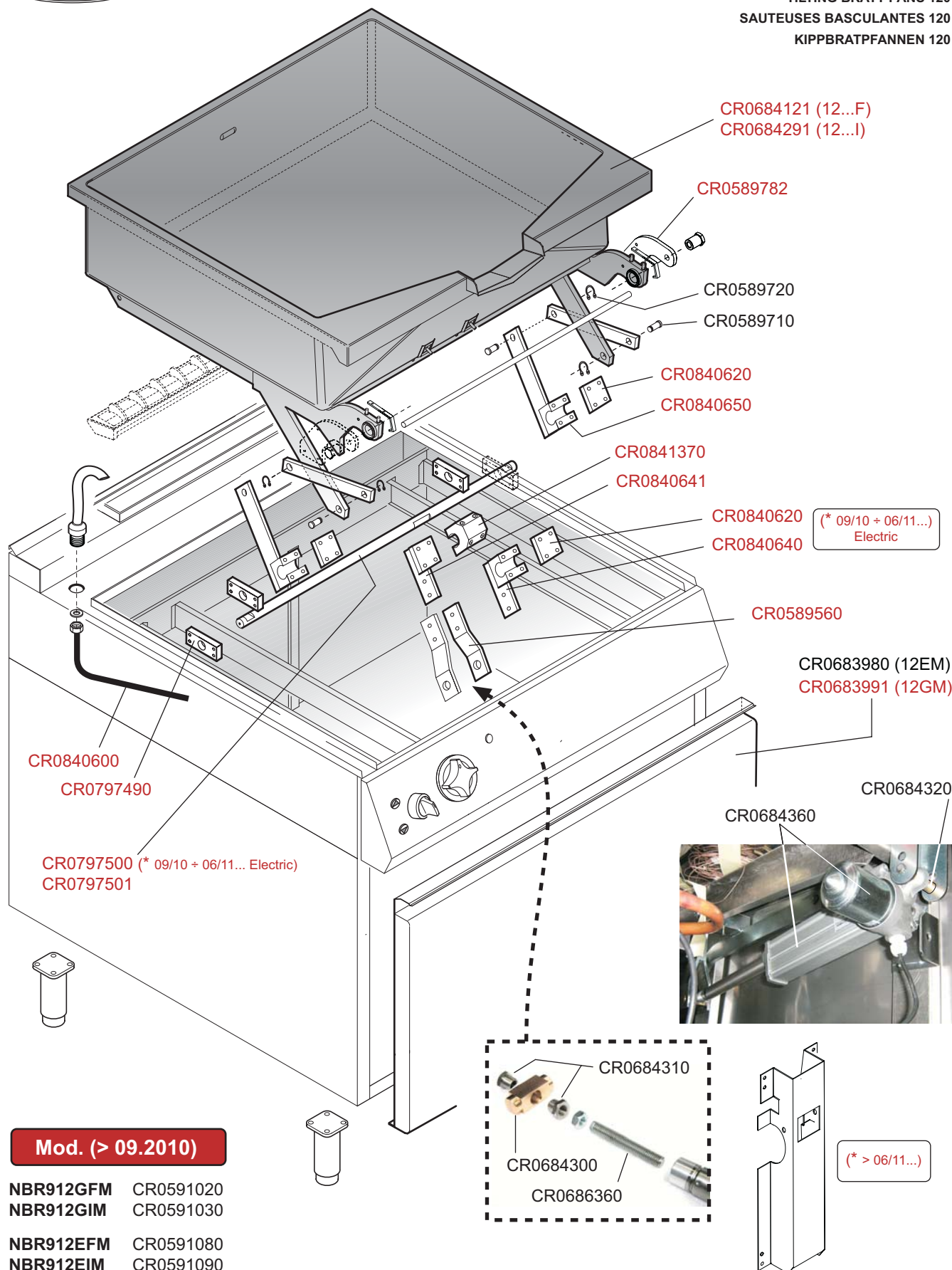

 MARENO INDUSTRIE ALI spa Mareno di Piave (TV)	ELABORATO:	APPROVATO:	GRUPPO:	DENOMINAZIONE:		
	LZ		Serie NP90 - 12	Mobile, Sistema idraulico e Movimento vasca		
	DATA:	DATA:	PARTICOLARE:	REV. N.	DEL	DISEGNO N.
	01 Set 2010	01 Set 2010	Disegno esploso per ricambi	Z05	0711	3.P90.18.2

NP90-07

(> 12.2011)

GRIGLIA A GAS
GAS HEATED GRILLS
GRILLADES A GAZ
GASBEHEIZTE GRILL

Mod.

NG94G

CR0590690

NG98G

CR0590700

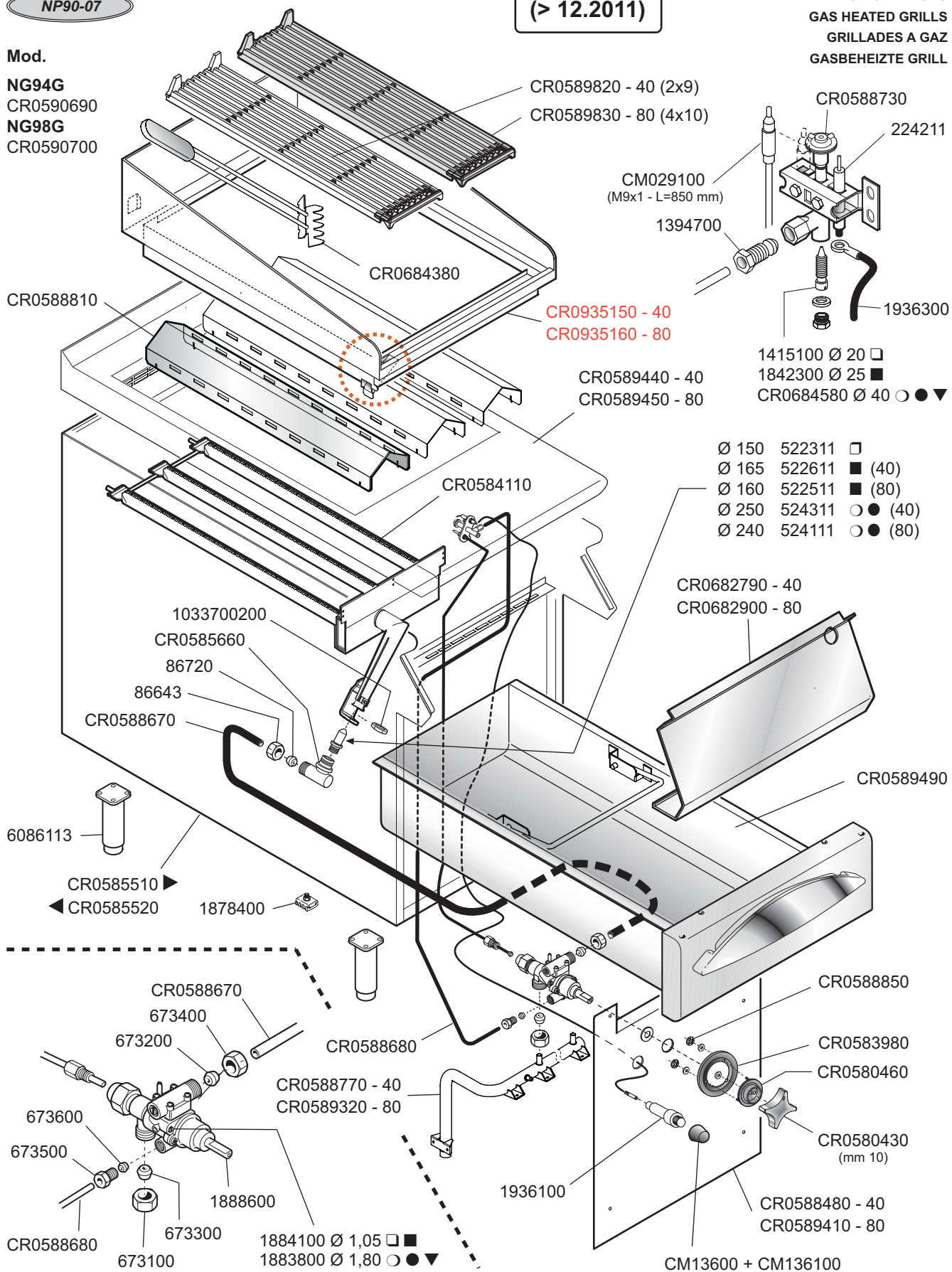

ID GAS:

□ G30/50

■ G30/29

○ G20/20

● G25/25

▲ G25/20

✚ G120/8

✚ G110/8



MARENO ALI spa
Mareno di Piave (TV)

ELABORATO:

LZ

DATA:

09 Gen 2012

SOST. DIS.

APPROVATO:

DATA:

09 Gen 2012

GRUPPO:

Serie NC90

PARTICOLARE:

Disegno esploso
per ricambi



DENOMINAZIONE:

Impianto gas e mobile

REV. N.

Z01

DEL

0112

DISEGNO N.

3.P90.37

NP90-07

(< 01.2012)

GRIGLIA A GAS
GAS HEATED GRILLS
GRILLADES A GAZ
GASBEHEIZTE GRILL

Mod.

NG94G

CR0590690

NG98G

CR0590700

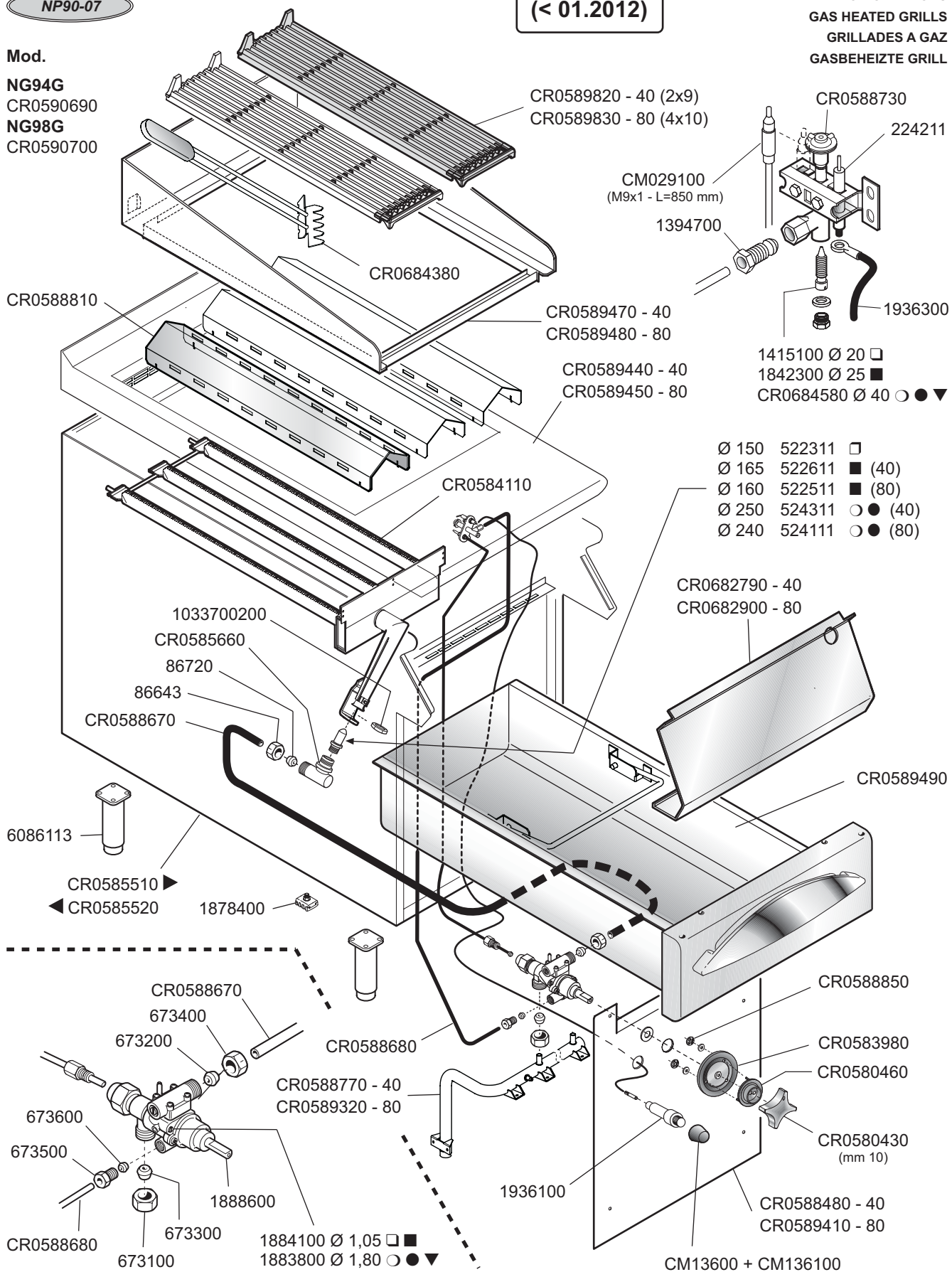

ID GAS:

□ G30/50

■ G30/29

○ G20/20

● G25/25

▲ G25/20

✚ G120/8

✚ G110/8



MARENO ALI spa
Mareno di Piave (TV)

ELABORATO:

LZ

DATA:

14 Gen 2008

SOST. DIS.

APPROVATO:

DATA:

14 Gen 2008

GRUPPO:

Serie NC90

PARTICOLARE:

Disegno esploso
per ricambi



DENOMINAZIONE:

Impianto gas e mobile

REV. N.

Z00

DEL

0108

DISEGNO N.

3.P90.37

NP90-07

CUOCIPASTA A GAS
GAS-HEATED PASTA COOKERS
CUISEUR A PATES A GAZ
GASBEHEIZTE TEIGWARENKOCHER

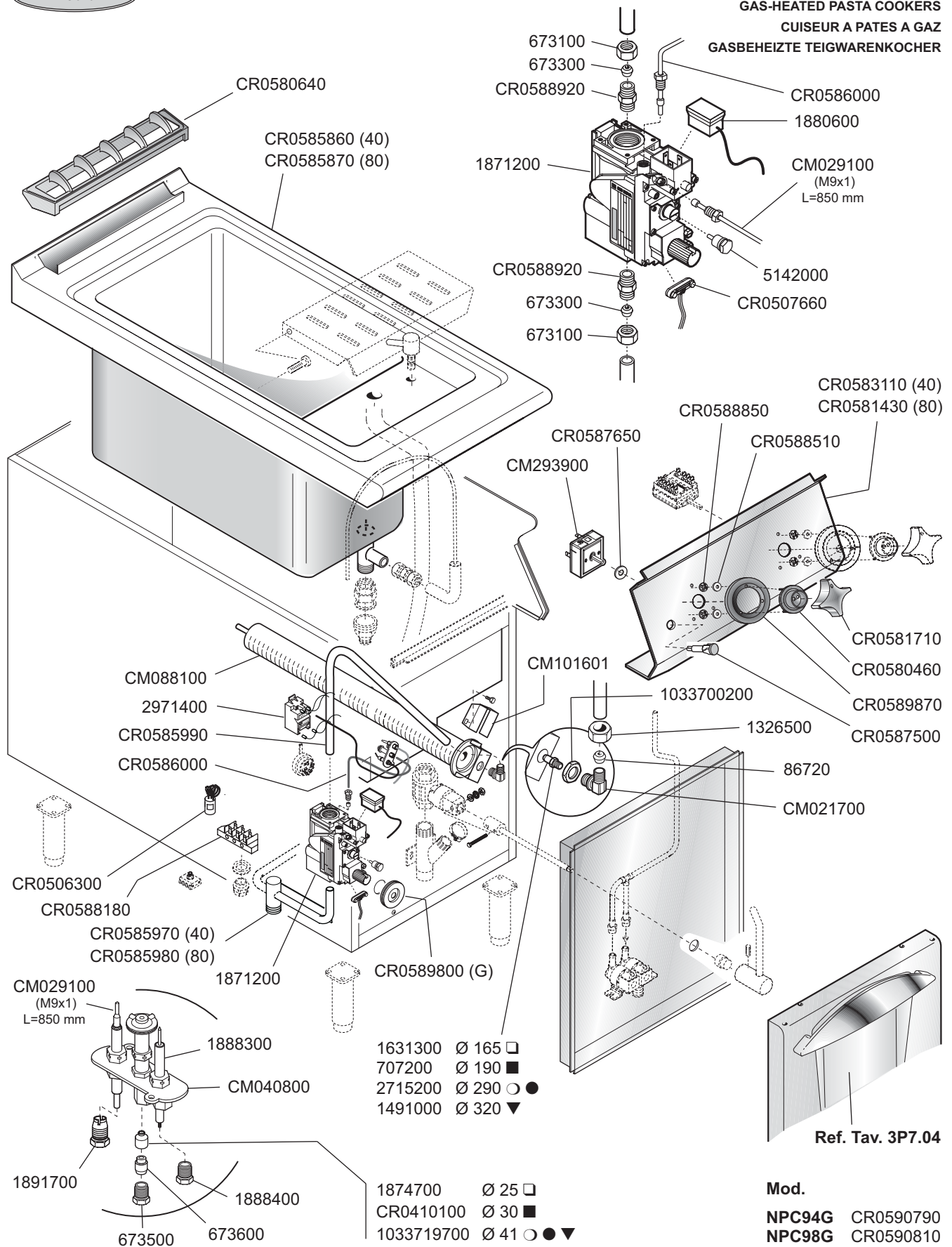

ID GAS: □ G30/50 ■ G30/29 ○ G20/20 ● G25/25 ▲ G25/20 ✚ G120/8 ✚ G110/8

 MARENO INDUSTRIE ALI spa Mareno di Piave (TV)	ELABORATO:	APPROVATO:	GRUPPO:	DENOMINAZIONE:		
	LZ		Serie NP90	Impianto gas		
	DATA:	DATA:	PARTICOLARE:	REV. N.	DEL	DISEGNO N.
	14 Nov 2007	14 Nov 2007	Disegno esploso per ricambi	▼ Z00	▼ 1107	▼ 3.P90.09
SOST. DIS.						

NP70-90

CUOCIPASTA A GAS
GAS-HEATED PASTA COOKERS
CUISEUR A PATES A GAZ
GASBEHEIZTE TEIGWARENKOCHER

NEW

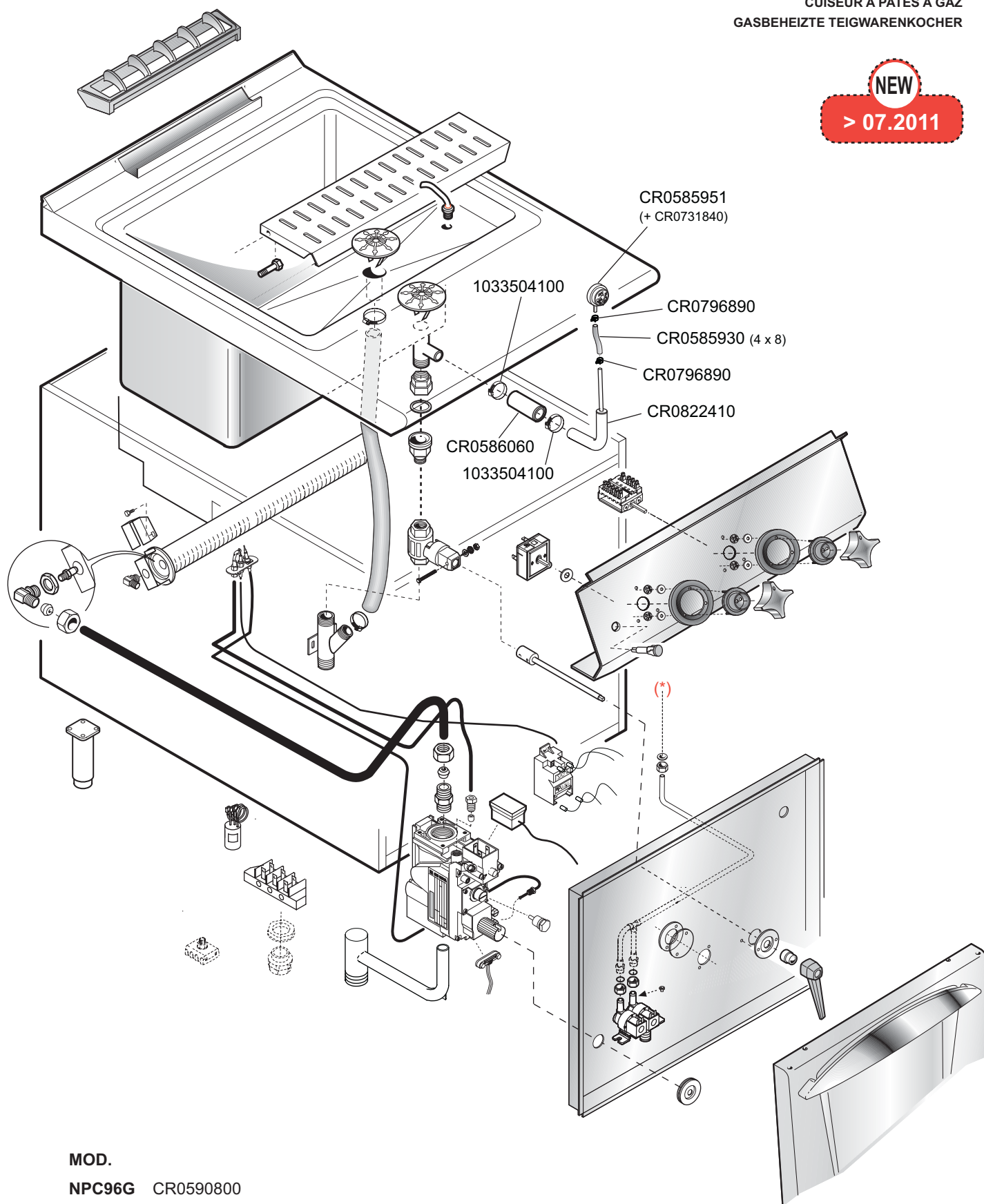

> 07.2011



MOD.

NPC96G CR0590800

ID GAS: ☐ G30/50 ☒ G30/29 ☐ G20/20 ☒ G25/25 ☒ G25/20 ☒ G120/8 ☒ G110/8

 MARENO INDUSTRIE ALI spa Mareno di Piave (TV)	ELABORATO:	APPROVATO:	GRUPPO:	DENOMINAZIONE:		
			Serie NP90 (60 cm)	Impianto gas e mobile		
	DATA:	DATA:	PARTICOLARE:	REV. N.	DEL	DISEGNO N.
	02 Ott 2010	02 Ott 2010	Disegno esploso per ricambi	Z02	1011	3.P90.43
	SOST. DIS.					

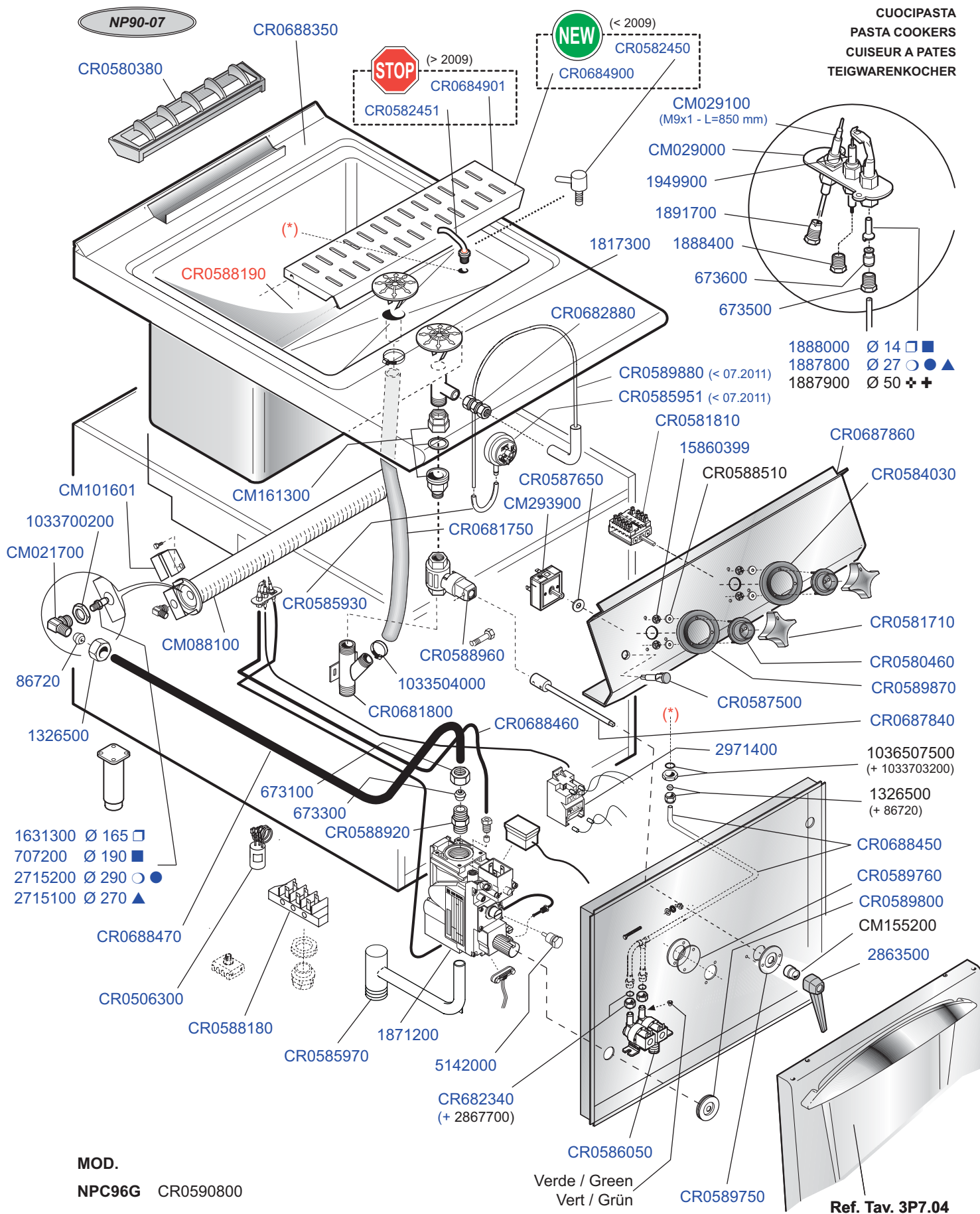

MOD.

NPC96G CR0590800

ID GAS: □ G30/50 ■ G30/29 ○ G20/20 ● G25/25 ▲ G25/20 ✚ G120/8 ✚ G110/8

 <p>MARENO INDUSTRIE ALI spa Mareno di Piave (TV)</p>	ELABORATO:	APPROVATO:	GRUPPO:	DENOMINAZIONE:		
			Serie NP70, 90	Impianto idraulico e mobile		
	DATA:	DATA:	PARTICOLARE:	REV. N.	DEL	DISEGNO N.
	01 Ago 2011	01 Ago 2011	Disegno esploso per ricambi	Z01	0711	3.P90.43 1/3

SOST. DIS.



Per collocare il pressostato (2) nella nuova posizione (A)

è necessario:

- applicare la nuova squadretta (1):
- collegare il tubicino (3) in silicone (L= 80 mm) e bloccare le due estremità con le fascette (2a);
- forare o tagliare opportunamente il pannello (B) per far passare il tubicino (3) nella zona sottostante
- applicare il tubo di espansione (4) con il manicotto (5) e le n. 2 fascette (6) allo scarico (C) del troppopieno
- ricollegare il cablaggio (D) allungando i cavi più corti

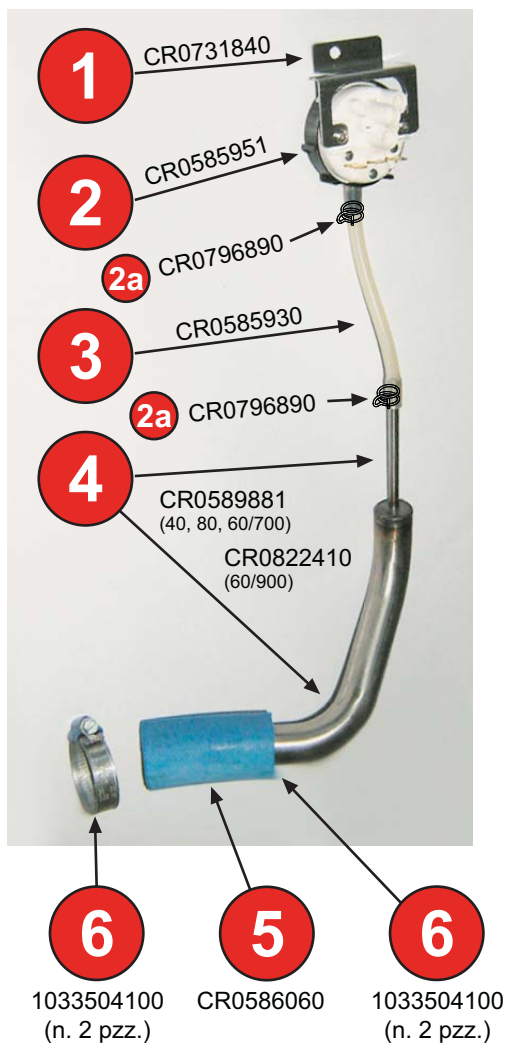

A

B



D

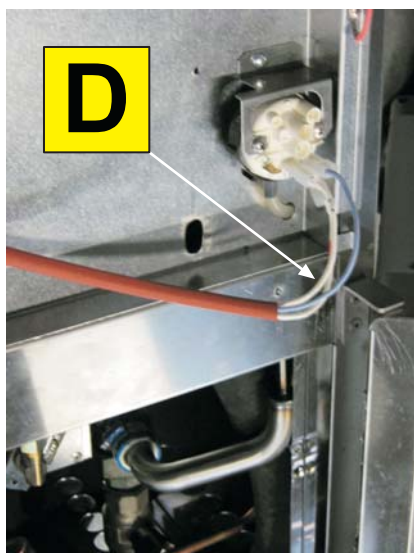

C



 MARENO INDUSTRIE ALI spa Mareno di Piave (TV)	ELABORATO:	APPROVATO:	GRUPPO:	DENOMINAZIONE:		
			Serie NP70, 90	Impianto idraulico e mobile		
	DATA:	DATA:	PARTICOLARE:	REV. N.	DEL	DISEGNO N.
	02 Ott 2011	02 Ott 2011	Disegno esploso per ricambi	▼	▼	▼
	SOST. DIS.			Z02	1011	3.P90.43 1/2

NP70-90

CUOCIPASTA
PASTA COOKERS
CUISEUR A PATES
TEIGWARENKOCHER
(> 07.2011)

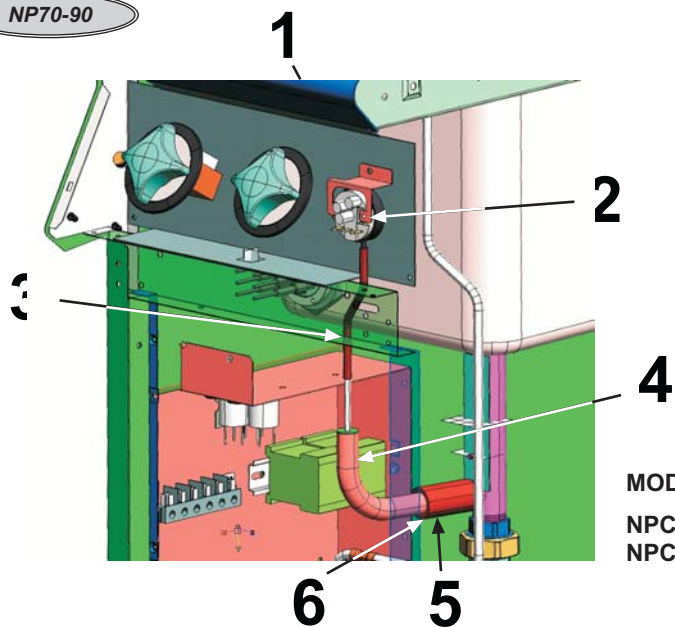

MOD.
NPC7 e NPC9 4G
NPC7 e NPC9 4E

B

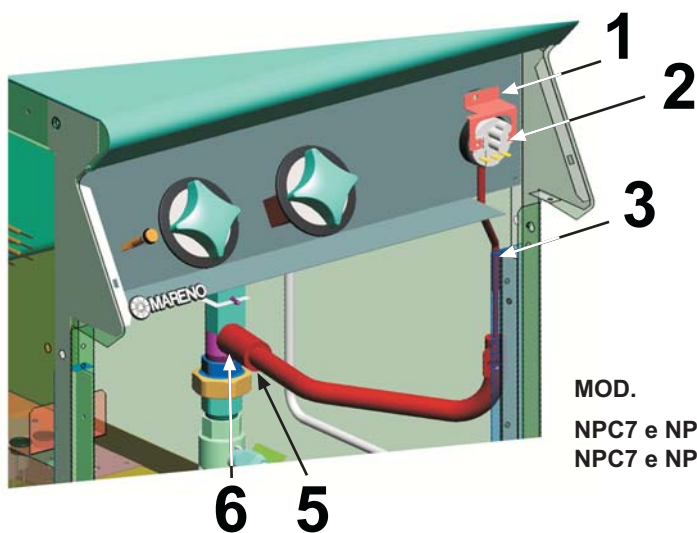
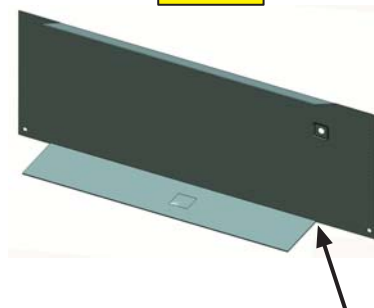

MOD.
NPC7 e NPC9 6G
NPC7 e NPC9 6E

B

CD0687854

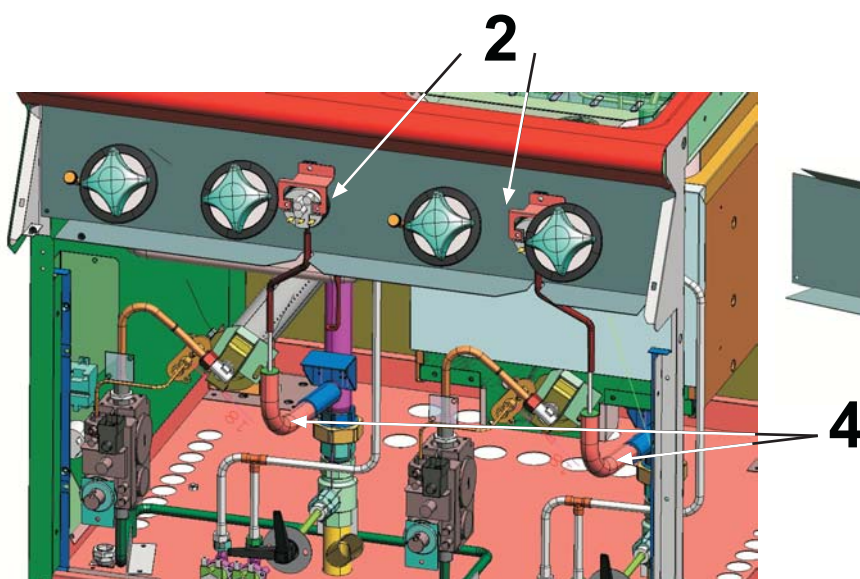

B

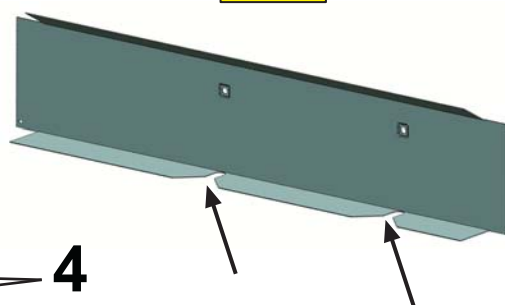

 MARENO INDUSTRIE ALI spa Mareno di Piave (TV)	ELABORATO:	APPROVATO:	GRUPPO:	DENOMINAZIONE:		
			Serie NP70, 90	Impianto idraulico e mobile		
	DATA:	DATA:	PARTICOLARE:	REV. N.	DEL	DISEGNO N.
	02 Ott 2011	02 Ott 2011	Disegno esploso per ricambi	▼ Z02	▼ 1011	▼ 3.P90.43 2/2
	SOST. DIS.					

CR0586050

ELETTROVALVOLA 2V 180° 230V RPE

CARATTERISTICHE TECNICHE

- CORPO VALVOLA : POLYAMMIDE FIBRA VETRO
- MEMBRANA : NBR
- NUCLEO : ACCIAIO INOX
- TEMPERATURA MAX D'ESERCIZIO: +60° C
- PRESSIONE D'ESERCIZIO : 0.2 - 10 BAR
- TEMPERATURA MAX FLUIDO : +75° C
- POSIZIONE DI LAVORO : QUALUNQUE
- TENSIONE NOMINALE : 230 VOLT 50/60Hz
- POTENZA NOMINALE : 8 VA
- ASSORBIMENTO NOMINALE : 36 mA

RIDUTTORE DI PORTATA DI COLORE
VERDE SULL' USCITA INDICATA

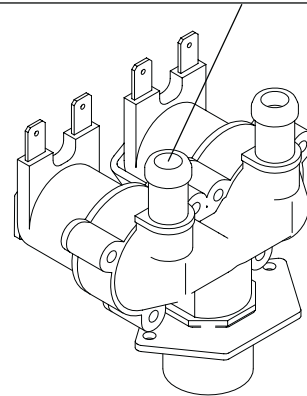

Outlet Flow Reduction / Riduttore di portata in uscita

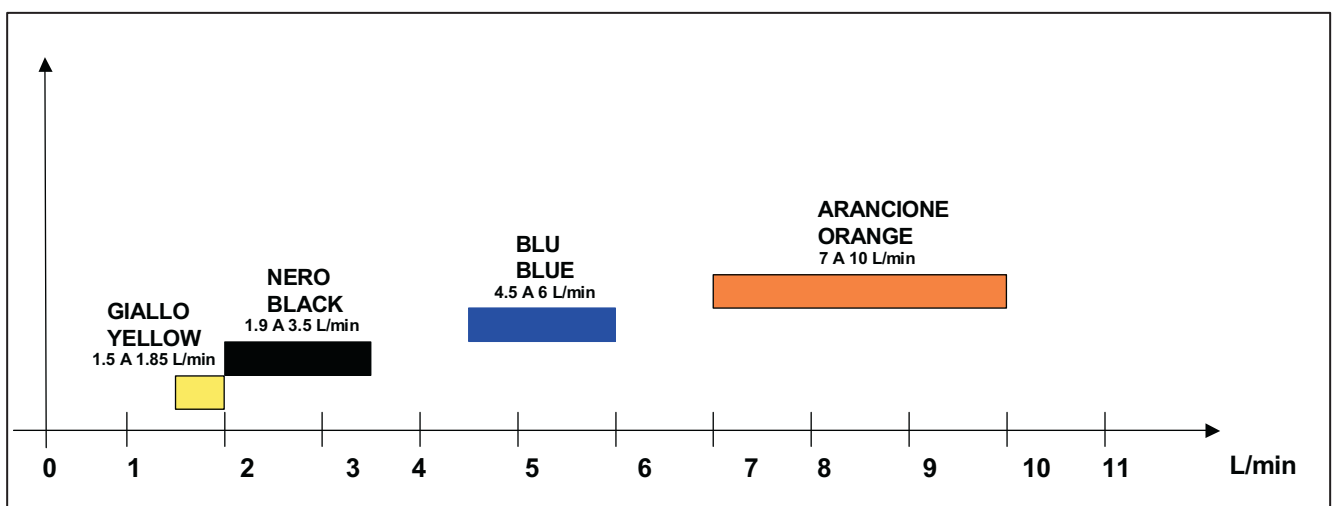
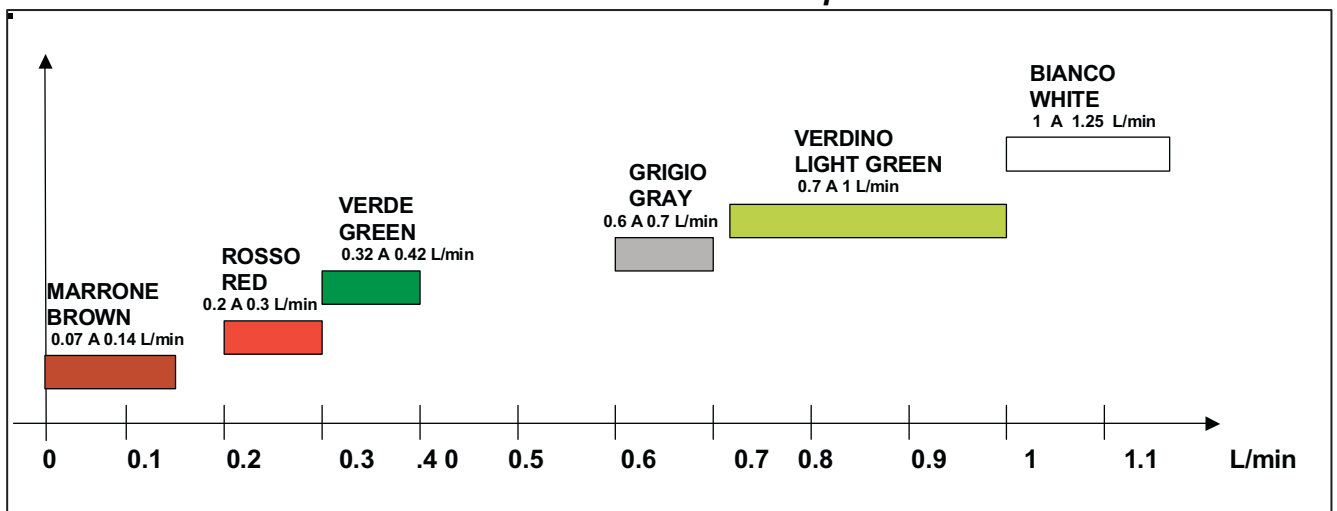

 MARENO INDUSTRIE ALI spa Mareno di Piave (TV)	ELABORATO:	APPROVATO:	GRUPPO:	DENOMINAZIONE:		
			Serie NP70, 90	Impianto idraulico e mobile		
	DATA:	DATA:	PARTICOLARE:	REV. N.	DEL	DISEGNO N.
	01 Ago 2011	01 Ago 2011	Disegno esploso per ricambi	▼ Z01	▼ 0711	▼ 3.P90.43

NP90-07

NPD96G5 CR0590850

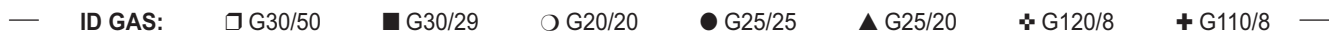

SOST. DIS.

3.P90.23

3.P90.23

NP90-07

CR0686160



PENTOLE DA LITRI 50 - RISCALDAMENTO INDIRETTO A GAS
 GAS HEATED (JACKETED) BOILING PANS
 MARMITES A GAZ CHAUFFE INDIRECTE
 DOPPELWANDIGE AUSF. - GASBEHEIZT KOCHKESSEL

Mod.

NPI96G5 CR0590890

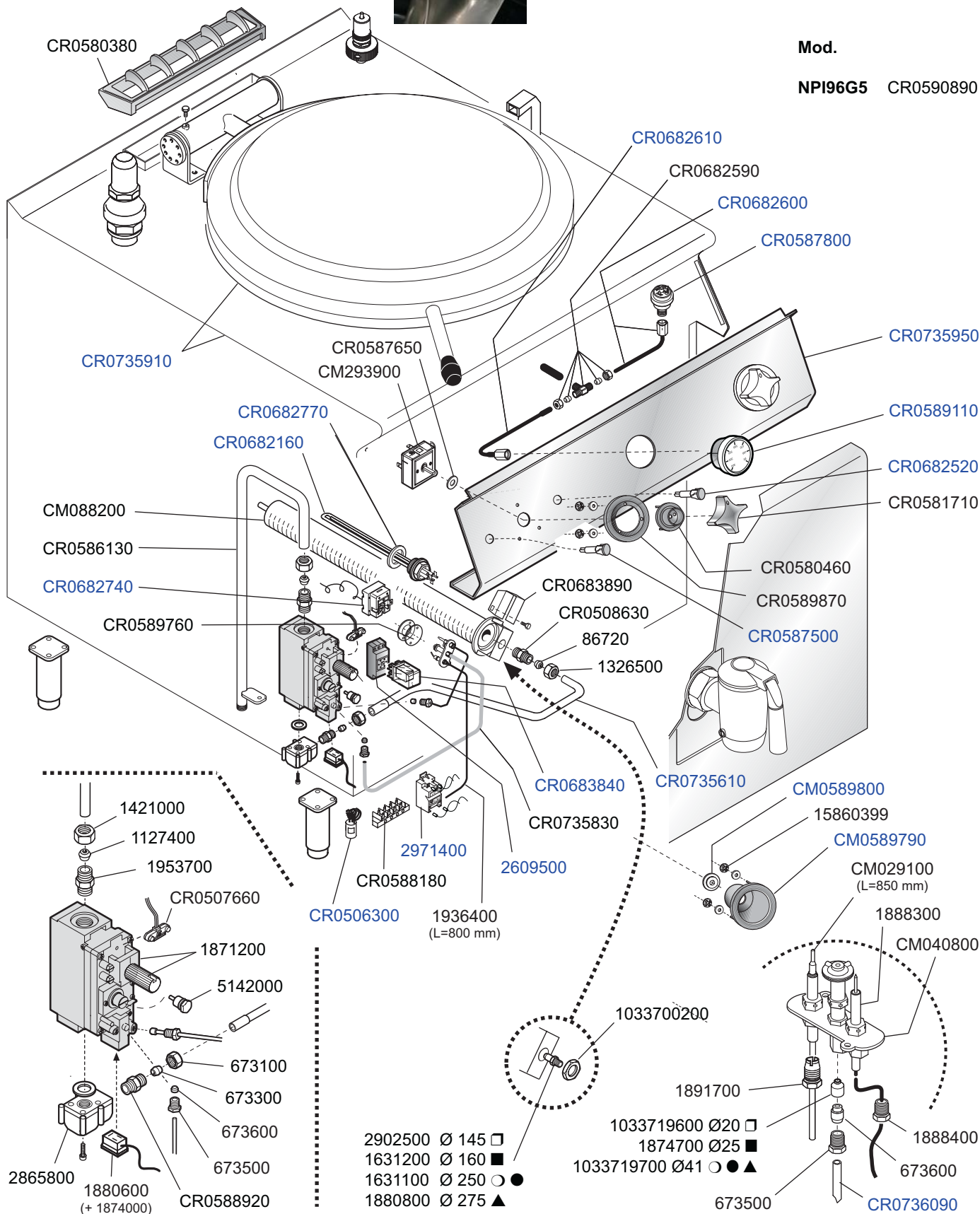

□ G30/50

■ G30/29

○ G20/20

● G25/25

△ G25/20

▲ G110/8

◎ G120/8

● G140/8

 MARENO INDUSTRIE ALI spa
 Mareno di Piave (TV)

ELABORATO:

LZ

APPROVATO:

GRUPPO:

Serie NP90

DENOMINAZIONE:

Impianto gas

DATA:

23 Mag 2010

DATA:

23 Mag 2010

PARTICOLARE:

Disegno esploso
per ricambi

REV. N.

Z00

DEL

0510

DISEGNO N.

3.P90.24

SOST. DIS.

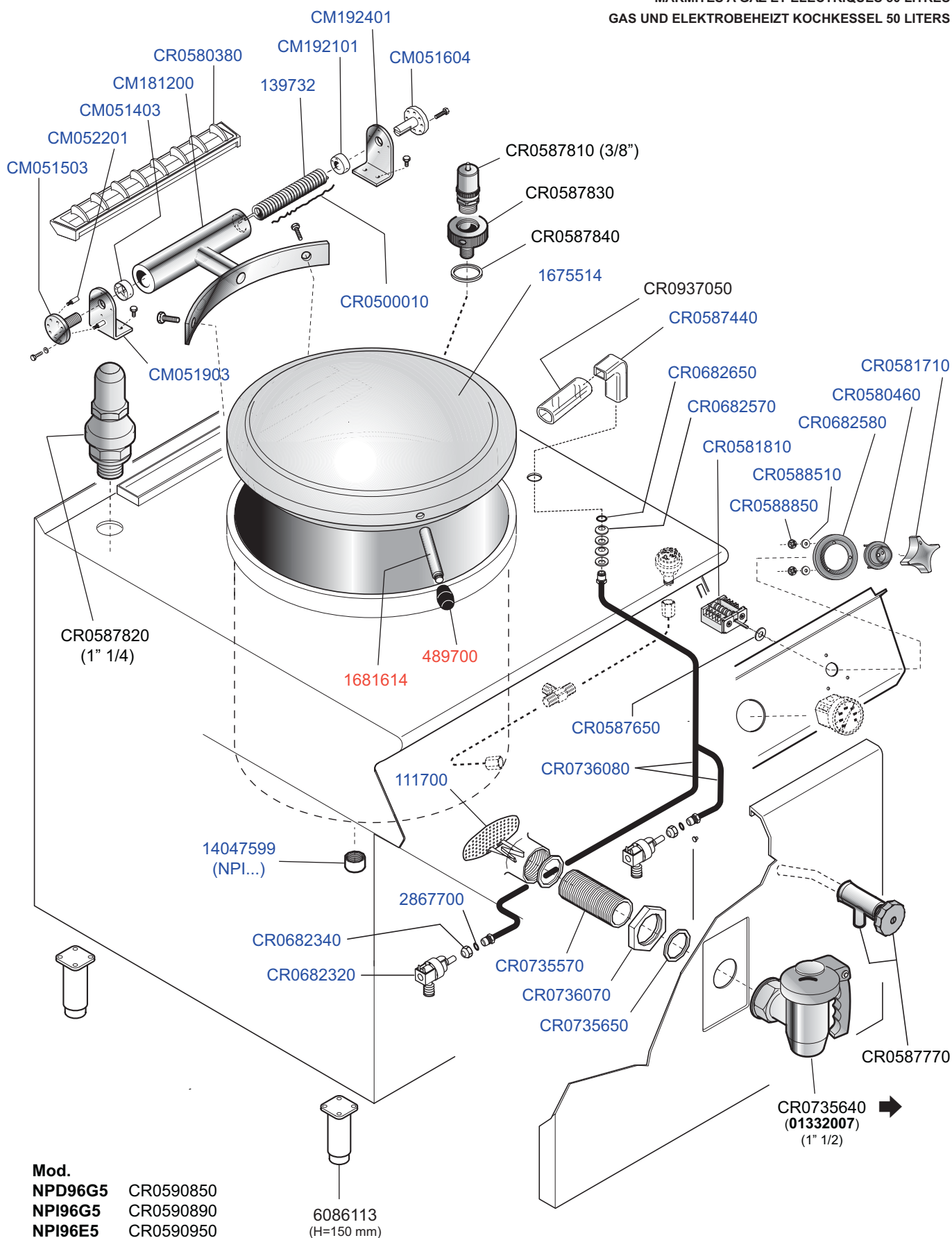

NP90-07

PENTOLE A GAS ED ELETTRICHE 50 LITRI
 GAS AND ELECTRIC HEATED BOILING PANS 50 LITERS
 MARMITES A GAZ ET ELECTRIQUES 50 LITRES
 GAS UND ELEKTROBEHEIZT KOCHKESSEL 50 LITERS



Mod.
NPD96G5 CR0590850
NPI96G5 CR0590890
NPI96E5 CR0590950

6086113
 (H=150 mm)

 MARENO INDUSTRIE ALI spa Mareno di Piave (TV)	ELABORATO:	APPROVATO:	GRUPPO:	DENOMINAZIONE:		
			Serie NP90	Impianto idraulico e mobile - Particolari comuni		
	DATA:	DATA:	PARTICOLARE:	REV. N.	DEL	DISEGNO N.
	21 Mag 2010	21 Mag 2010	Disegno esploso per ricambi	200	0510	3.P90.20
	SOST. DIS.					

1" 1/2 CON - 50 Lit.
Cod. CR0735640 (01332007)
 (Serie N-Protagonista 70 e 90 - 2008)

- 1 Corpo cod. 22901077
- 2 Cilindro cod. 22100959
- 3 Calotta cod. 22900804
- 4 Vite fissaggio cilindro cod. 51007375
- 5 Vite di fermo rotazione cod. 31007370
- 6 Impugnatura atermica cod. 34003011
- 7 Perno fissaggio impugnatura cod. 31004854
- 8 Anello tipo RA cod. 51000209
- 9 Dado cod. 22801231
- 10 Guarnizione cod. 34012778

A

Serial No.
 < MA020.....



Cod. 77122400
 Grasso/Grease
 art. 36206760
 KLUBER Non Trop
 PLB DR
 (Cod. art. 572411)
 tubo da 100 g)

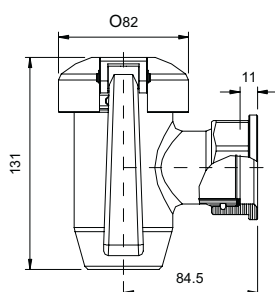

Dimens.
mm

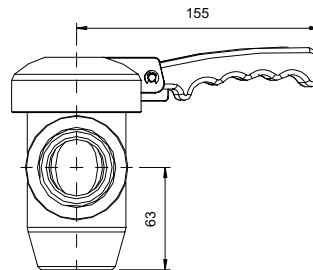

 MARENO INDUSTRIE ALI spa Mareno di Piave (TV)	ELABORATO:	APPROVATO:	GRUPPO:	DENOMINAZIONE:		
	LZ		Serie NP70 - 90	Rubinetti di scarico da 1" 1/2		
	DATA:	DATA:	PARTICOLARE:	REV. N.	DEL	DISEGNO N.
	16 Nov 2010	16 Nov 2010	Disegno esploso per ricambi	Z00	1110	3.P90.20/2
	SOST. DIS.					

NP90-07

PENTOLE DA LITRI 100 E 150 - RISCALDAMENTO DIRETTO A GAS

GAS DIRECT HEATED BOILING PANS

MARMITES A GAZ CHAUFFE DIRECTE

DIREKTBEHEIZT GAS KOCHKESSEL

Mod.



NPD98G10 CR0590860

NPD98G15 CR0590870

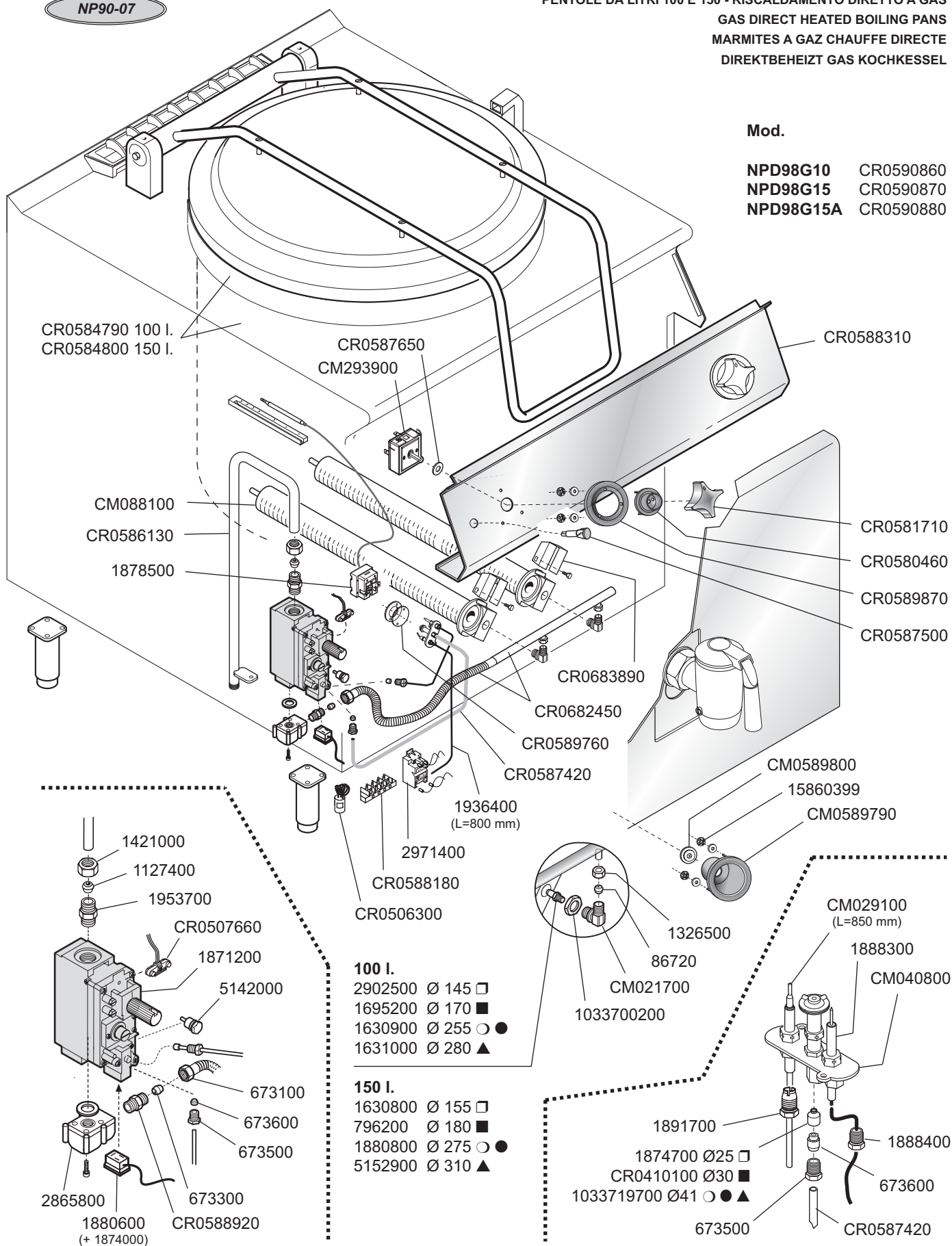
NPD98G15A CR0590880





ID GAS: □ G30/50 ■ G30/29 ○ G20/20 ● G25/25 ▲ G25/20 ✕ G120/8 + G110/8

 MARENO INDUSTRIE ALI spa Mareno di Piave (TV)	ELABORATO:	APPROVATO:	GRUPPO:	DENOMINAZIONE:		
			Serie NP90	Impianto gas		
	DATA:	DATA:	PARTICOLARE:	REV. N.	DEL	DISEGNO N.
	25 Feb 2008	25 Feb 2008	Disegno esploso per ricambi	▼ Z00	▼ 0309	▼ 3.P90.13
SOST. DIS.			CE			

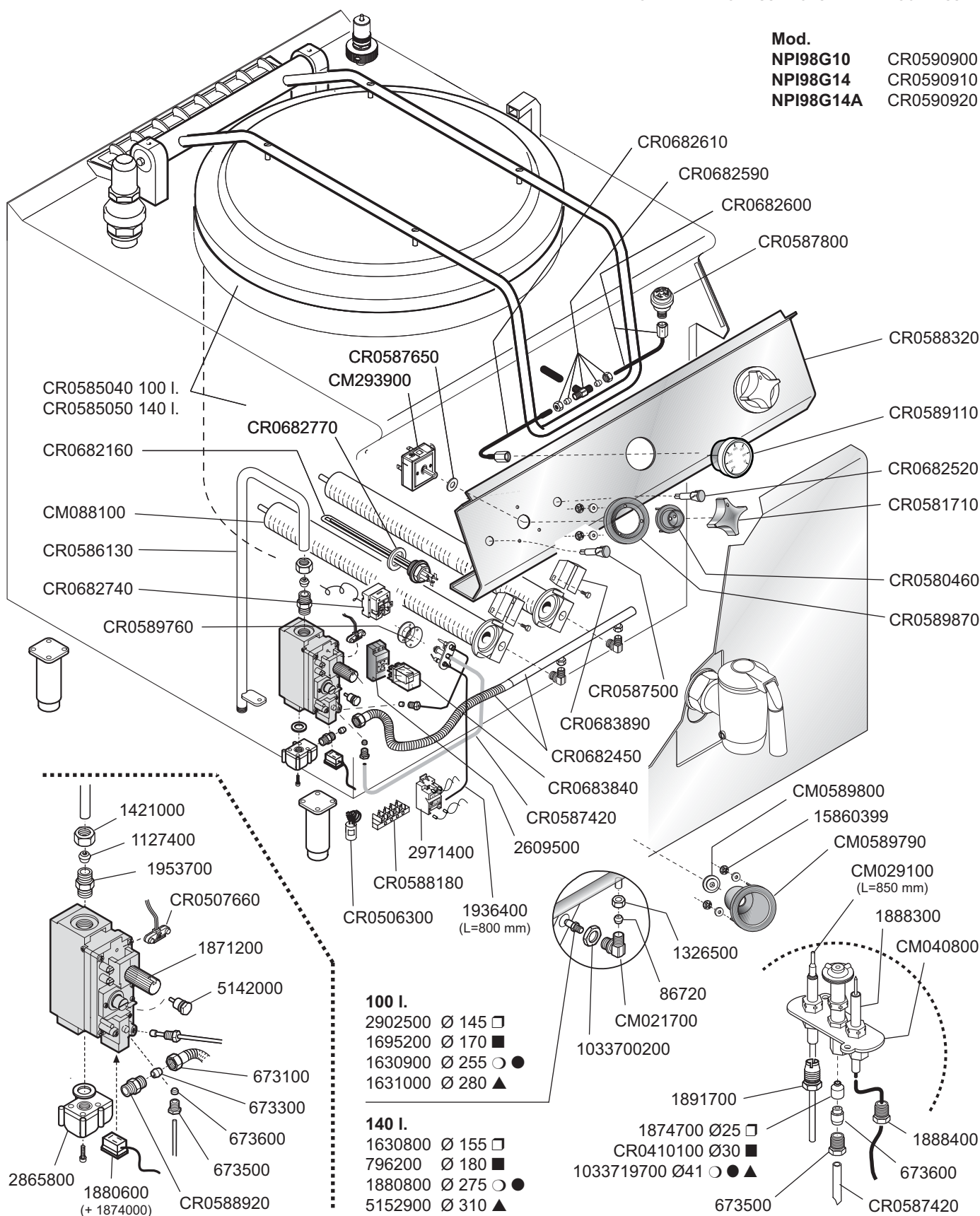
Mod.
NPI98G10 CR0590900
NPI98G14 CR0590910
NPI98G14A CR0590920





□ G30/50 ■ G30/29 ○ G20/20 ● G25/25 △ G25/20 ▲ G110/8 ◎ G120/8 ● G140/8

 MARENO INDUSTRIE ALI spa Mareno di Piave (TV)	ELABORATO:	APPROVATO:	GRUPPO:	DENOMINAZIONE:		
			Serie NP90	Impianto gas		
	DATA:	DATA:	PARTICOLARE:	REV. N.	DEL	DISEGNO N.
	25 Feb 2008	25 Feb 2008	Disegno esploso per ricambi	▼ Z00	▼ 0309	▼ 3.P90.26
	SOST. DIS.					

NP90-07

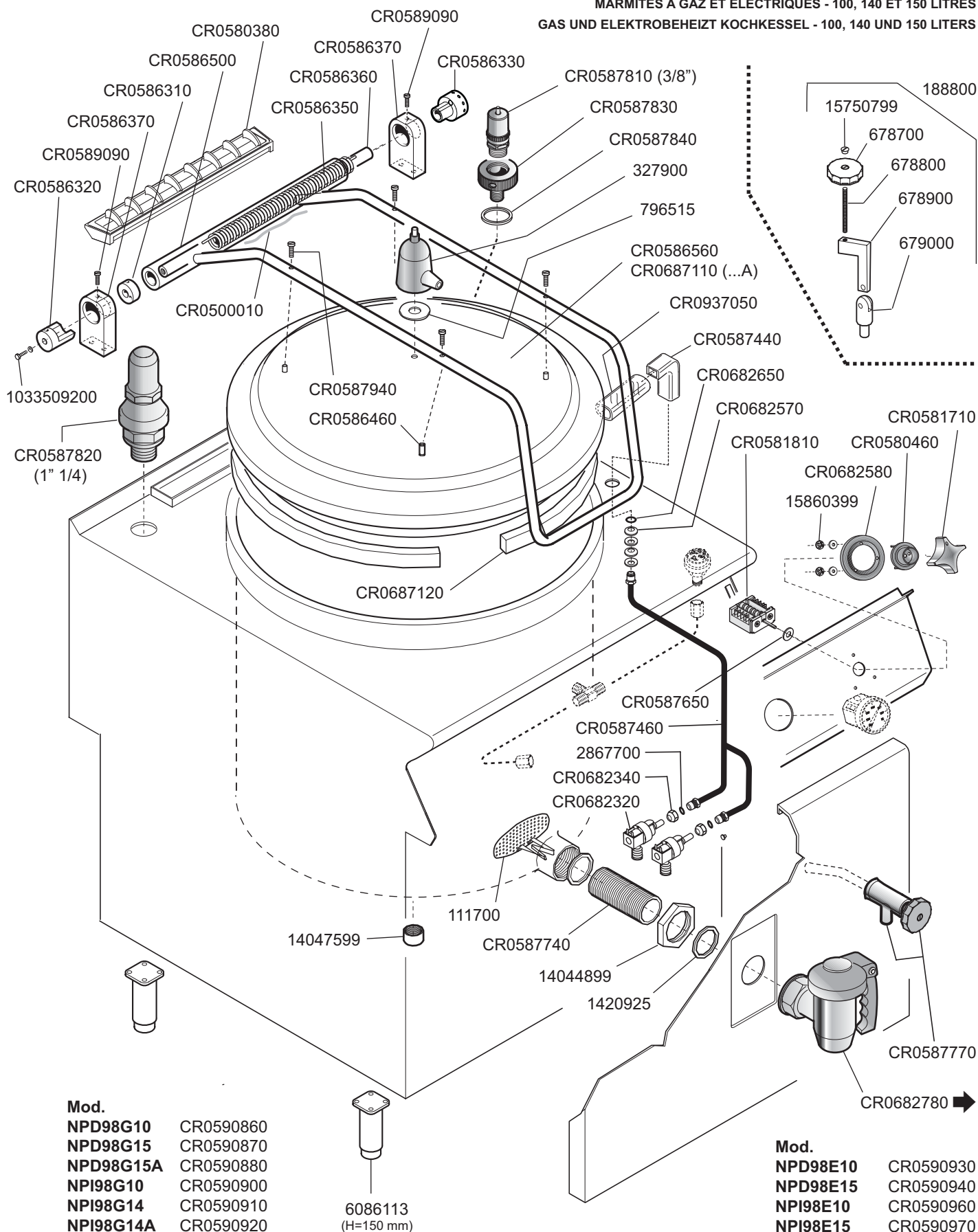
PENTOLE - 100, 140 E 150 LITRI
 GAS AND ELECTRIC HEATED BOILING PANS - 100, 140 AND 150 LITERS
 MARMITES A GAZ ET ELECTRIQUES - 100, 140 ET 150 LITRES
 GAS UND ELEKTROBEHEIZT KOCHKESSEL - 100, 140 UND 150 LITERS



 MARENO INDUSTRIE ALI spa Mareno di Piave (TV)	ELABORATO:	APPROVATO:	GRUPPO:	DENOMINAZIONE:		
			Serie NP90	Impianto idraulico e mobile - Particolari comuni		
	DATA:	DATA:	PARTICOLARE:	REV. N.	DEL	DISEGNO N.
	25 Feb 2008	25 Feb 2008	Disegno esploso per ricambi	Z00	0708	3.P90.14

2" CON - 100, 140, 150 Lit.

Cod. CM128900 (01301019)

(Serie Protagonista 90 - 1999/2008)

Serial No. < MA020167179

A



Cod. 77122400 - Grasso/Grease 36206760
 (KLUBER Non Trop PLB DR (Cod. art. 572411) tubo da 100g)

2" OR - 100, 140, 150 Lit.

Cod. CM128900 (01301109)

(Serie Protagonista 90 - 2009)

Serial No. < MA020167179

B



Cod. 77122300 - Grasso/Grease 36206780
 (LOXEAL 4 siliconico al PTFE (Cod. art. 804004) tubo da 100g)

2" OR - 100, 140, 150 Lit.

Cod. CR0682780 (01321009)

(Serie N-Protagonista 90 - 2008)

Serial No. < MA020167179

C



Cod. 77122300 - Grasso/Grease 36206780
 (LOXEAL 4 siliconico al PTFE (Cod. art. 804004) tubo da 100g)

2" CON - 100, 140, 150 Lit.

Cod. CR0682780 (01322009)

(Serie N-Protagonista 90 - 2009)

Serial No. > MA020167013

D



Cod. 77122400 - Grasso/Grease 36206760
 (KLUBER Non Trop PLB DR (Cod. art. 572411) tubo da 100g)



MARENO INDUSTRIE ALI spa
 Mareno di Piave (TV)

ELABORATO:

LAZ

DATA:

15 Ott 2009

APPROVATO:

DATA:

15 Ott 2009

SOST. DIS.

GRUPPO:

N-Cottura NP90 - 2008

PARTICOLARE:

Disegno esploso
 per ricambi



DENOMINAZIONE:

Rubinetto di scarico da 2"

REV. N.

Z00

DEL

0110

DISEGNO N.

3.P90.14/2

NB94G (A - CR0583910 cm 4,5x70)
NB98G (A - CR0583910 cm 4,5x70) +
(B - CM142500 cm 7,5x70)

CR0583890 NB94G
CR0583900 NB98G

MOD. 40

1900900 Ø 75 □
1927400 Ø 85 ■
1421700 Ø 130 ○ ●
2715300 Ø 150 ▲
1631100 Ø 250 ✚ ✚

MOD. 80

5159700 Ø 110 □
1513000 Ø 125 ■
707200 Ø 190 ○ ●
707300 Ø 210 ▲
796500 Ø 420 ✚ ✚

CR0580640 NB94G
CR0580380 NB98G

CM142100
CM142000

CR0584150 (40)
CR0584170 (80)

CM021700

1326500

86720

CR0585010 (40)
CR0585020 (80)

1033700200

CR0585510
CR0585500

CM141300

CR0585540

CM140600 (40)
CM140700 (80)

CR0582500

MOD. 40

CM147600 Ø 0,50 □ ■
CM147700 Ø 0,75 ○ ● ▲ ✚ ✚

MOD. 80

CM147700 Ø 0,75 □ ■
1884100 Ø 1,05 ○ ● ▲ ✚ ✚

673600

673500

1326500
86720

86720

1326500

CM140500 (0,75)

Mod.

NB94G CR0590360
NB98G CR0590370

CR0588850

CR0580460

CR0584010

CR0582470 (40)
CR0582480 (80)

1891700

1888400

CR0584990 (40)
CR0585000 (80)

CM029100
(M9x1 L=850 mm)

1949900



CM029000

673600

673500

1888000 Ø 14 □ ■
1887800 Ø 27 ○ ● ▲
1887900 Ø 50 ✚ ✚



ID GAS: □ G30/50 ◆ G30+31/37 ■ G30/28+37 ○ G20/20 ★ **G20/25** ● G25/25 ☆ **G25.1/25** ▲ G25/20

 MARENO INDUSTRIE ALI spa Mareno di Piave (TV)	ELABORATO:	APPROVATO:	GRUPPO:	DENOMINAZIONE:		
			Serie NP90	Impianto gas e mobile		
	DATA:	DATA:	PARTICOLARE:	REV. N.	DEL	DISEGNO N.
	24 Lug 2007	24 Lug 2007	Disegno esploso per ricambi	Z00	0707	3.P90.19

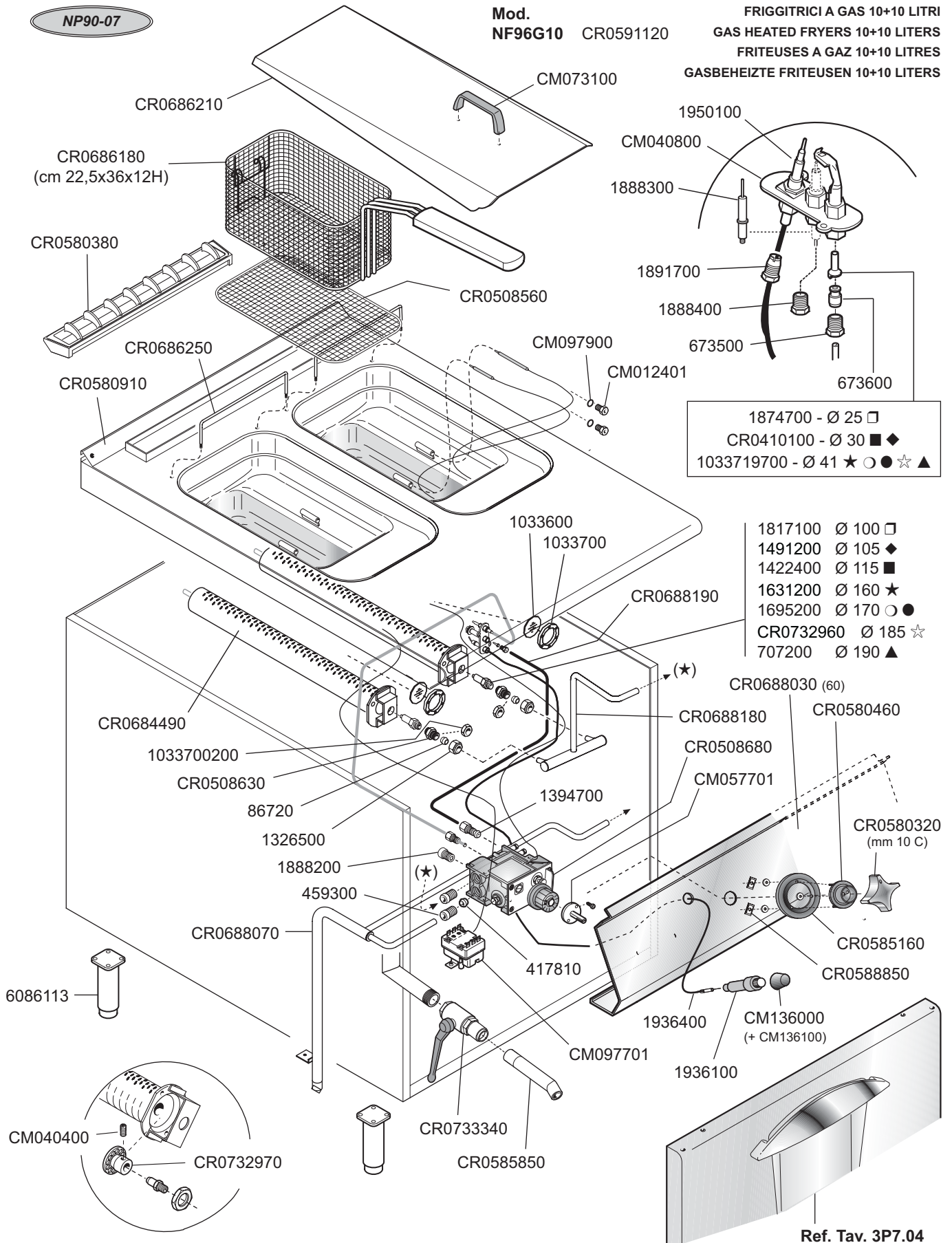
NP90-07

Mod.
NF96G10 CR0591120FRIGGITRICI A GAS 10+10 LITRI
GAS HEATED FRYERS 10+10 LITERS
FRITEUSES A GAZ 10+10 LITRES
GASBEHEIZTE FRITEUSEN 10+10 LITERS

ID GAS: □ G30/50 ■ G30/29 ○ G20/20 ● G25/25 ▲ G25/20 + G20/25 + G25.1/25

 MARENO INDUSTRIE ALI spa Mareno di Piave (TV)	ELABORATO:	APPROVATO:	GRUPPO:	DENOMINAZIONE:		
			Serie NP70 - 90 (*) da definire	Impianto gas e mobile		
	DATA:	DATA:	PARTICOLARE:	REV. N.	DEL	DISEGNO N.
	27 Feb 2009	27 Feb 2009	Disegno esploso per ricambi	▼ Z00	▼ 0209	▼ 3.P7.52
SOST. DIS.						

Protagonista



MOD.

NF9-4G15 CR0591130
NF9-8G15 CR0591140

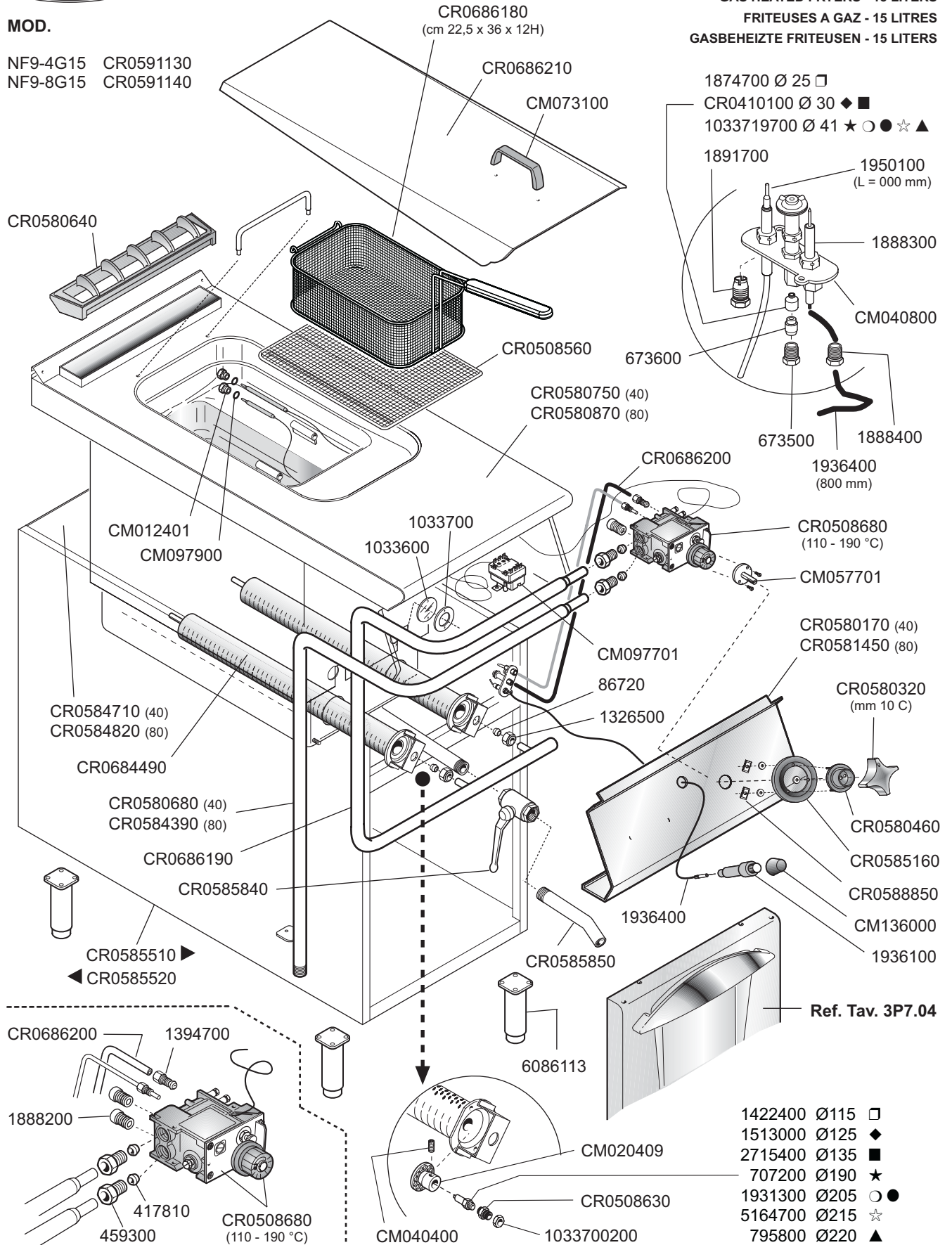
FRIGGITRICI A GAS - 15 LITRI
GAS HEATED FRYERS - 15 LITERS
FRITEUSES A GAZ - 15 LITRES
GASBEHEIZTE FRITEUSEN - 15 LITERS



ID GAS: □ G30/50 ◆ G30+31/37 ■ G30/28+37 ○ G20/20 ★ G20/25 ● G25/25 ☆ G25.1/25 ▲ G25/20

 MARENO INDUSTRIE ALI spa Mareno di Piave (TV)	ELABORATO:	APPROVATO:	GRUPPO:	DENOMINAZIONE:		
			Serie 90	Impianto gas e mobile		
	DATA:	DATA:	PARTICOLARE:	REV. N.	DEL	DISEGNO N.
	19 Nov 2008	19 Nov 2008	Disegno esploso per ricambi	▼ Z00	▼ 1108	▼ 3.P7.67
SOST. DIS.						



NP90-07

MOD.
NF94G23 CR0591150
NF98G23 CR0591170

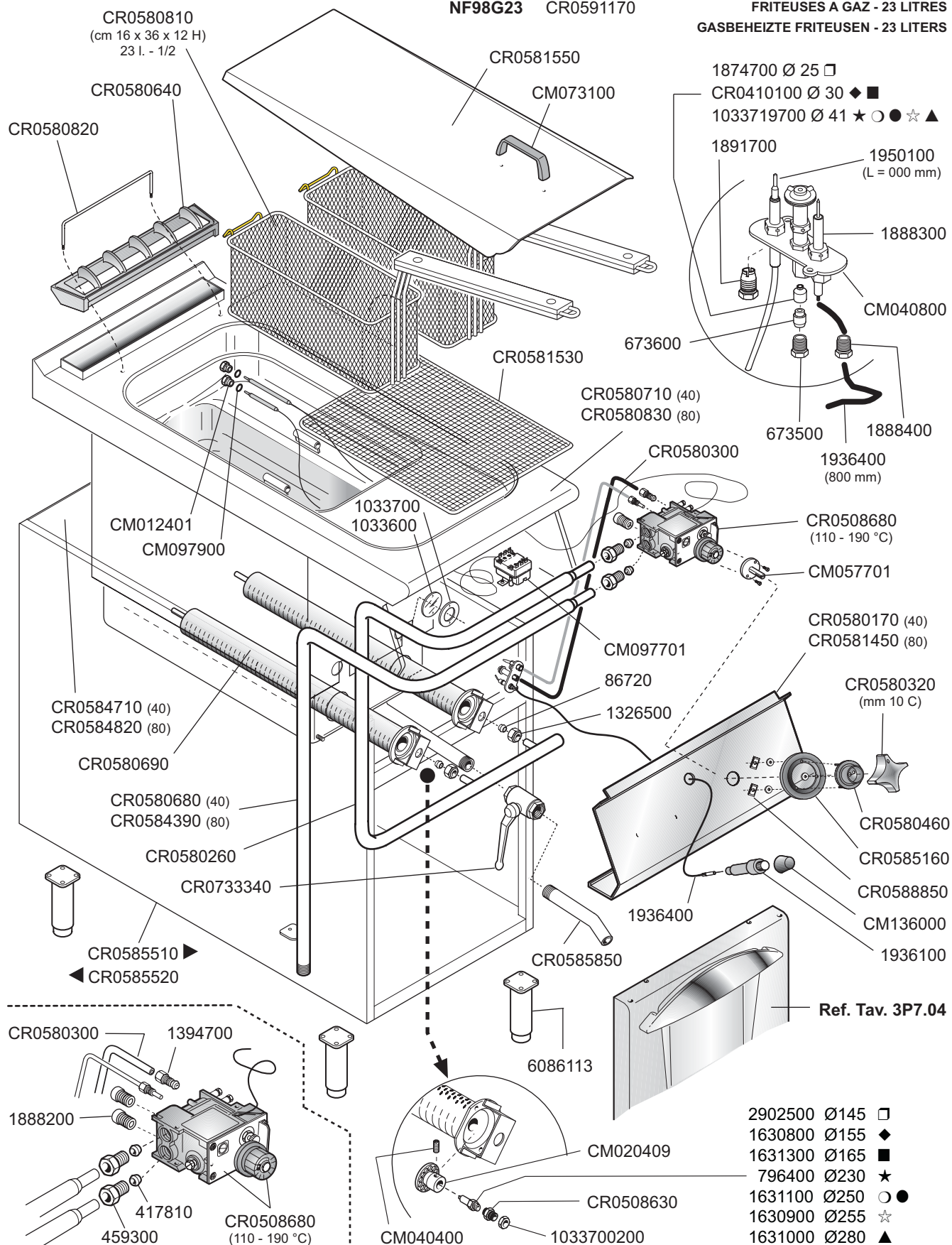
FRIGGITRICI A GAS - 23 LITRI
 GAS HEATED FRYERS - 23 LITERS
 FRITEUSES A GAZ - 23 LITRES
 GASBEHEIZTE FRITEUSEN - 23 LITERS



ID GAS: □ G30/50 ◆ G30+31/37 ■ G30/28+37 ○ G20/20 ★ G20/25 ● G25/25 ☆ G25.1/25 ▲ G25/20

 MARENO INDUSTRIE ALI spa Mareno di Piave (TV)	ELABORATO:	APPROVATO:	GRUPPO:	DENOMINAZIONE:		
			Serie NP90	Impianto gas e mobile		
	DATA:	DATA:	PARTICOLARE:	REV. N.	DEL	DISEGNO N.
	05 Lug 2007	05 Lug 2007	Disegno esploso per ricambi	▼ Z00	▼ 0710	▼ 3.P90.61
SOST. DIS.						